

88170902E

Magnum

Magnum Esstisch mit Einlegeplatte

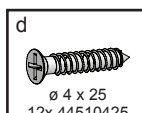
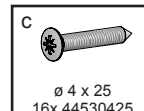
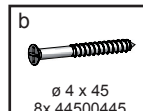
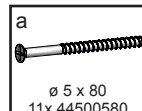
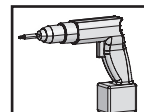
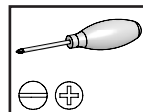
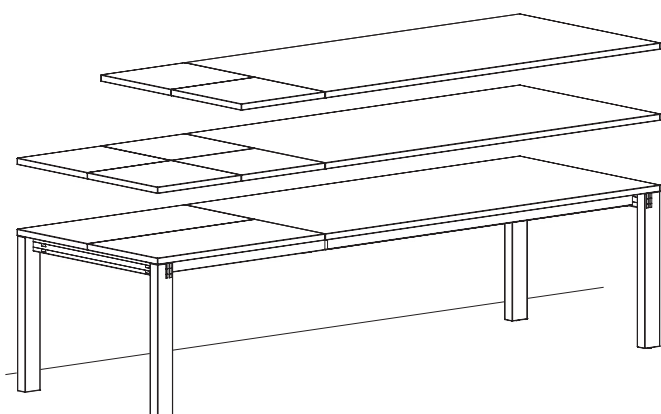

Bei Tisch mit Holz-
platte verwenden.

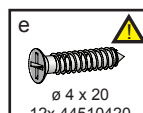

Bei Tisch mit Glas-
platte verwenden.

1

Hinweis

- Unterlage verwenden!

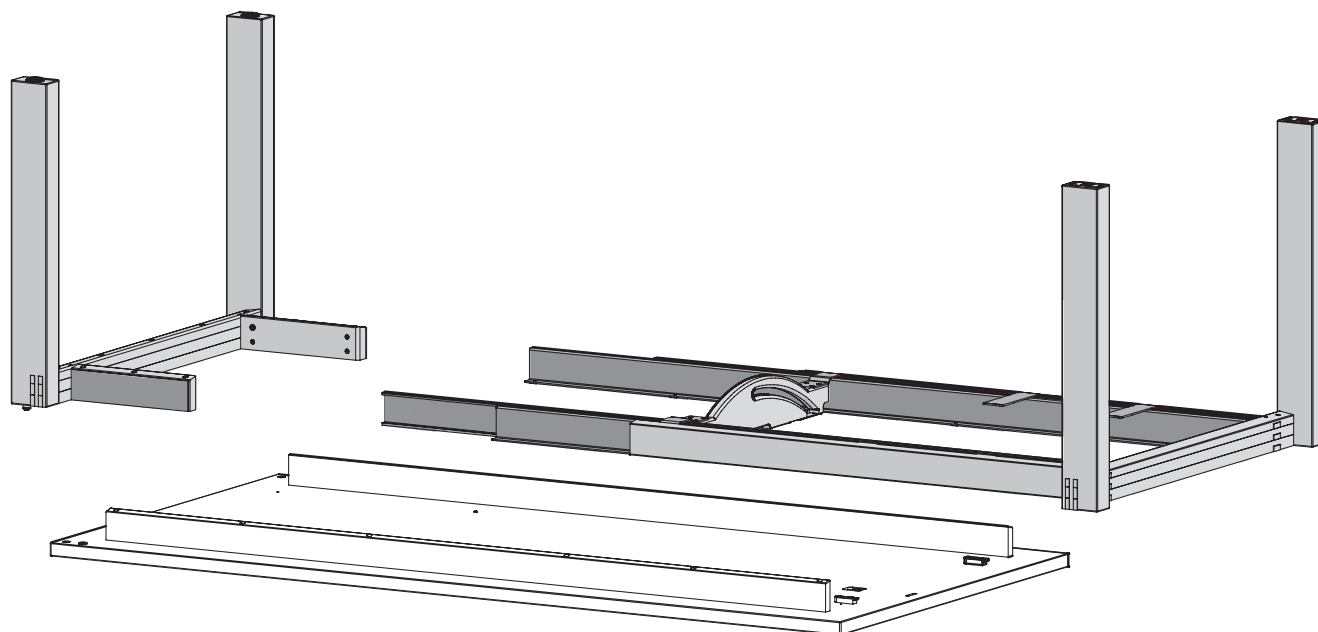

2

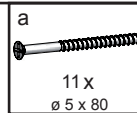
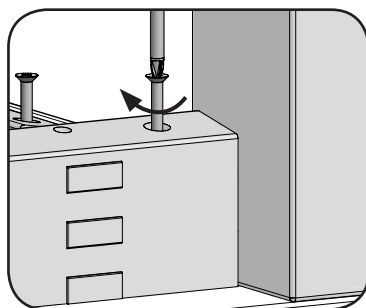
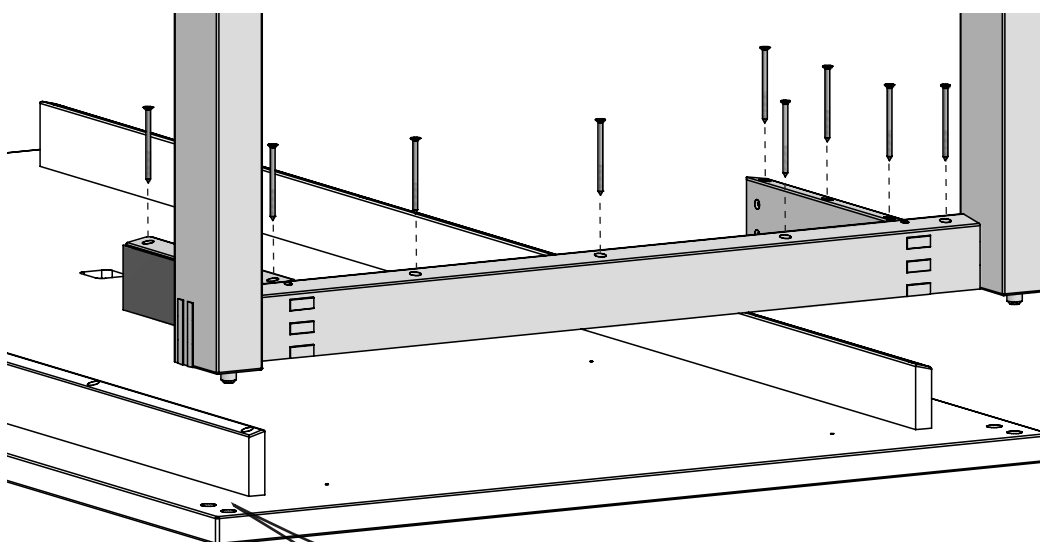

3

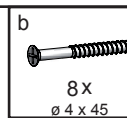
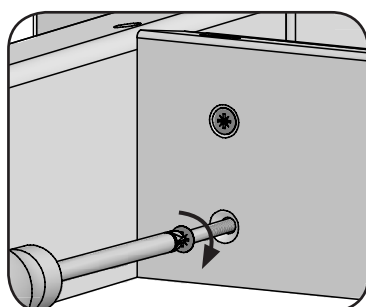
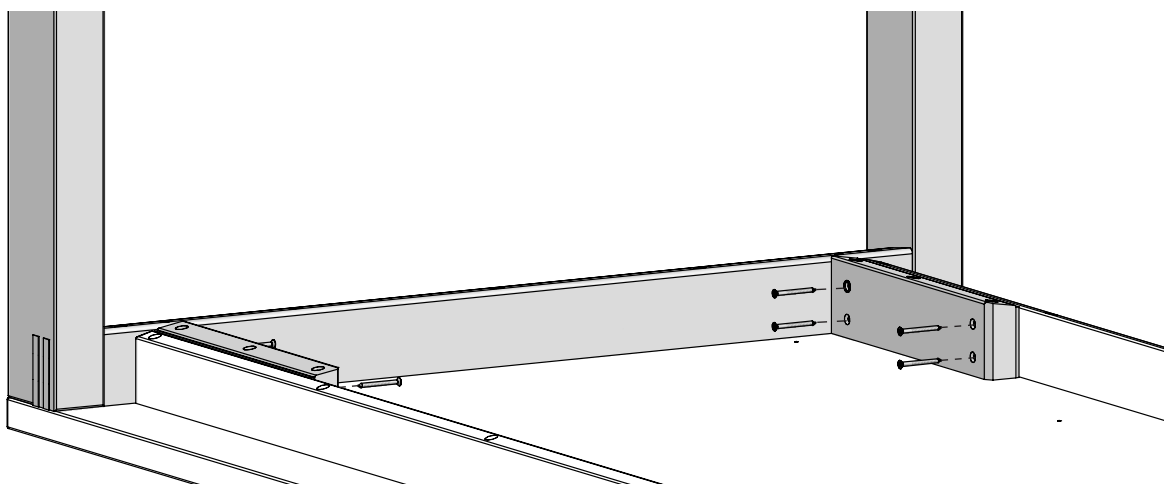

4

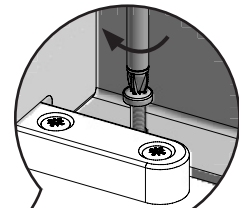
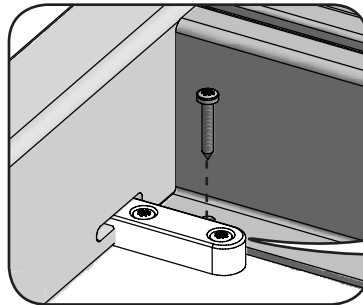
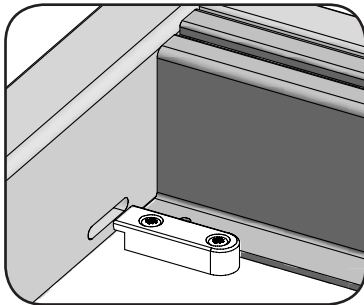
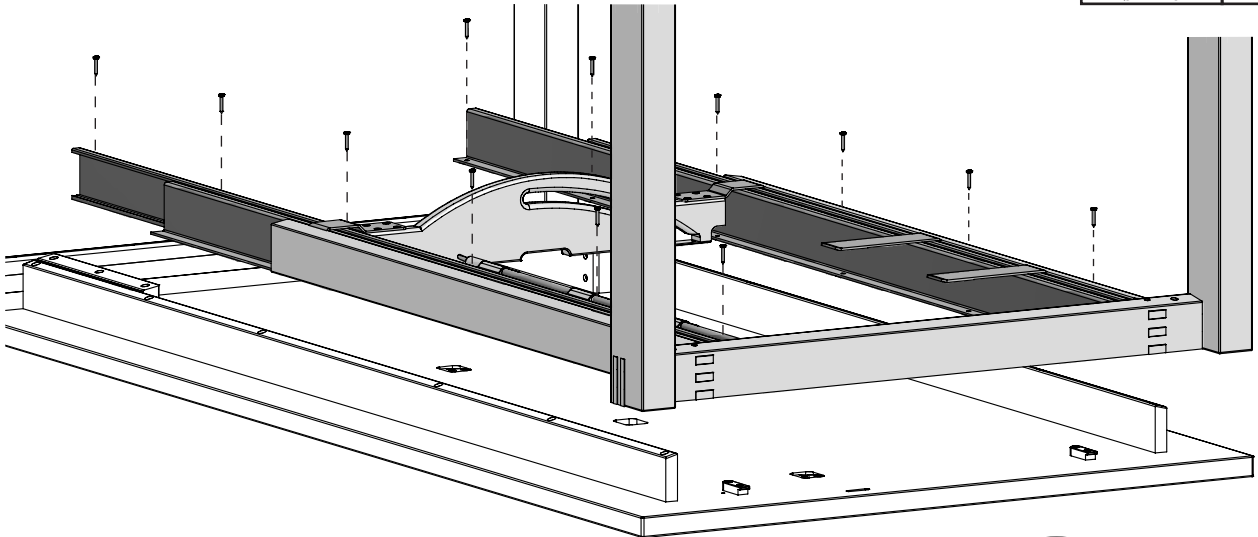
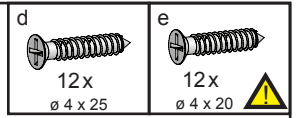

5 Schritt 5 - 11: Montage der Einlegeplatten

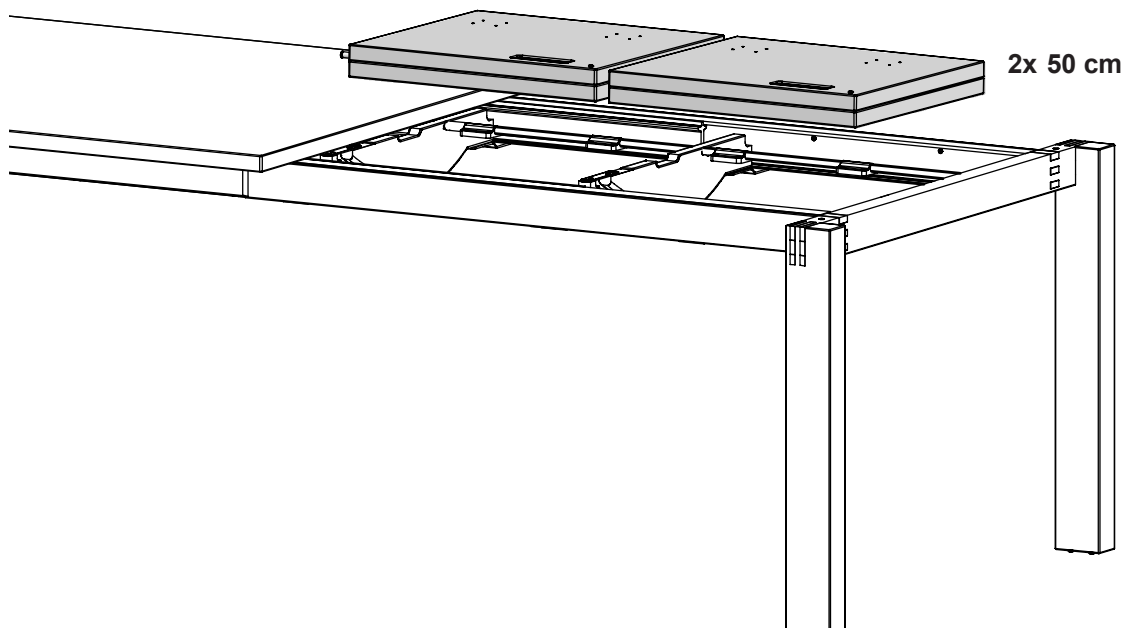
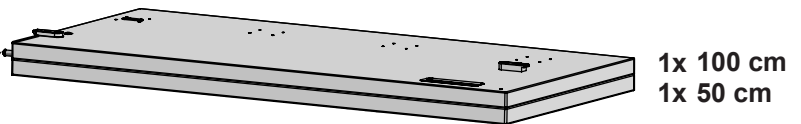
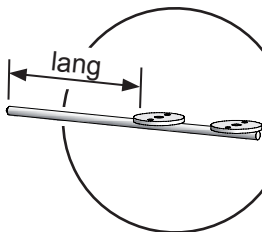

6

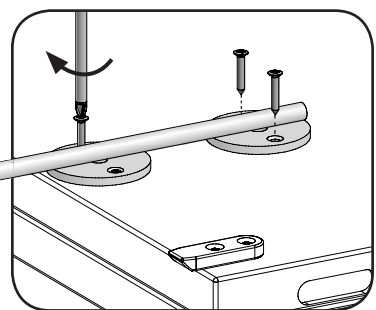
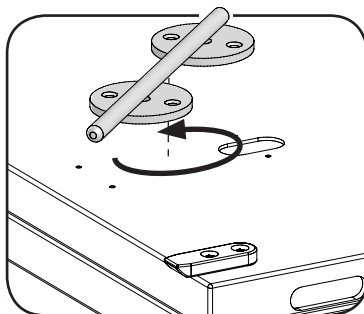
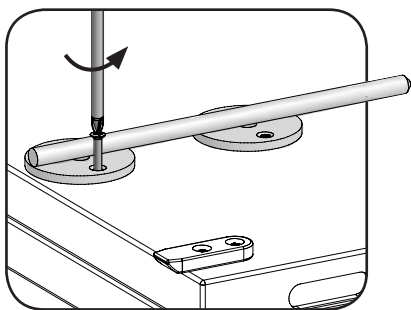
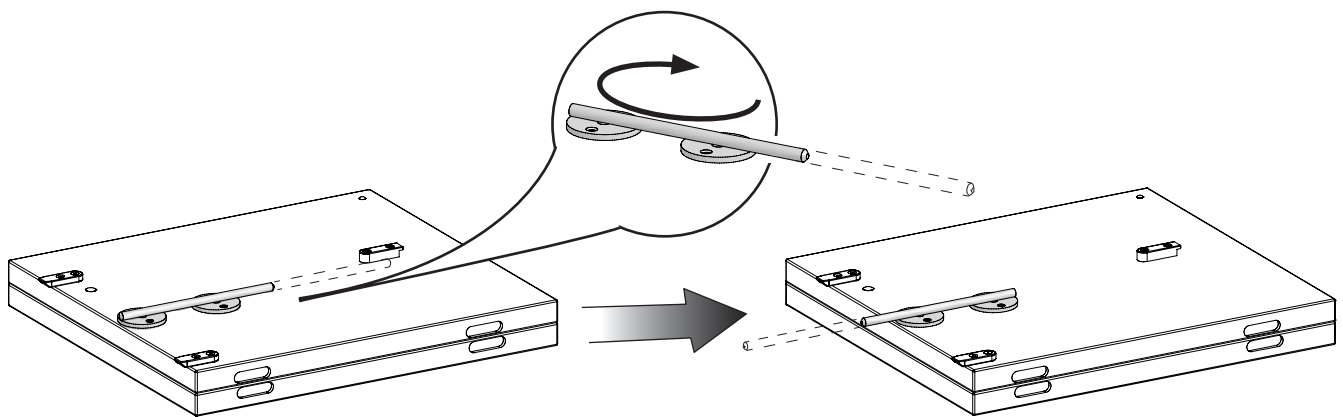

7

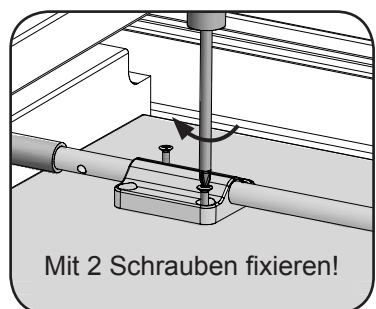
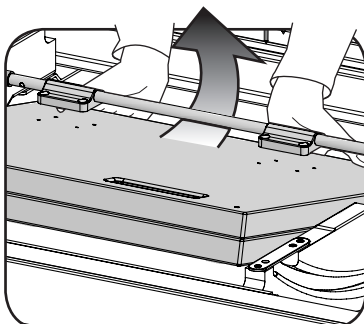
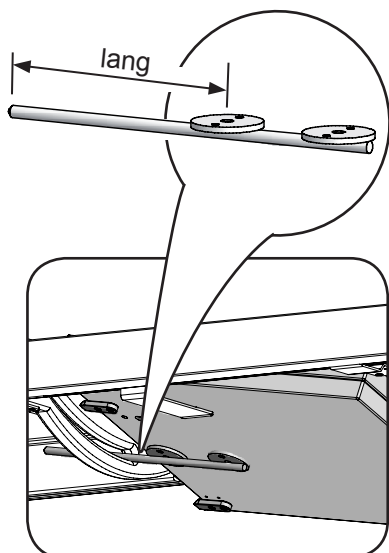
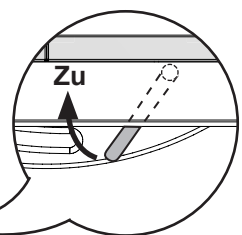
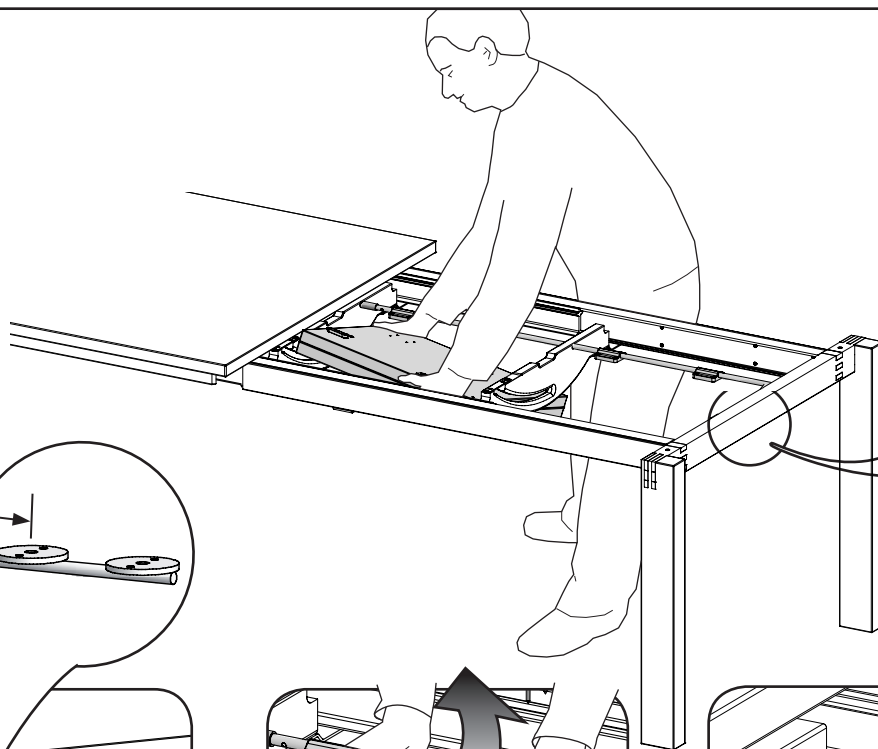
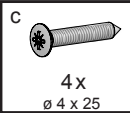

Mit 2 Schrauben fixieren!

8

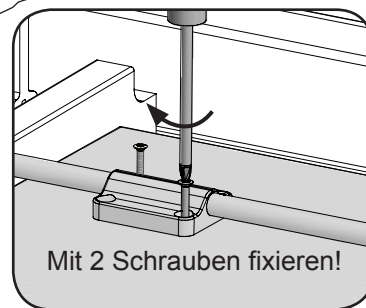
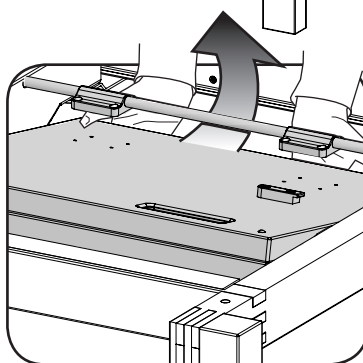
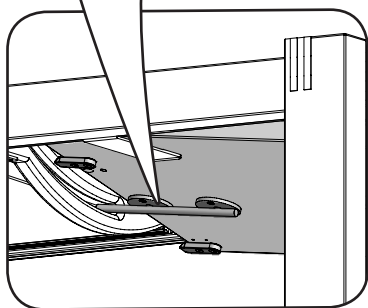
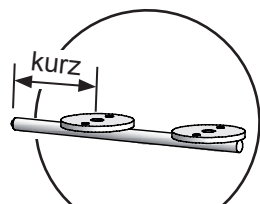
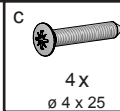

9

⚠ VORSICHT

- Glasbruchgefahr!
- Vorsicht beim Zuklappen

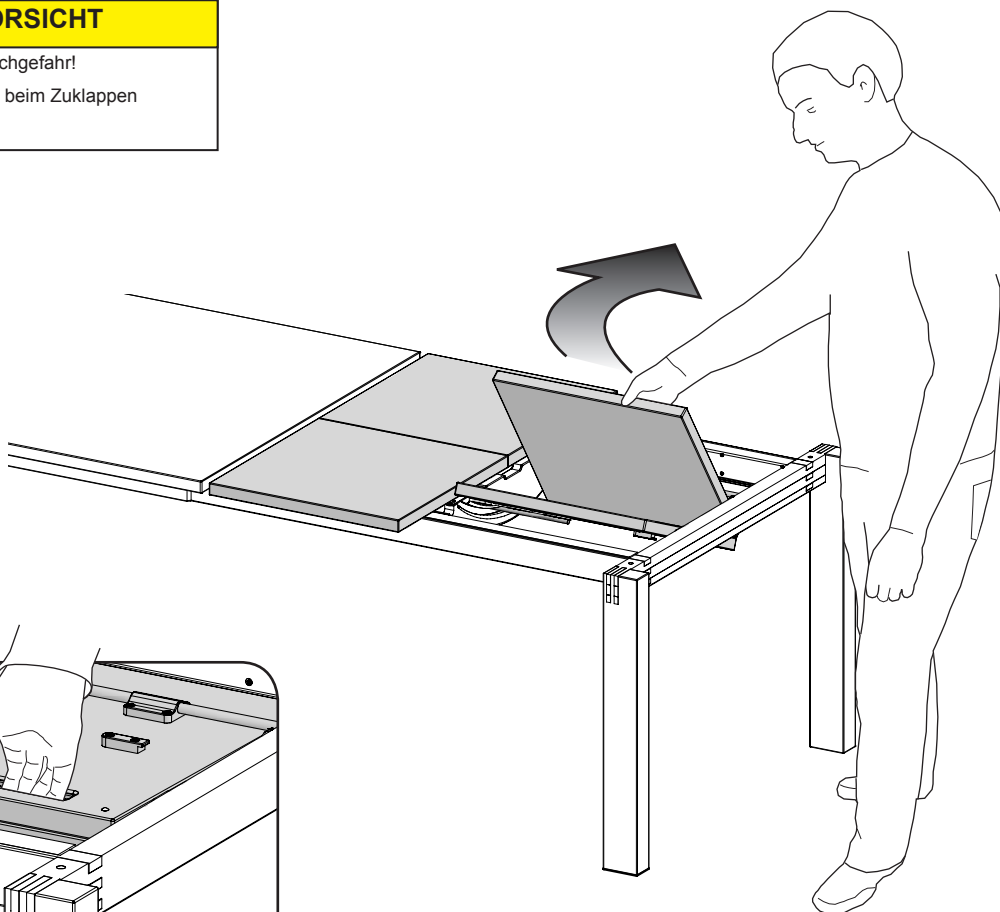
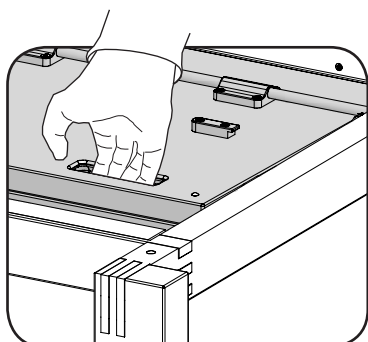

10

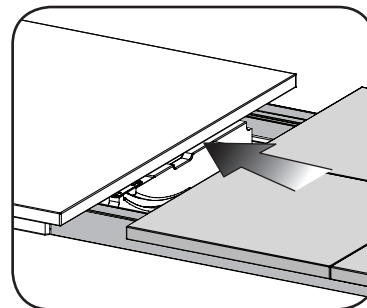
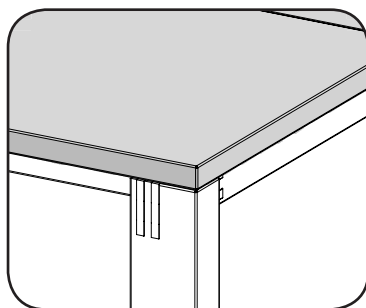
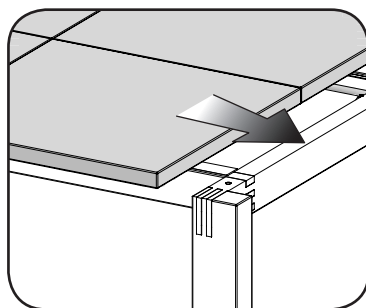
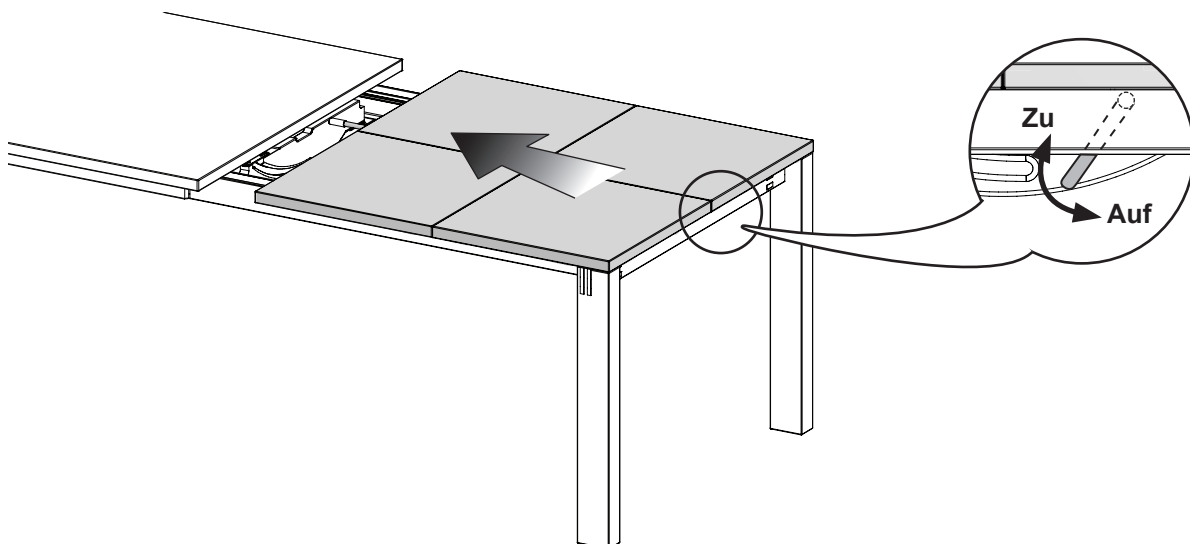

11 Ausrichten und Fixieren der Einlegeplatten

