

88170902C

## Magnum

### Magnum Esstisch mit Einlegeplatte

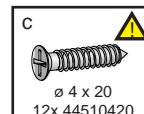
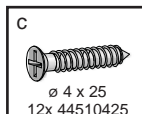
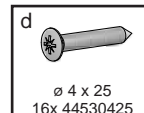
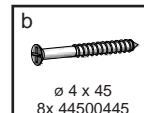
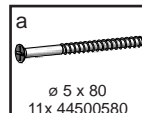
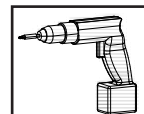
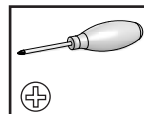
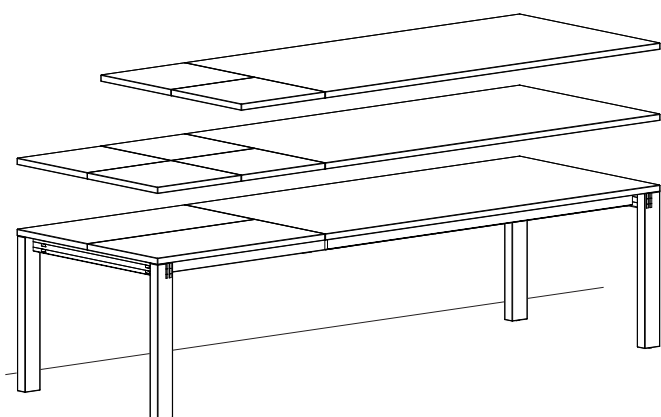

Bei Tisch mit  
Holzplatte  
verwenden

Bei Tisch mit  
Glasplatte  
verwenden

1

#### Hinweis

- Unterlage verwenden!

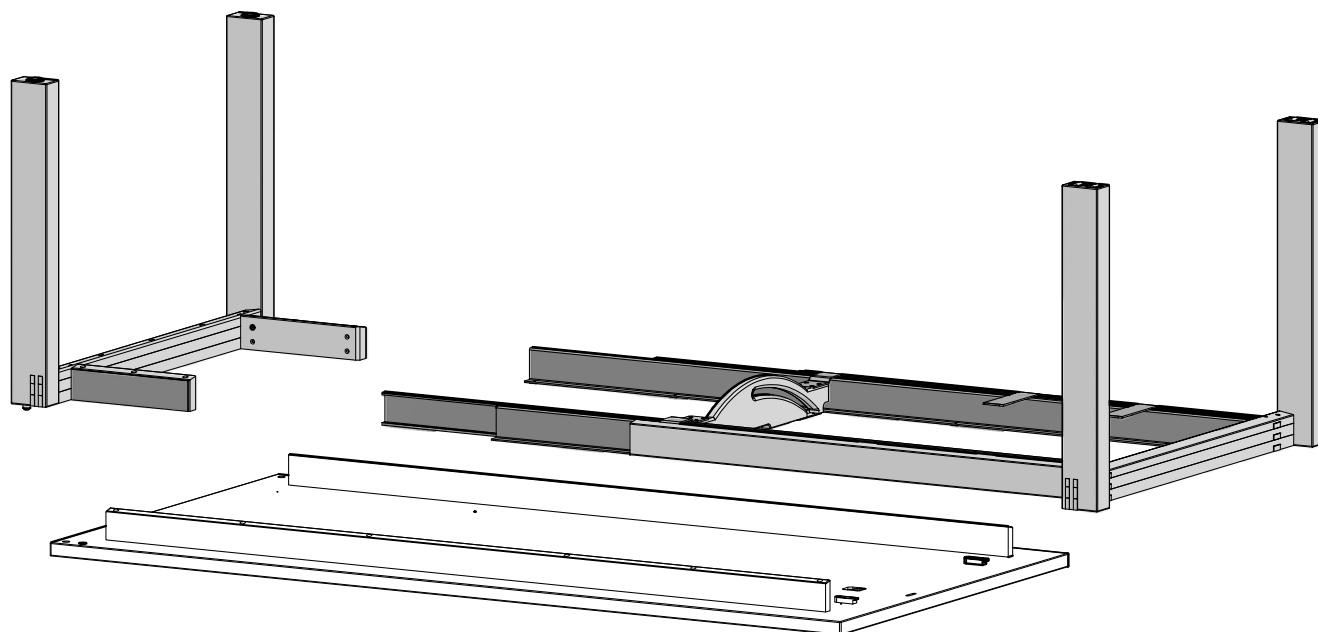

2

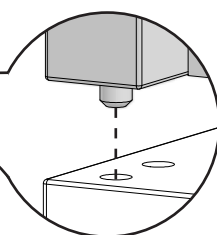
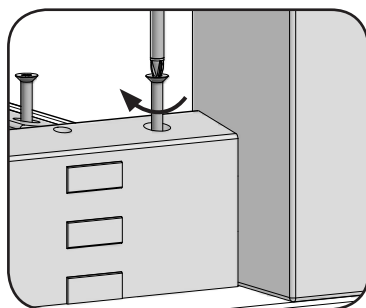
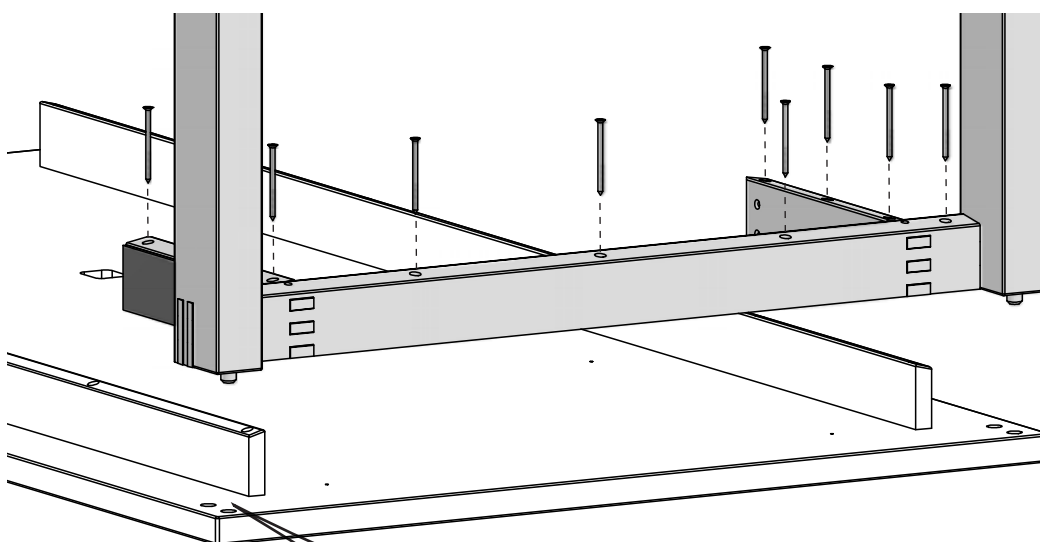

a



11 x  
ø 5 x 80

3

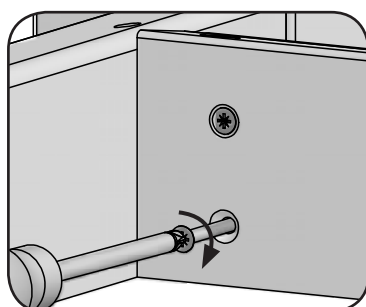
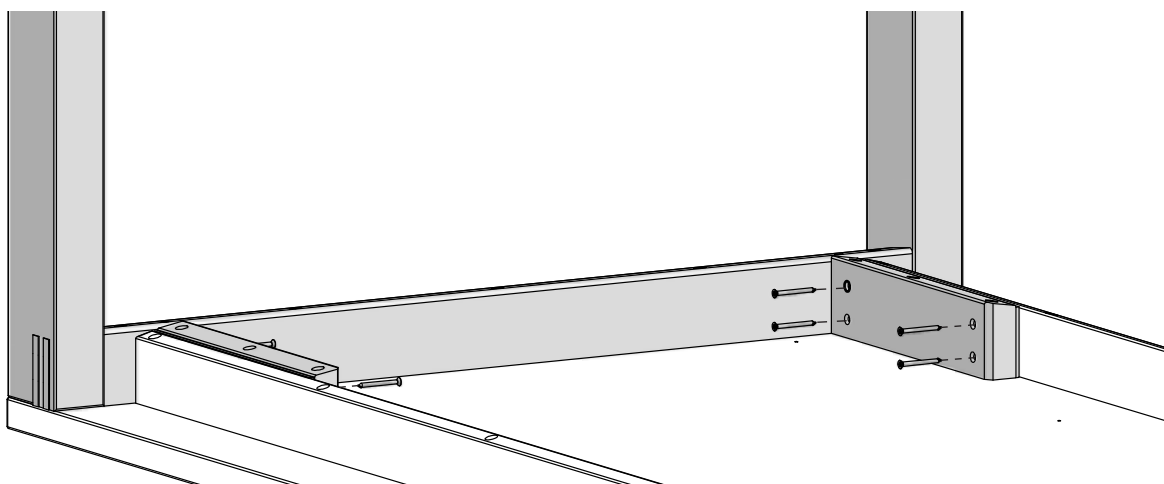

b



8 x  
ø 4 x 45

4

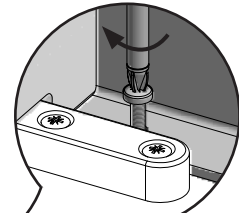
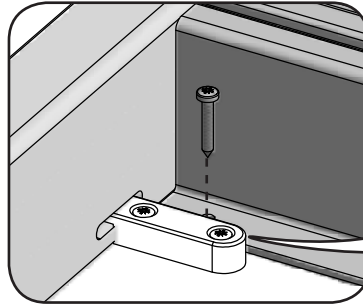
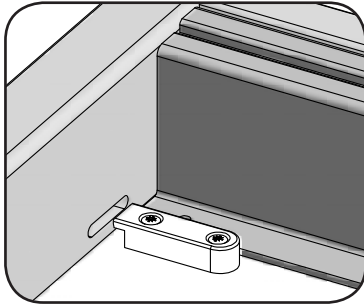
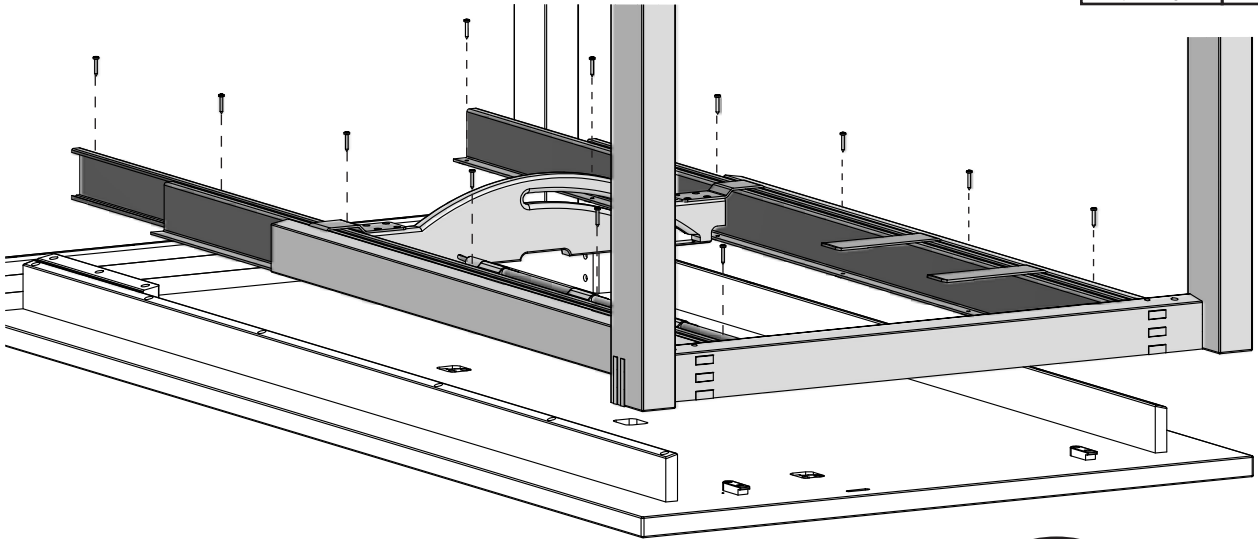
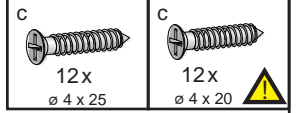

## 5 Schritt 5 - 11: Montage der Einlegeplatten

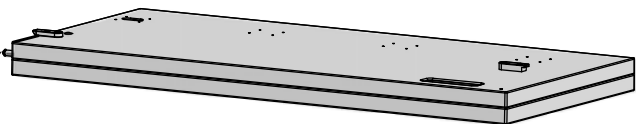
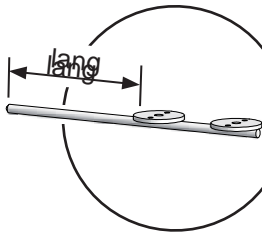

1x 100 cm  
1x 50 cm

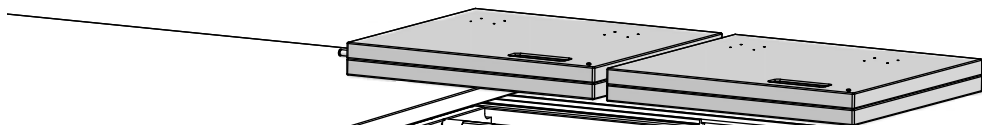

2x 50 cm

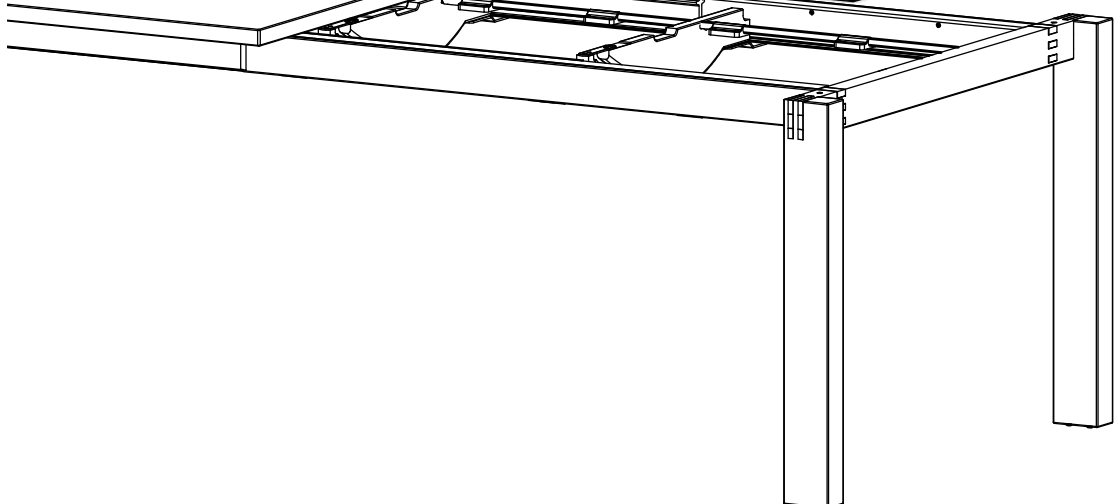

6

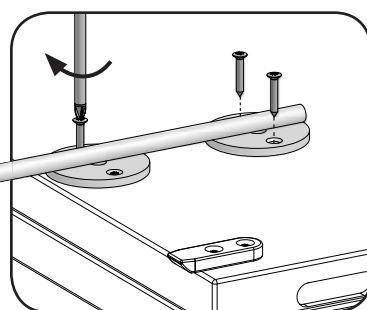
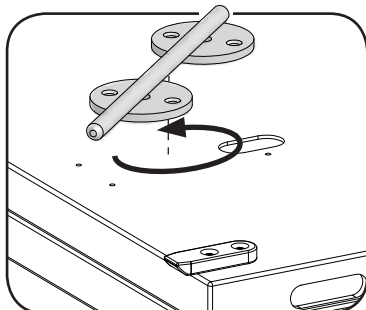
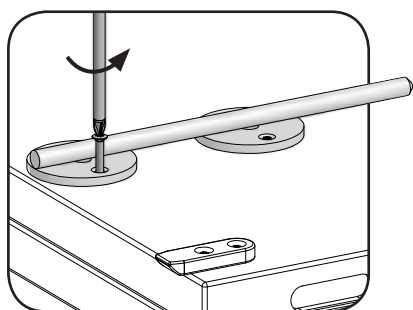
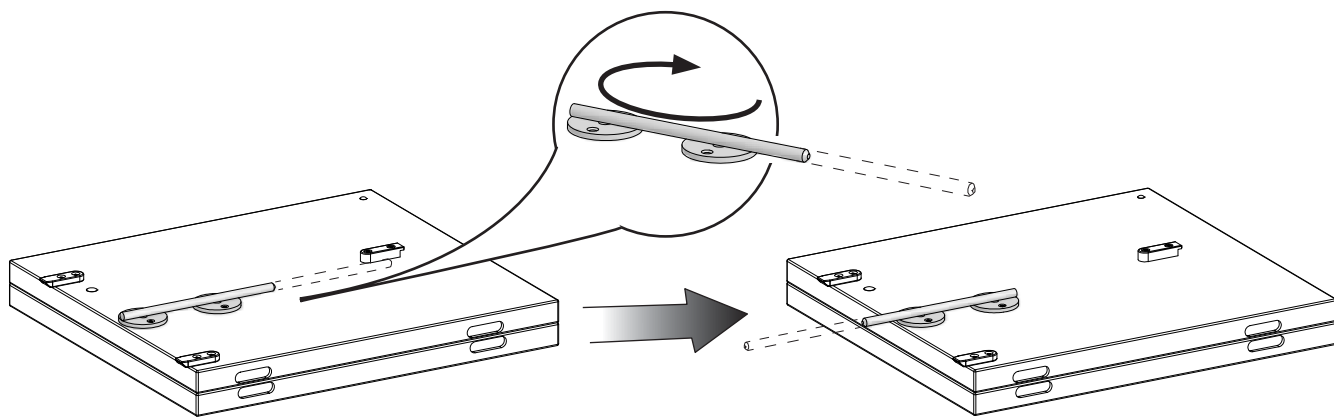

7

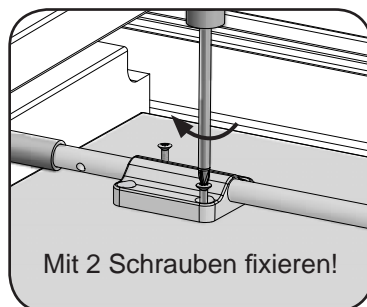
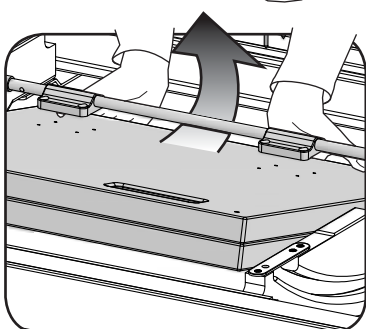
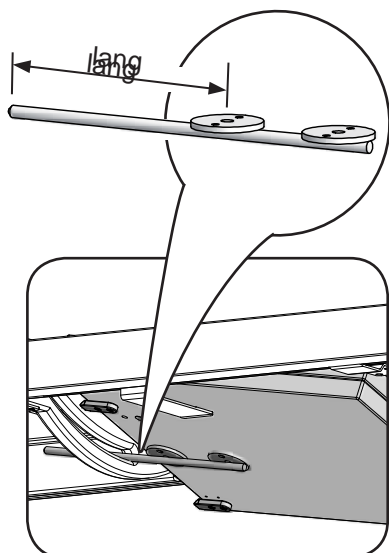
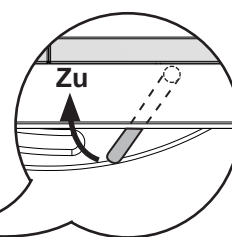
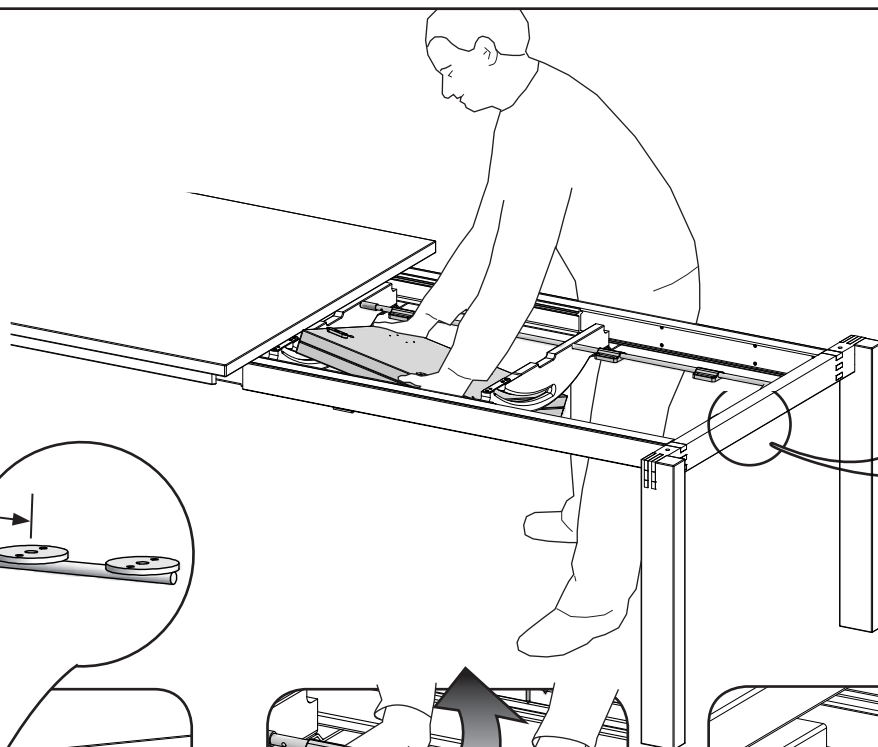
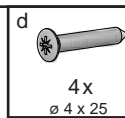

Mit 2 Schrauben fixieren!

8

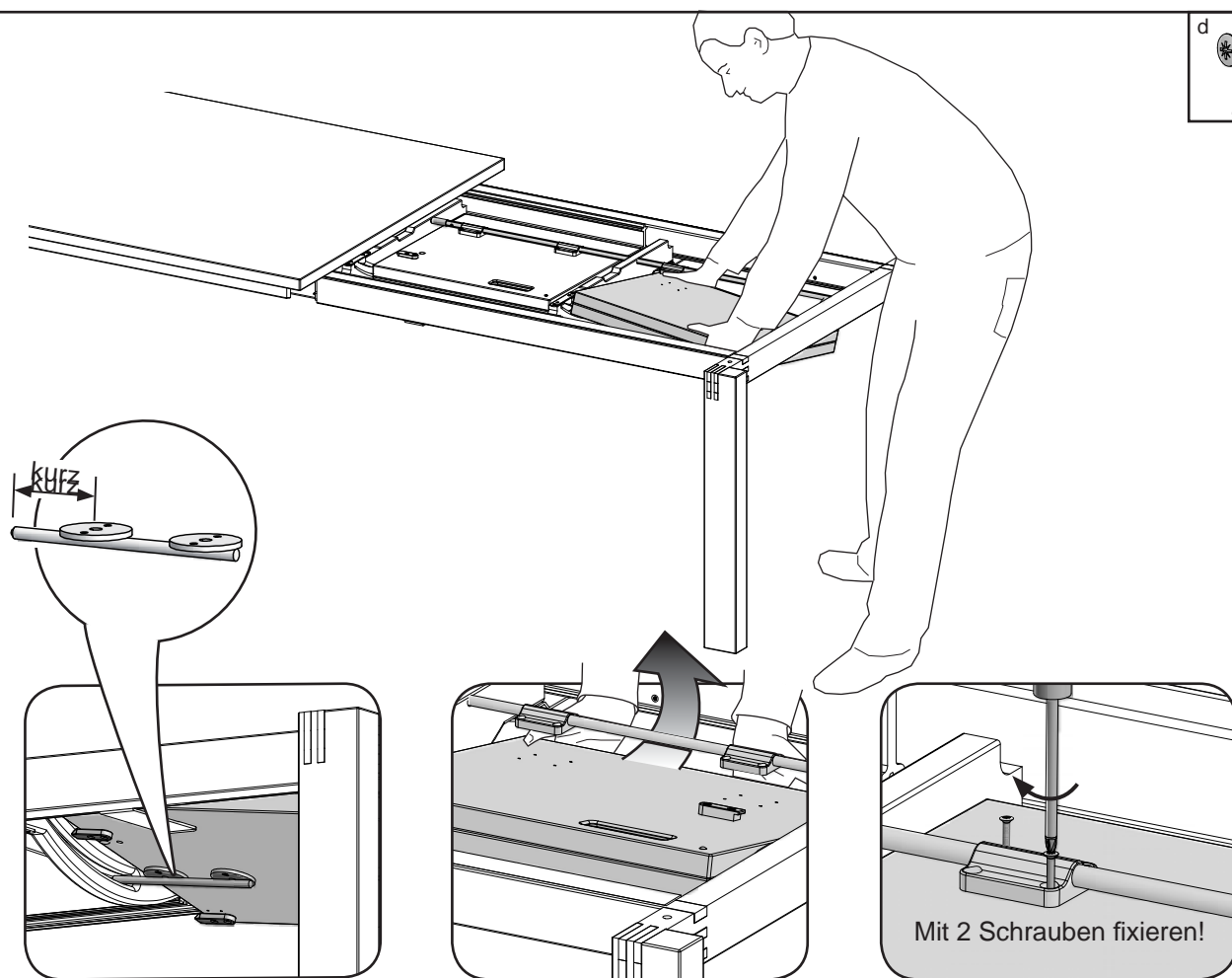
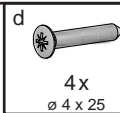

9

**⚠ VORSICHT**

- Glasbruchgefahr!
- Vorsicht beim Zuklappen

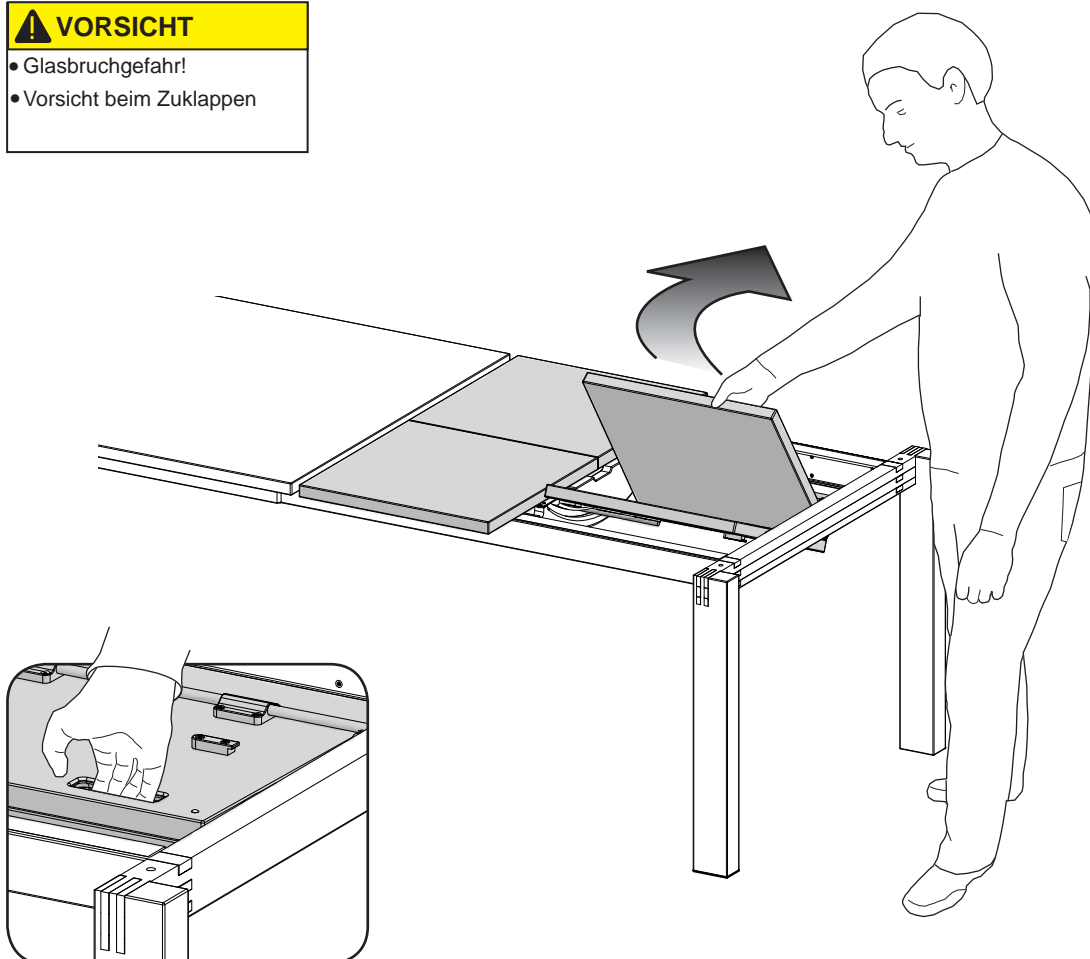

10

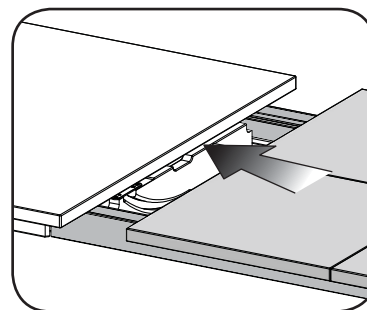
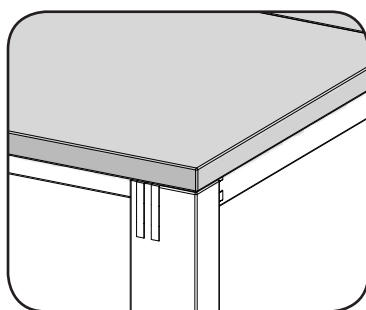
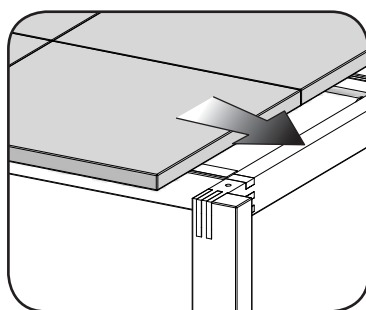
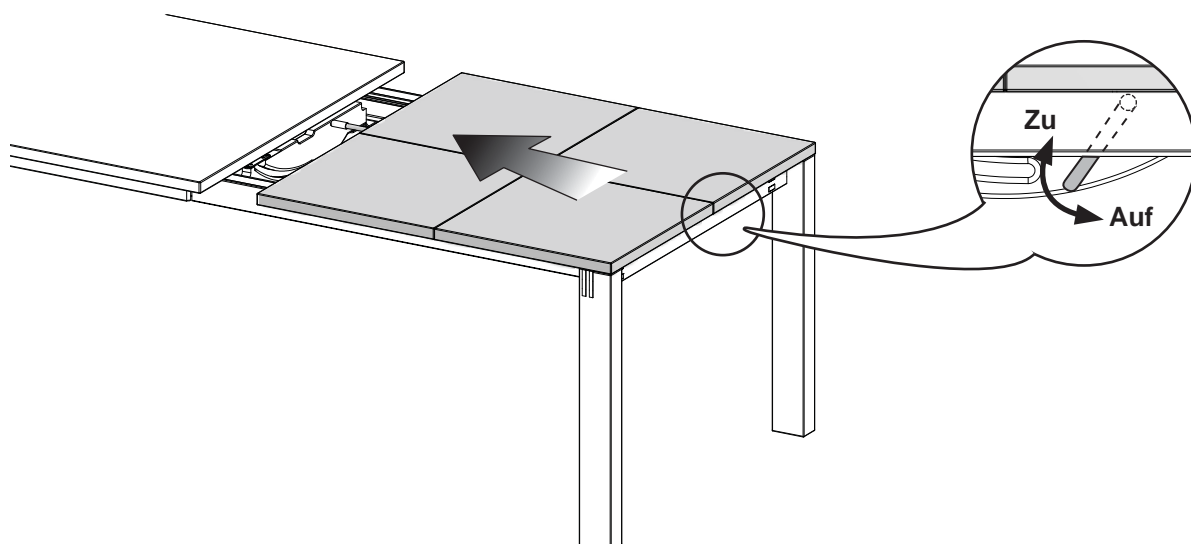

## 11 Ausrichten und Fixieren der Einlegeplatten

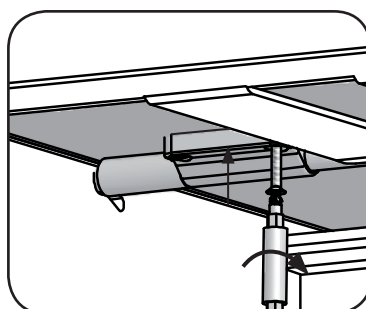
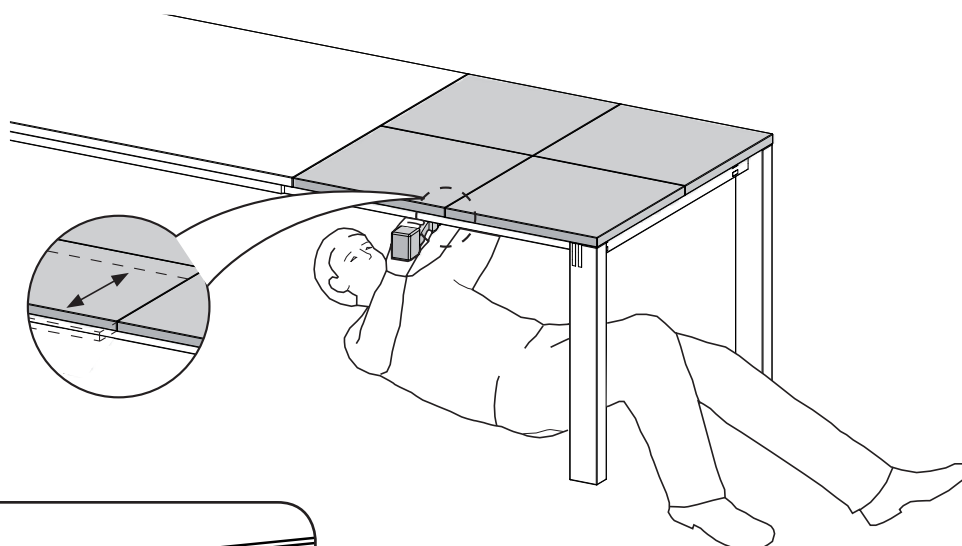
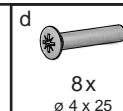

89170901B

## Magnum

### Magnum Esstisch mit Einlegeplatte

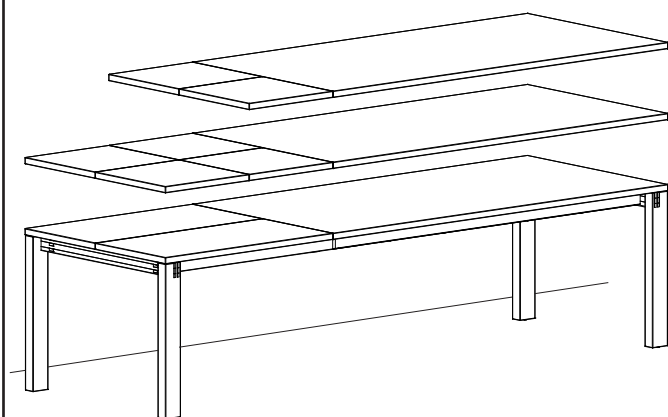
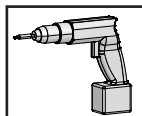

1

#### Hinweis

- Auszug immer bis zum Endanschlag ausziehen.
- Nach dem Ausziehen verriegeln

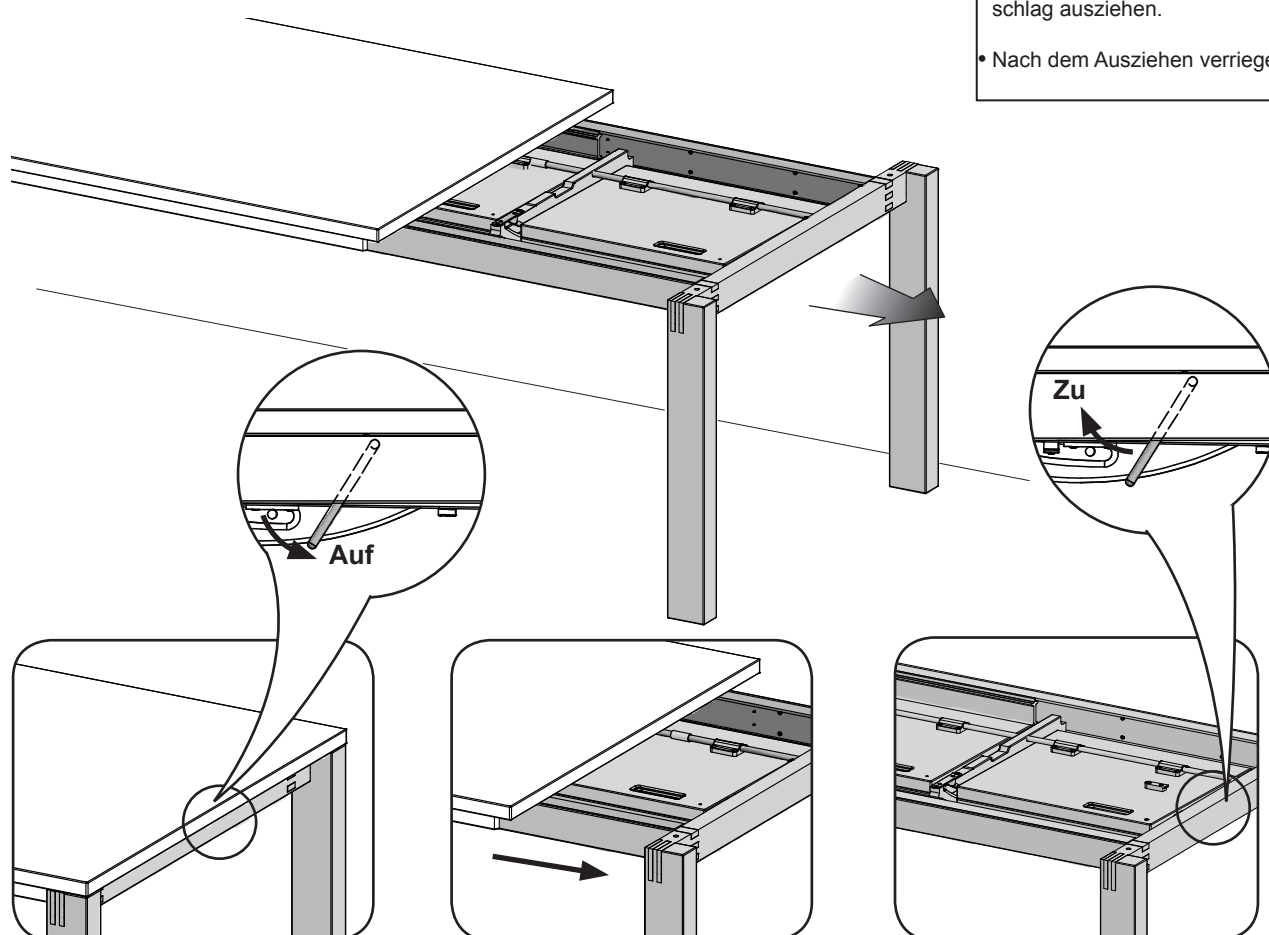

### Hinweis

- Dämpfung abhängig von der Ausführung (Holz, Glas) der Einlegeplatte. Je nach Gewicht wirkt die Dämpfung unterschiedlich.
- Um ein sanftes Herabgleiten der Einlegeplatten zu gewährleisten, muss die Einlegeplatte über jenen Punkt gedreht werden, bei dem sie sich selbst aus-/ zusammenklappt.

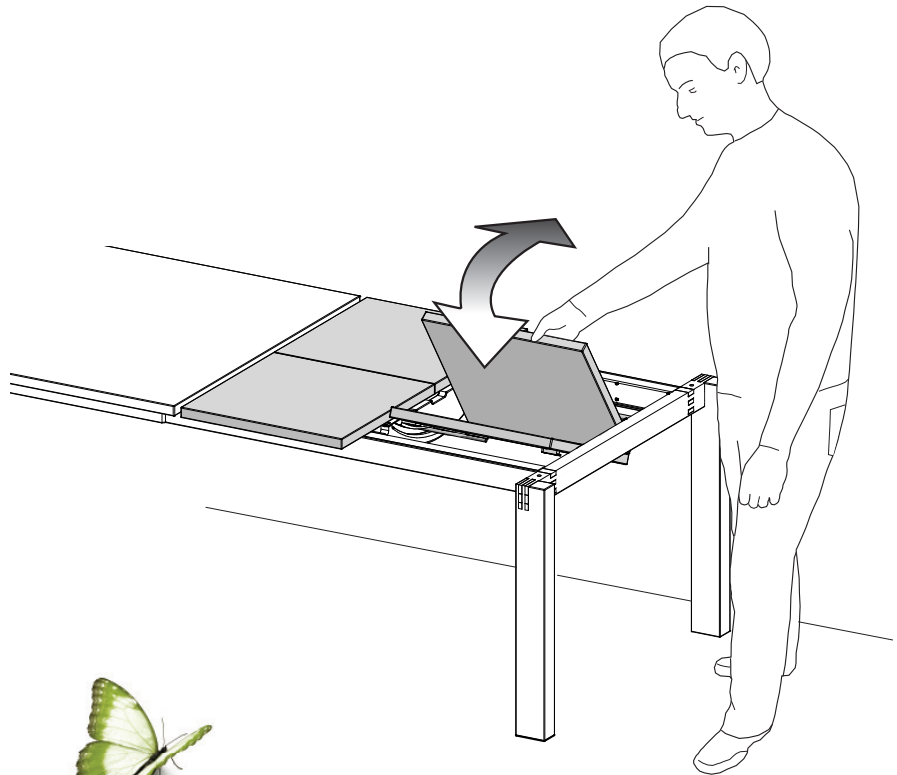
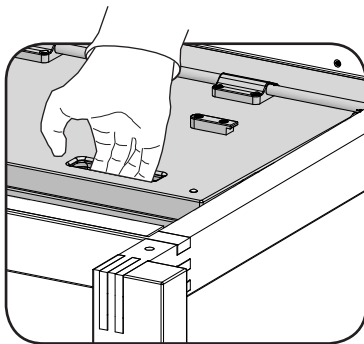

2soft

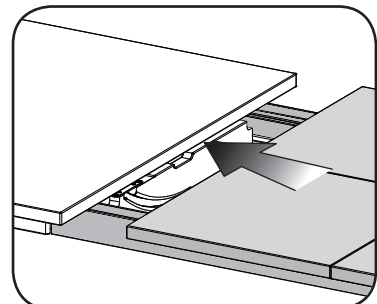
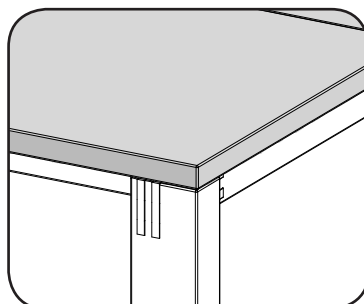
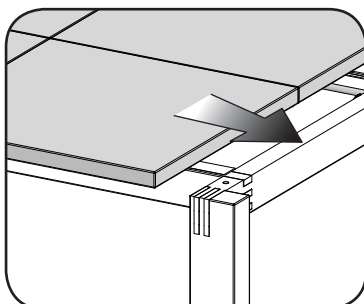
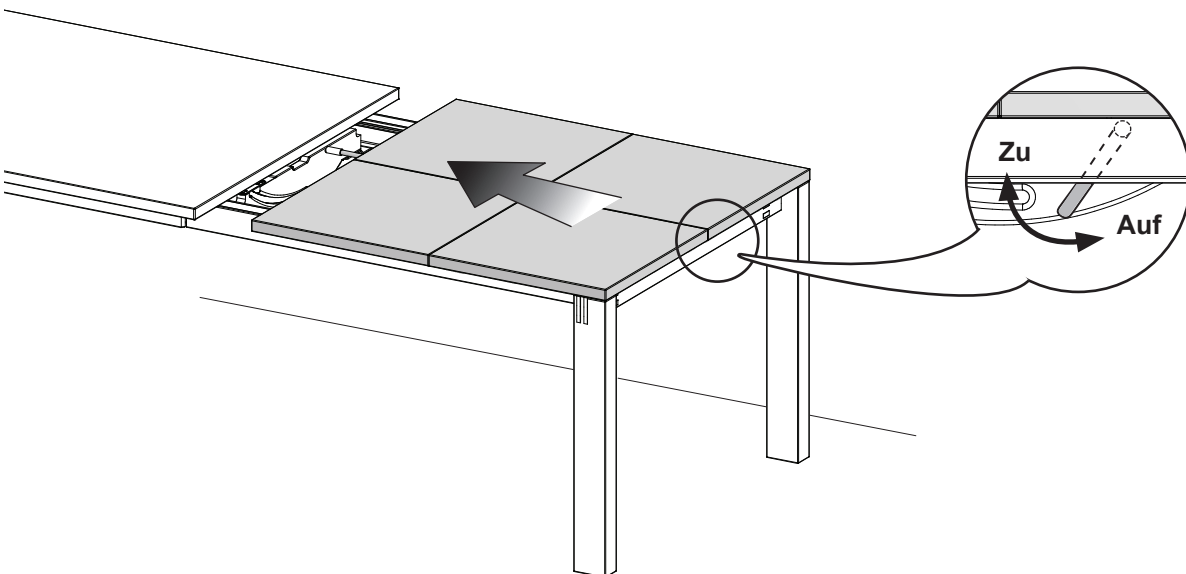



#### 4 Eventuell Einlegeplatten nachjustieren

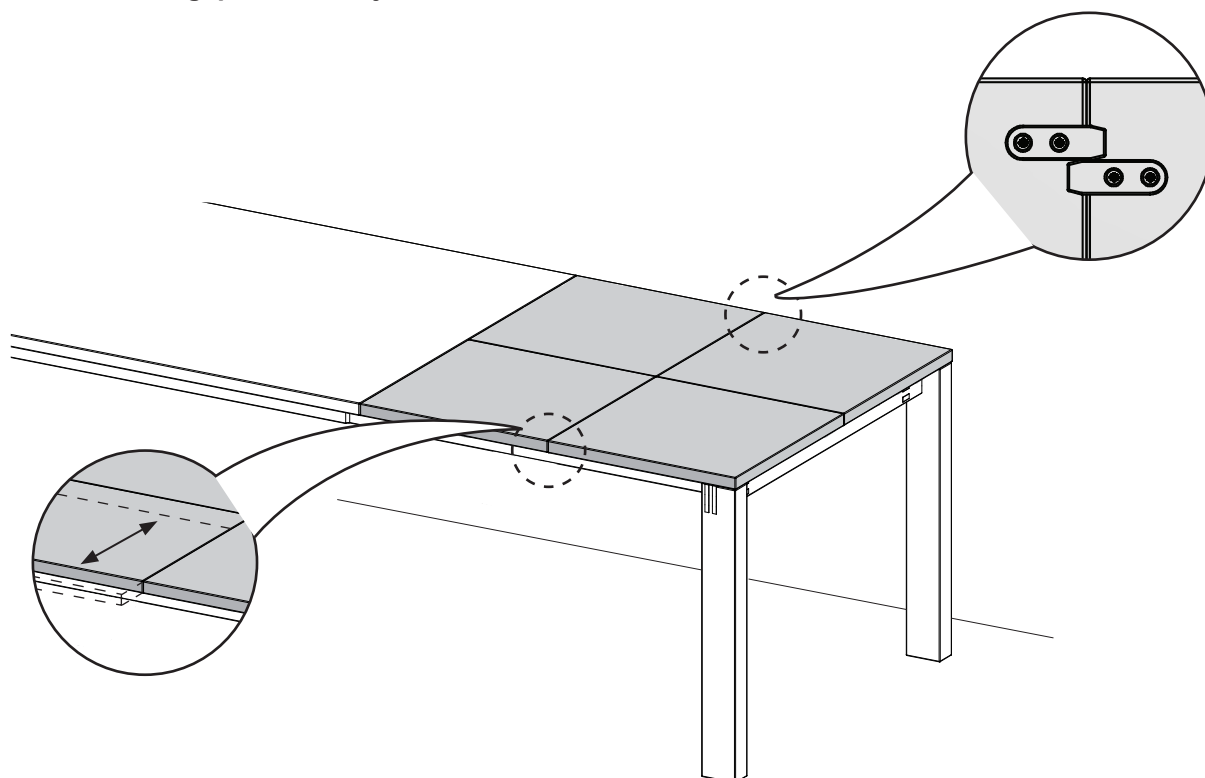

##### 1. Beschlag lösen

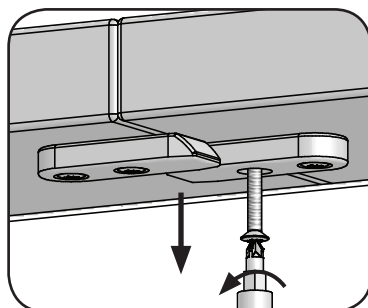
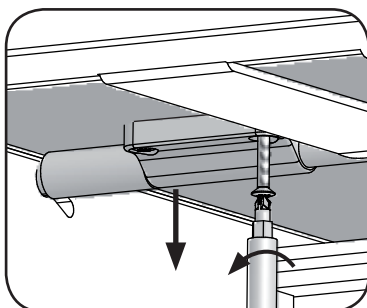

##### 2. Platten ausrichten

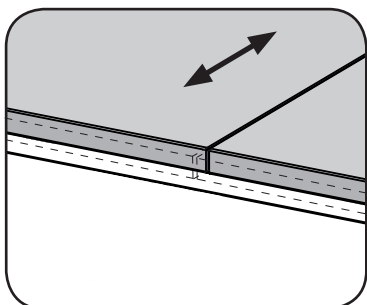

##### 3. Beschlag befestigen

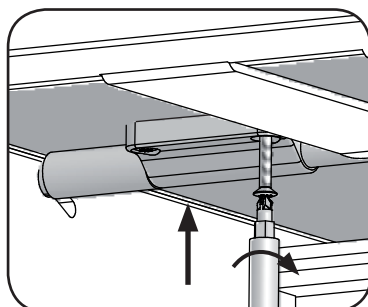
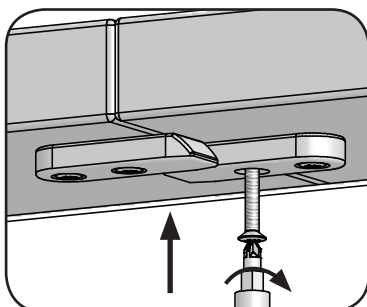

5.

