

IT IS RECOMMENDED THAT LIGHTS ARE INSTALLED BY A COMPETENT PERSON

Before starting the electrical work or connecting your light you will need to switch off your power supply at the fuse box (consumer unit). Either the miniature circuit breaker (MCB) can be turned off for the circuit for your light (it is suggested to apply RED insulating tape over the MCB to prevent it from being accidentally turned on). Or the main switch can be turned off, the circuit fuse removed, and the main switch turned on again to restore power to the rest of the house.

GREEN/YELLOW

BROWN

BLUE

BLUE with brown sleeving

Live wires can also sometimes be signified by a RED wire

Neutral wires can also sometimes be signified by a white or black wire

Earth

Live

Neutral

Switch wire with sleeving



CLASS I Luminaires (Earthed) - Connect the brown wire from the luminaire to the supply live wire (red or brown). Connect the blue wire to the supply neutral wire (black or blue). Connect the green/yellow wire to the supply earth wire (green/yellow) or connect the supply earth to the luminaire earth terminal marked:

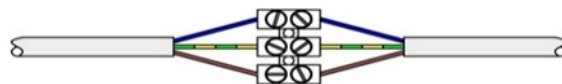

CLASS II Luminaires (Not earthed) - These luminaires are double insulated and have the symbol:



These fittings do not have to be connected to the supply earth. Make sure that the basic insulation of the supply wiring cannot contact touchable metal. Connect the brown wire from the luminaire to the supply live wire (red or brown). Connect the blue wire to the supply neutral wire (black or blue). Isolate the supply earth wire.

If silicone sleeving is provided, fit over the supply cable up to the terminal block or lamp holder, to at least the mounting surface, to protect cable from heat.

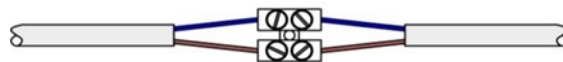

Recycling



Please try to recycle electrical products and components. Check with Local Authority or Retailer for recycling advice.

Guide to Bathroom Lighting Zones Figs 1 & 2

Bathrooms are divided into Zones. These Zones are determined by the closeness of water and humidity and the likelihood of the light fitting getting wet. Bathroom light fittings are given an IP rating, which relates to these zones. The first digit of an IP rating describes its protection from solid objects such as gravel, insects and other dust. The second digit relates to its protection from moisture, which is directly relevant to the bathroom. The higher the number, the more protection it has.

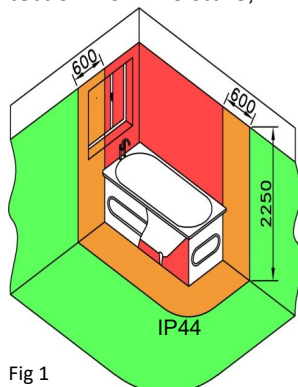





Fig 1

-  Zone 0 is inside the bath or shower. Any light fitting used in this zone must be SELV and rated to at least IP67
-  Zone 1 is the area above the bath to a height of 2.25m from the floor. is the area above the bath or shower to a height of 2.25m from the floor. In this zone a minimum rating of IP45 is required but it is generally accepted that IP65 is used.
-  Zone 2 is the area 0.6m outside the perimeter of the bath and to a height of 2.25m from the floor. A minimum of IP44 is required.
-  Zone 3 is anywhere outside zones 0, 1, and 2 (subject to specific limits) and where no water jet is likely to be used.

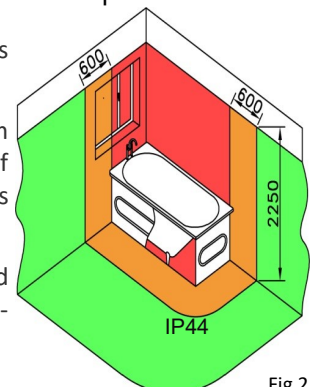
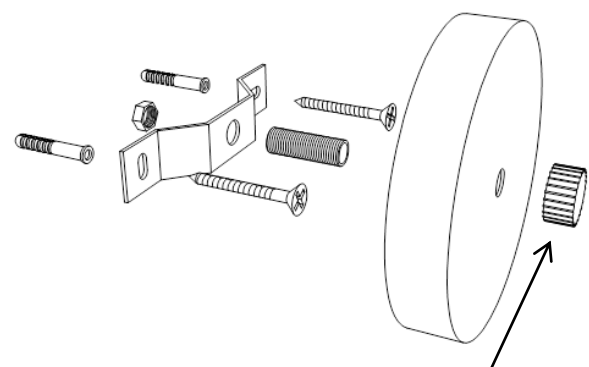
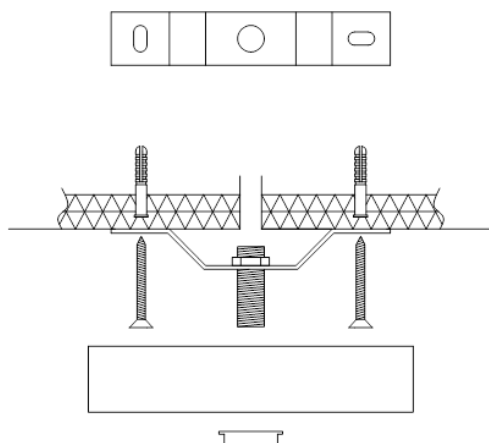
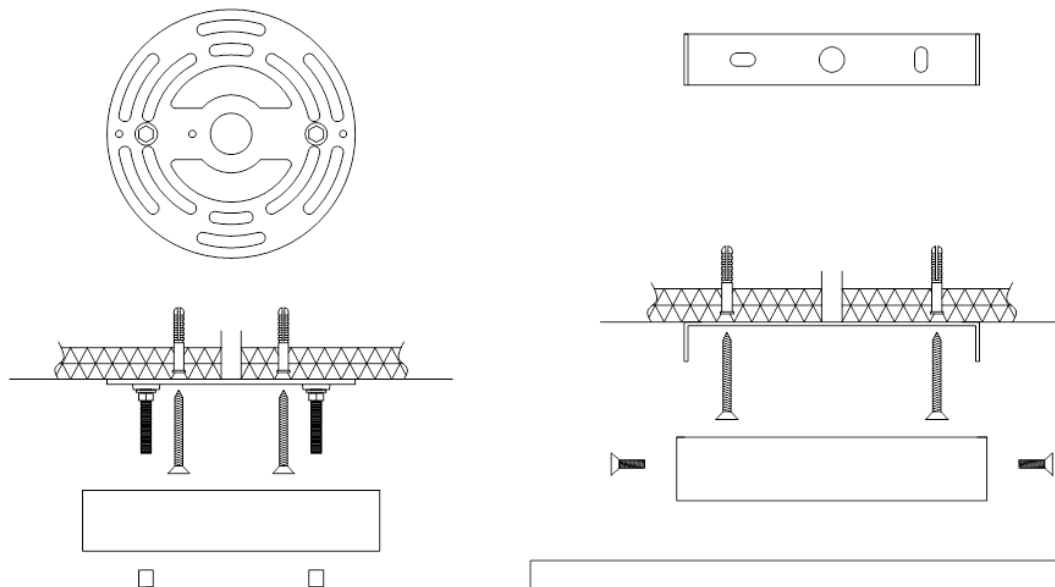

Fig 2

Help line +44 1420 82377

IT IS RECOMMENDED THAT LIGHTS ARE INSTALLED BY A COMPETENT PERSON

Generic Ceiling Mounting



Tighten to minimum of 4Nm
(Newton metre)

Generic Wall Mounting

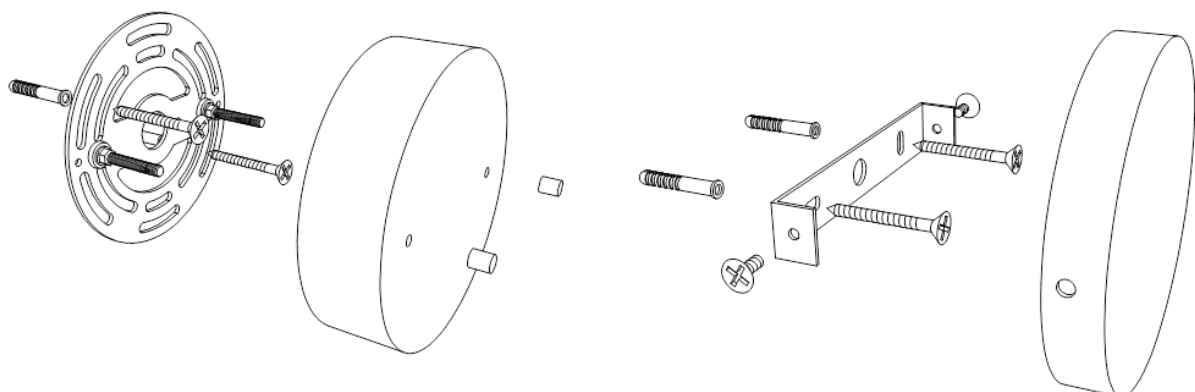

Help line +44 1420 82377