

1

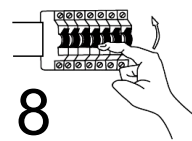

8

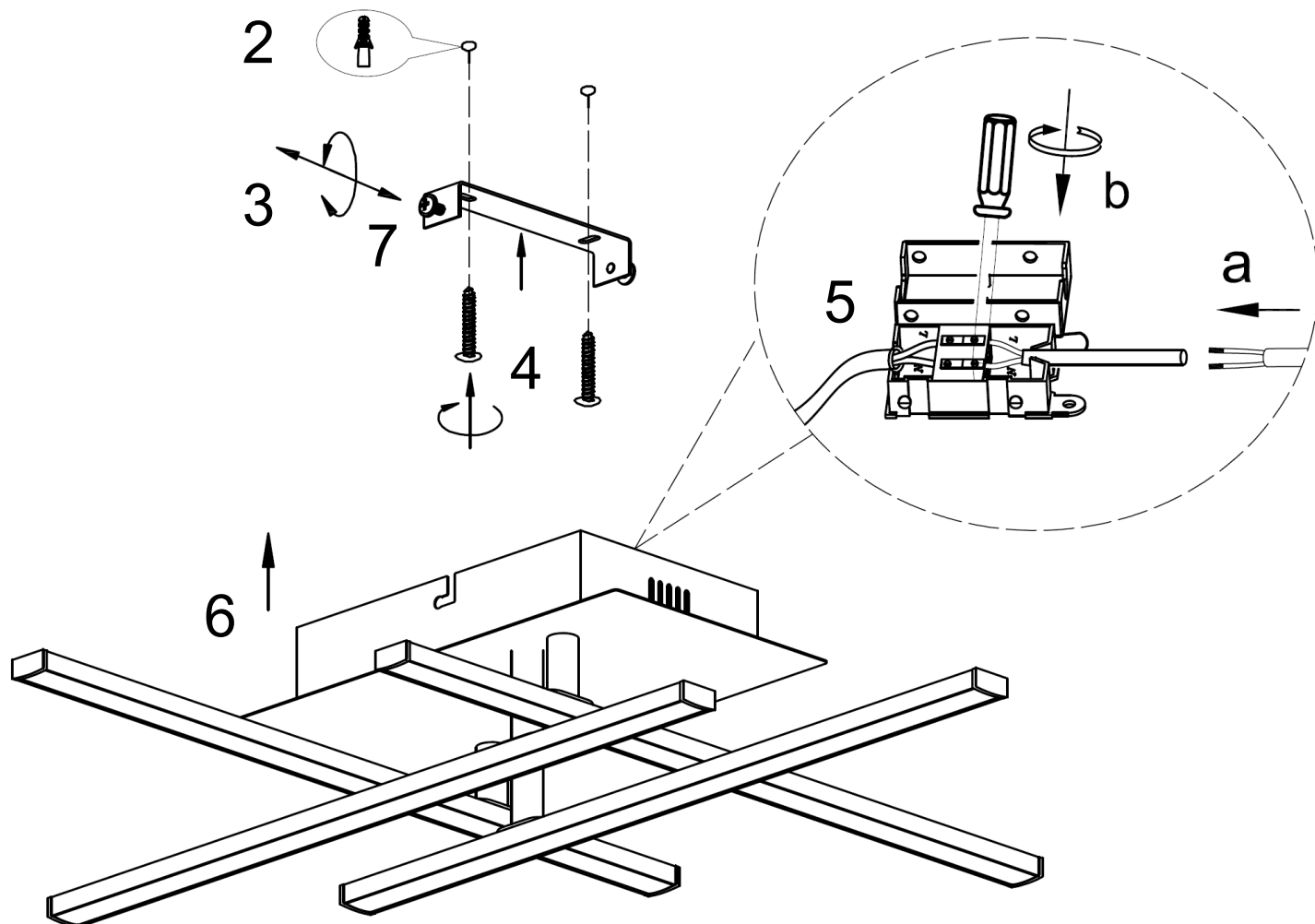

Multi-stage dimmable

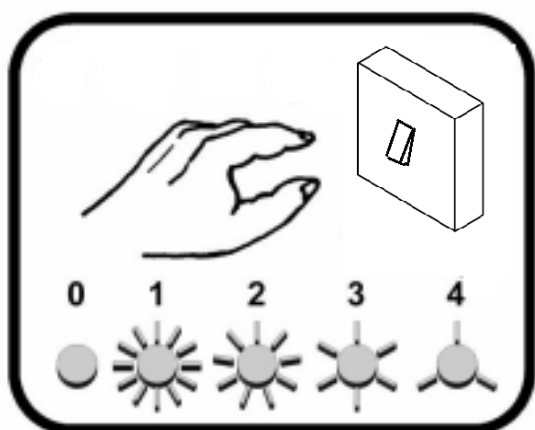

APPROVED  
28/04/2021  
ISSUE 3

## **SAFETY INFORMATION: (Please retain for future reference)**

- Always turn off the mains supply before commencing the installation of this fitting .
- This is a Class 2 product and does not requires an Earth connection – 230 (240) Volts – 50Hz AC.
- This product must be installed in accordance with the national building regulations, if in doubt consult a qualified electrician.
- This fitting is suitable for installation in Indoor locations only .
- Do not mount the fitting in a damp atmosphere.
- The Luminaire should be positioned so that prolonged staring into the luminaire at a distance closer than 0.2m is not expected.
- Do not stare at the operating lamp .
- Ensure sufficient access to the fitting to enable safe maintenance.



### **LED INFORMATION:**

- The fitting is suitable for dimming .
- The LED lamps are not replaceable, when the lamps reach the end of their life the whole luminaire shall be replaced.
- The LED lamps and chip board are not removable

### **AFTERCARE AND MAINTENANCE:**

- Always disconnect power supply when servicing or cleaning.
- Clean only with a dry or slightly damp cloth.
- Do no use any abrasive cloths or cleaners as this may damage the product

#### **MAINS SUPPLY**

#### **LIGHT FITTING**

