

Assembly Instructions For

WB1487

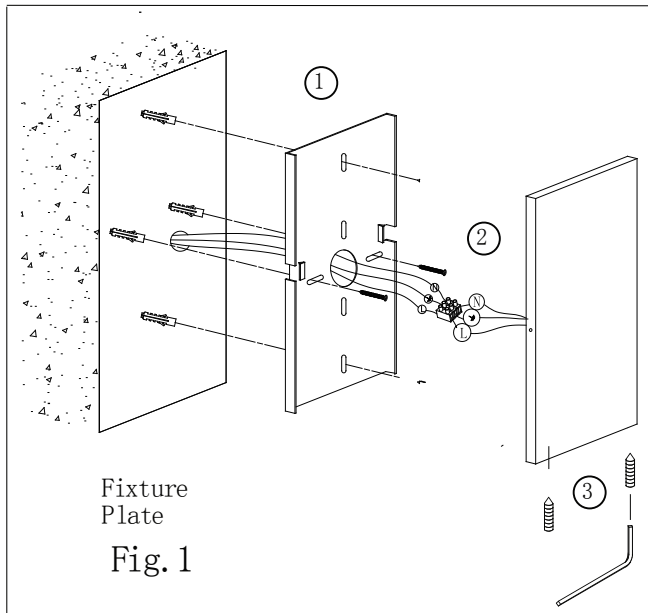

11/12



IMPORTANT
TURN OFF THE POWER AT THE MAIN FUSE OR
CIRCUIT BREAKER BOX
BEFORE STARTING INSTALLATION

Carefully unpack and identify all parts before assembly. Bulb not included

1. Install mounting plate (see fig.1):
A. Take supply wires from wall and carefully pass them through center hole of mounting plate. Note: The flat surface of mounting plate must face the wall and the angled rim side facing toward you.
B. Install mounting plate onto the outlet box using two screws supplied.
2. Connect electrical wires (see fig.1): Follow enclosed supplement installation instruction for connection.
3. Install fixture plate. While carefully tucking all electrical wires inside of fixture plate, install the fixture plate onto the mounting plate by fastening with set screw. Use provided hex key to tighten.
4. A. Slip candle tube over socket.
B. Install light bulb (not included). See relamping label at socket area for type and maximum allowed wattage.
C. Install fabric shade by snapping onto installed bulb.
5. Hook glass drop onto bottom of fixture.

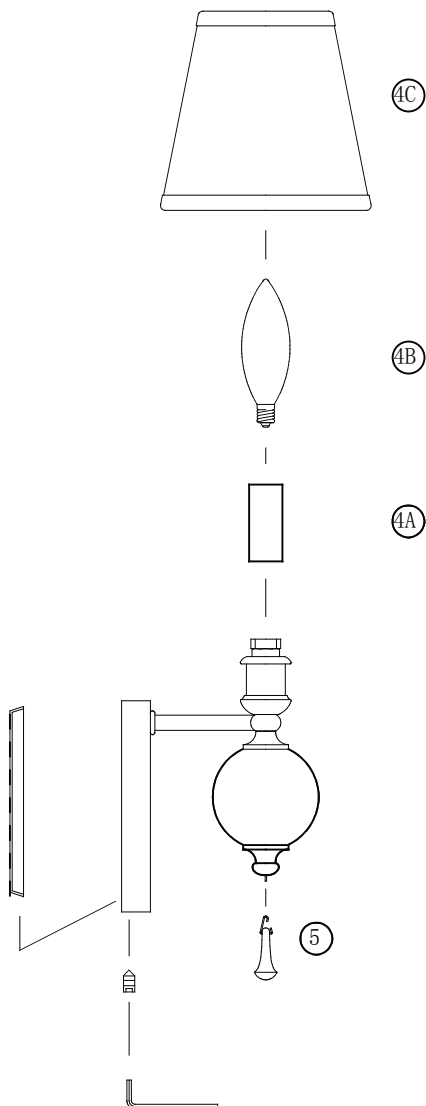

FEISS®

EST. 1955

GENERATION
BRANDS®