

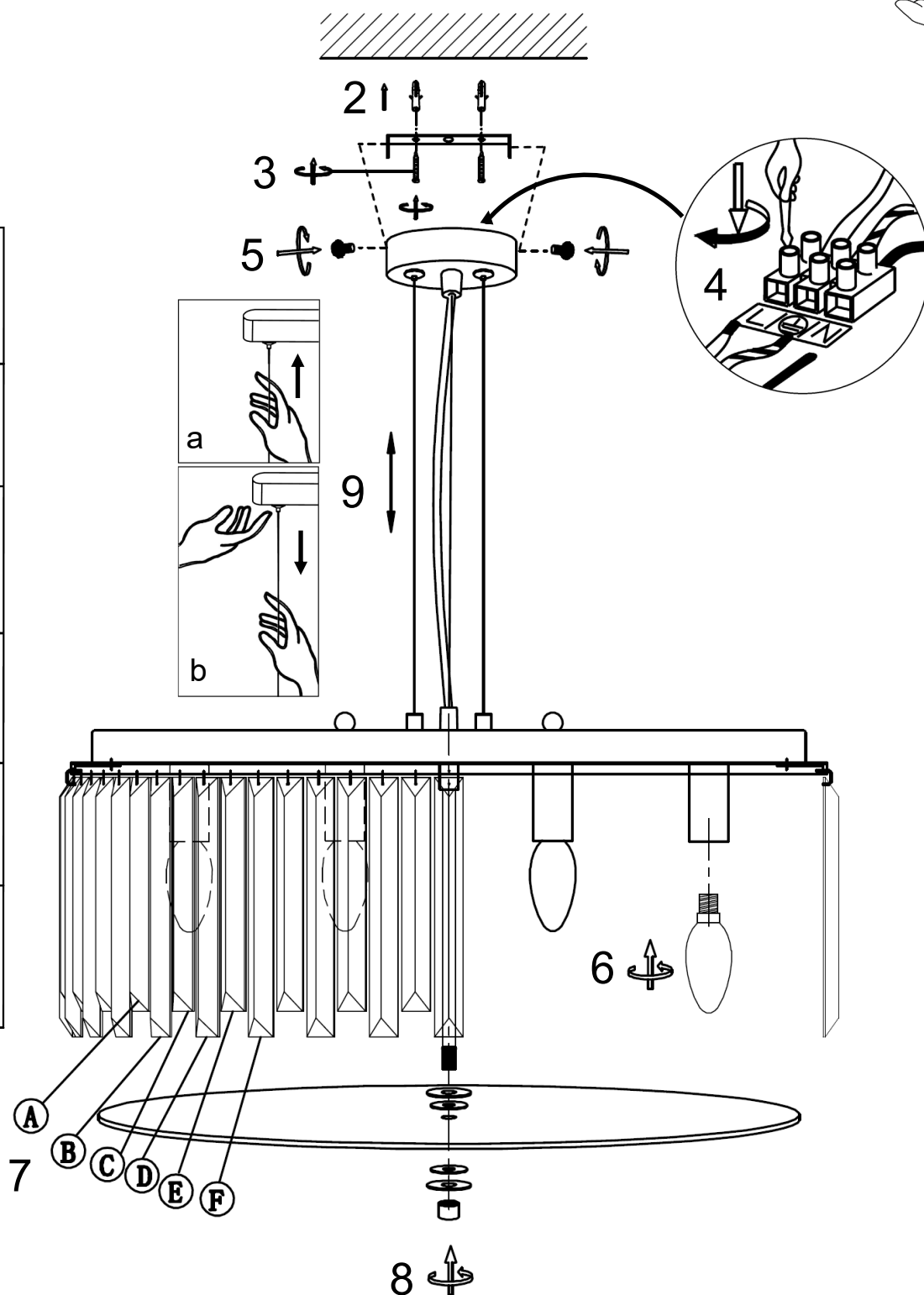

20CM	(A) Smoky Gray 12X
18CM	(B) Amber Color 12X
20CM	(C) Transparent Color 12X
18CM	(D) Smoky Gray 12X
20CM	(E) Amber Color 12X
18CM	(F) Transparent Color 12X



SAFETY INFORMATION: (Please retain for future reference)

- Always turn off the mains supply before commencing the installation of this fitting .
- This is a Class 1 product and does requires an Earth connection – 230 (240) Volts – 50Hz AC.
- This product must be installed in accordance with the national building regulations, if in doubt consult a qualified electrician.
- This fitting is suitable for installation in Indoor locations only . 
- Do not mount the fitting in a damp atmosphere.
- Do not stare at the operating lamp when using LED lamps .
- The Luminaire should be positioned so that prolonged staring into the luminaire at a distance closer than 0.2m is not expected
- Ensure sufficient access to the fitting to enable safe maintenance.

LAMP INFORMATION

- Do not exceed the maximum wattage and bulb type stated on the lamp holder.
- This fitting is suitable for use with normal incandescent or LED lamps.
- This fitting is suitable for dimming , however if the luminaire is fitted with LED lamps they must be a “dimmable “ version

AFTERCARE AND MAINTENANCE:

- Always disconnect power supply when servicing or cleaning.
- Clean only with a dry or slightly damp cloth.
- Do no use any abrasive cloths or cleaners as this may damage the product

ADDITIONAL INFORMATION:

- The fitting has a ‘rise and fall’ mechanism to allow height adjustment. To shorten the fitting hold each wire in turn and gently push upwards to the desire height the support wire will freely move into the ceiling can (a). If required the fitting can be lengthened back to the original height, push the small metal release pins in individually, this will release the clamp and allow each support wire to become free to lengthen (b).

