

Lexi 3 Light Pendant**F3113/3 1.0****GENERATION BRANDS****Chandelier****GENERAL PRODUCT INFORMATION:**

These fixtures are intended to be installed utilizing NEC compliant junction boxes.

This product is safety listed for damp locations.

CAUTION - RISK OF FIRE

This product must be installed in accordance with the applicable installation code by a person familiar with the construction and operation of the product and the hazards involved.

Use minimum 90°C supply conductors.

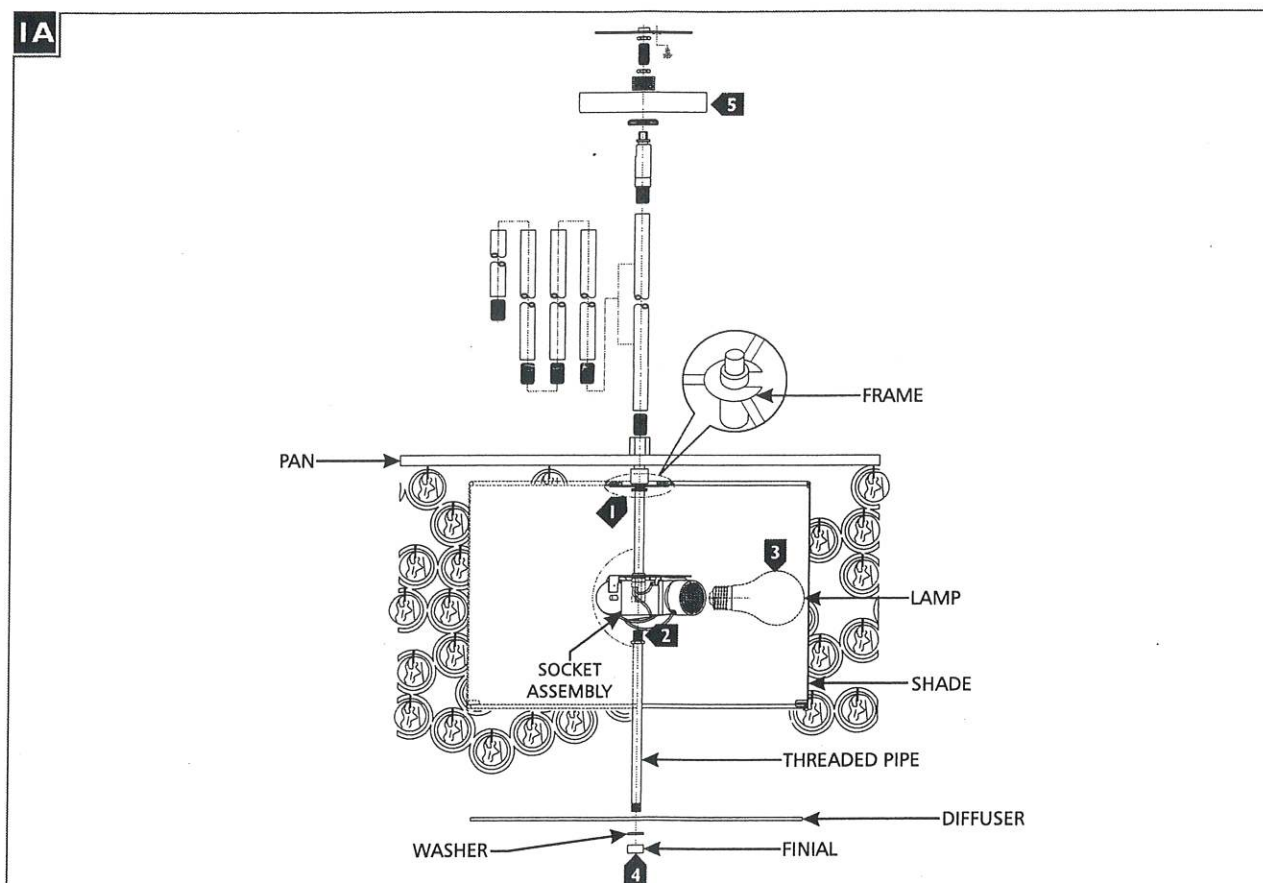

- 1** Feed the fixture wires through the shade and pan, then screw the socket assembly to the pan ensuring that the frame is positioned properly.
- 2** Screw the threaded pipe to the bottom of the socket assembly.
- 3** Screw the lamps into the sockets. Refer to the label on the lamp socket for Max Wattage information.
- 4** Place the diffuser onto the threaded pipe and secure it place with the washer and finial.
- 5** Follow enclosed supplement installation instructions for electrical and fixture installation onto junction box.