

# Montageanleitung Montážny návod

## MANHATTAN

Type/Typ **76**  
MN 170/02

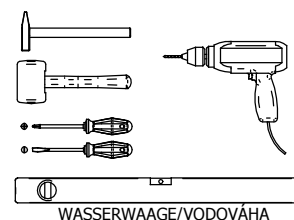
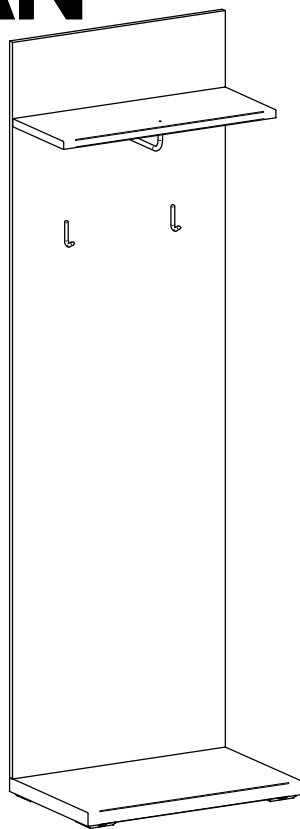

1



x2

2



ø6,3x11  
x4

3

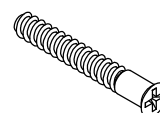

ø7x50  
x4

4



ø8x35  
x3

5

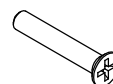

ø5x40  
x6

6

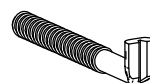

ø5x50  
x2

7

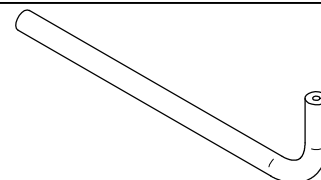

x1

8\*

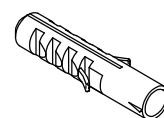

ø10x50  
x2

\* NICHT BEINHALTET IM BESCHLAGBEUTEL!  
\* NIE JE SÚČASŤOU KOVANIA!

9

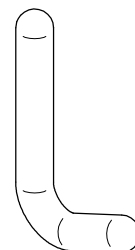

x2

10

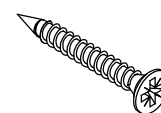

ø4x30  
x8

11

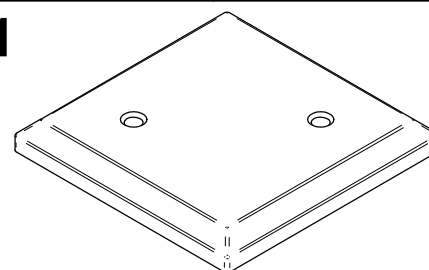

x4

## SERVISKARTE / SERVISNÁ KARTA

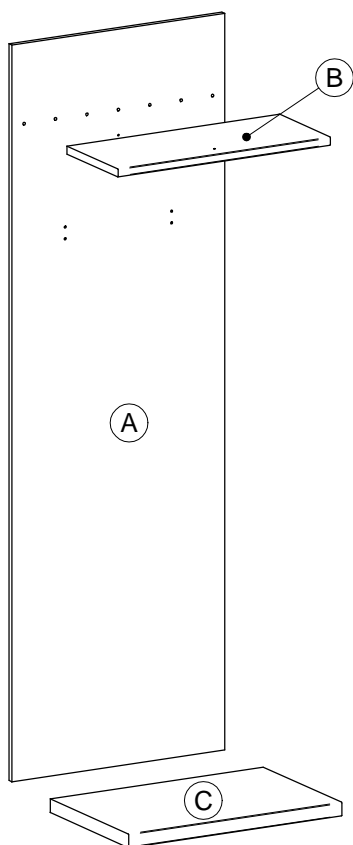

# 1

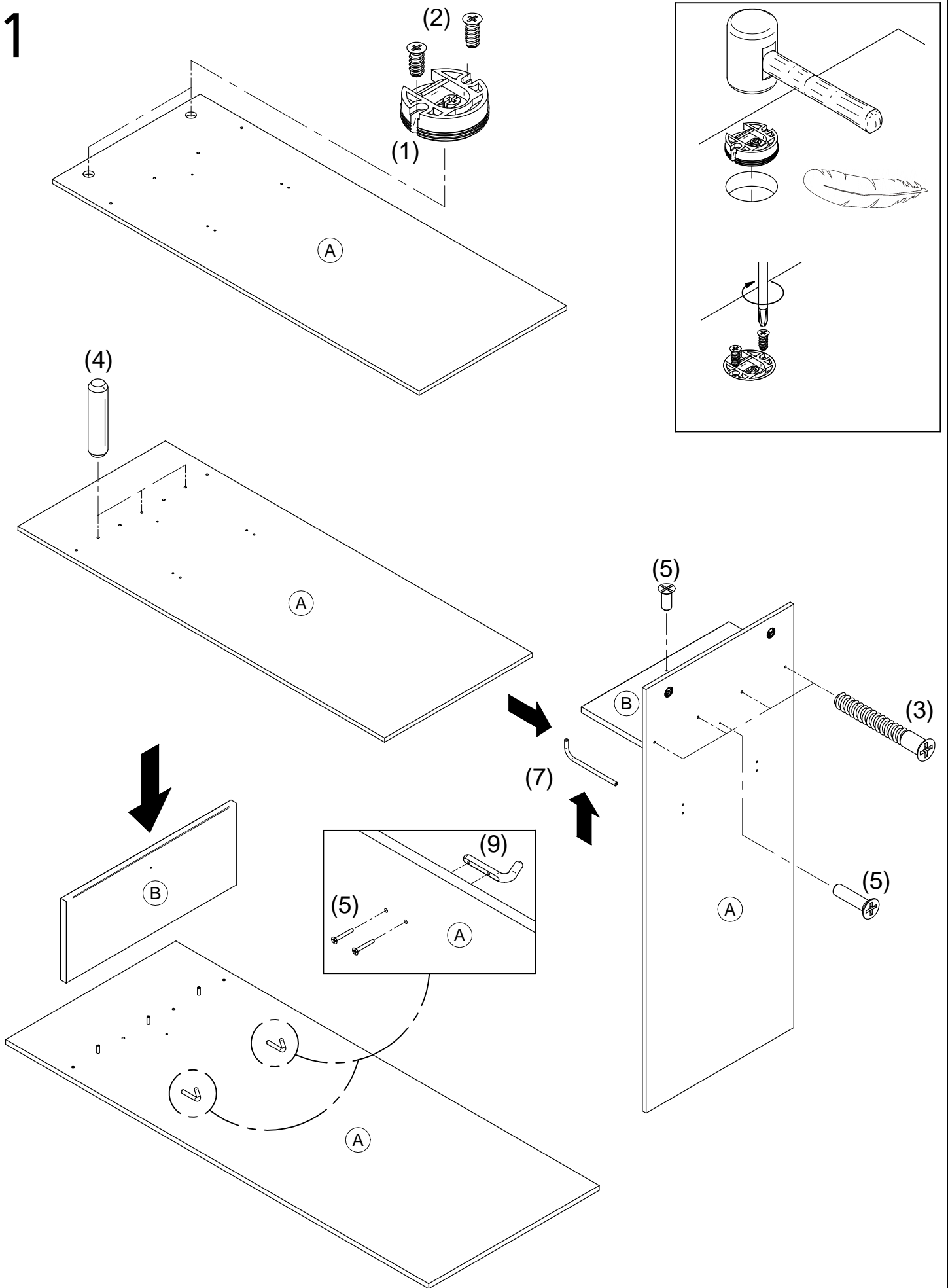

**Achtung!** Bitte nur Schraubenzieher zu verwenden, keinen Akkuschauber!  
**Pozor!** Prosím skrutkujte manuálne, nie akuskrutkovačom.

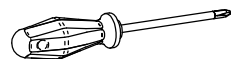

# 2

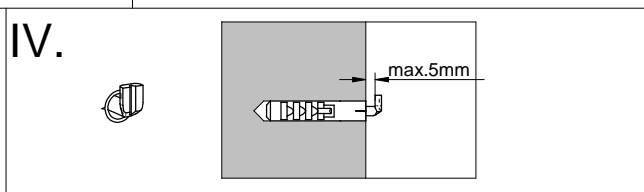
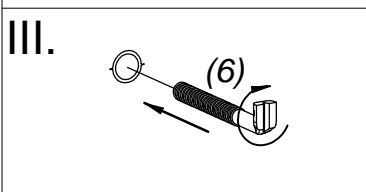
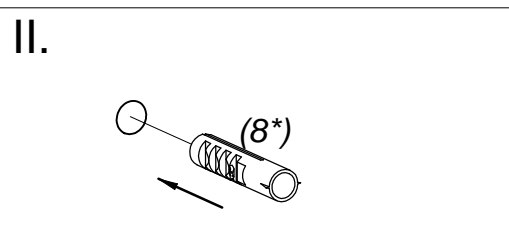
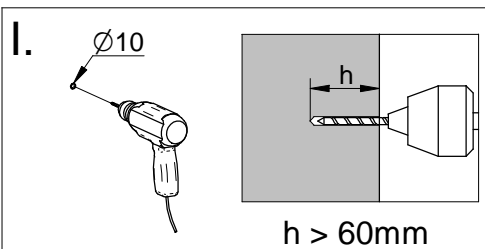
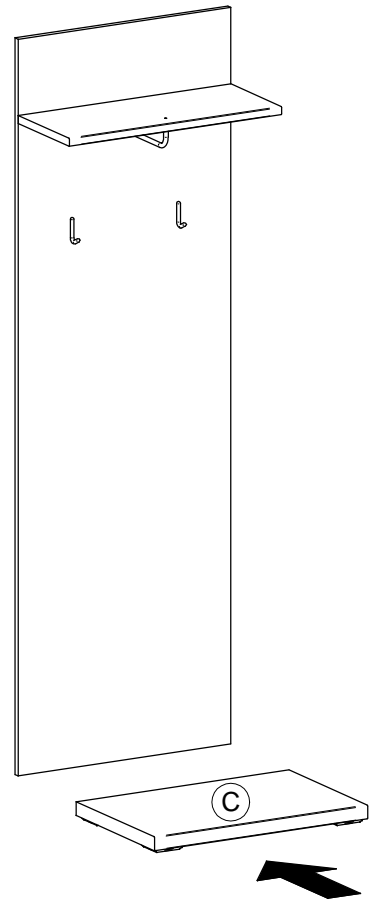
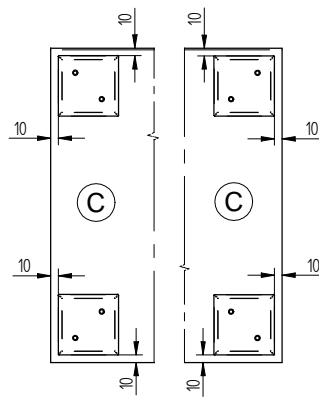
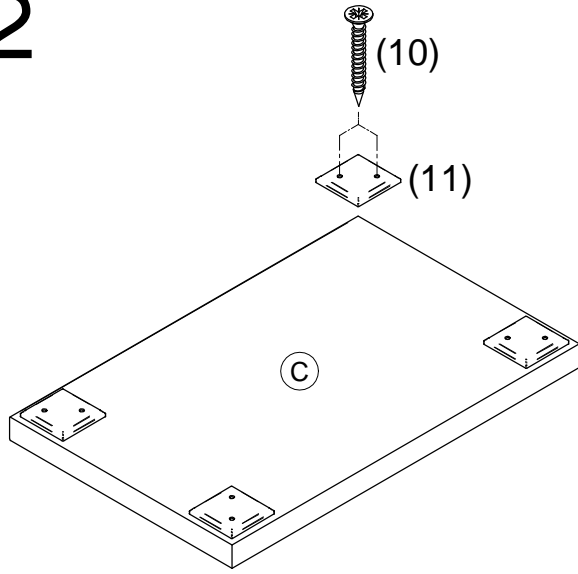

\*Befestigungsdübel ist kein Bestandteil der Verpackung. Es ist nötig, einen geeigneten Dübel zu wählen, je nach der Tragfähigkeit und Zusammensetzung der Mauer, an die Schränke gehängt werden.  
 Falls Sie sich nicht sicher sind, welcher Typ von Dübel Sie brauchen, nehmen Sie Kontakt mit dem nächsten Fachhandel auf.

\*Upevňovacia hmoždinka nie je súčasťou balenia. Je nutné, zvoliť vhodnú hmoždinku vzhľadom na nosnosť a typ steny, na ktorú nábytok vešiate.  
 Ak nie ste si istý, aký druh hmoždinky potrebujete, kontaktujte najbližšie železiarstvo.

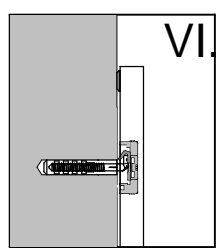
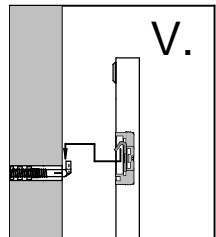

Höheneinstellung / výškové nastavenie

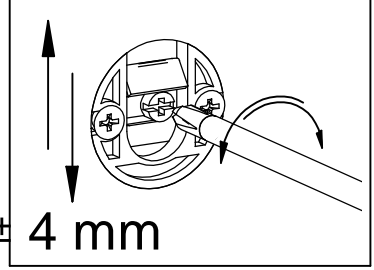

## Bohrung plan / Vrtací plán

