

>>Kommode<<

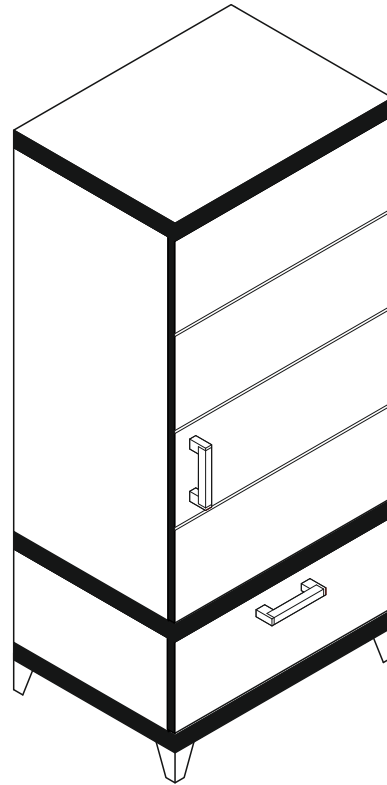
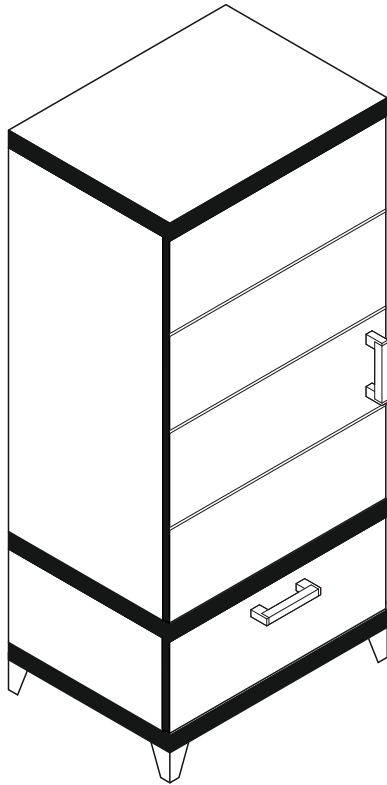

D Montageanleitung

GB Assembly instructions

FR Notice de montage

TR Montaj talimatı

IT Istruzioni di montaggio

NL Handleiding voor de montage

RU Инструкция по монтажу

CZ Montážní návod

HU Szerelési útmutató

RO Instrucțiuni de montaj

PL Instrukcja montażu

SK Návod na montáž

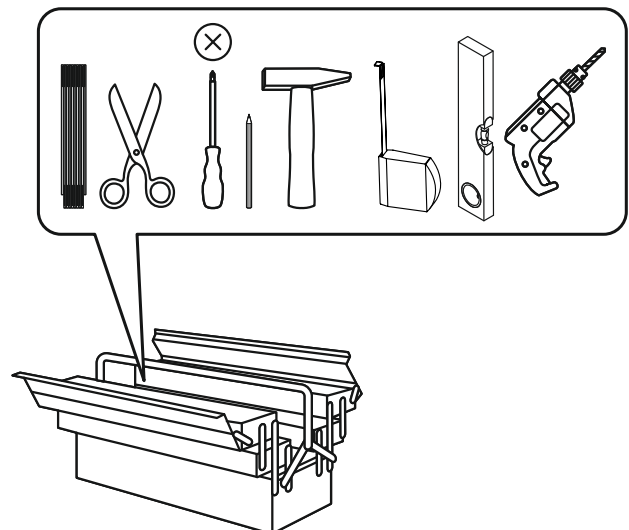
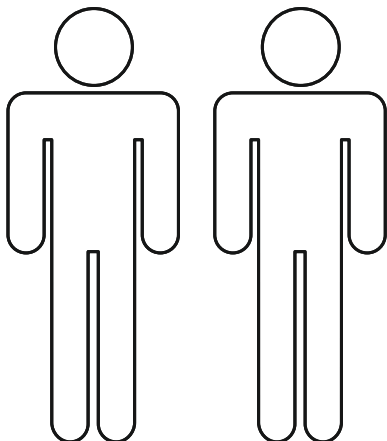

Service • Assistenza • Dienstverlening • Serwis Servis • Szerviz • Сервисная служба

Name • Nom • Nome • Naam • Nazwa • Jméno •
Názov • Név • Denumire • Isim • Название

Kommode

Nr. • No. • N° • Номер • Č • Sz

0434_11

Typ • Type • Tip • Típus • Тíро • Тип

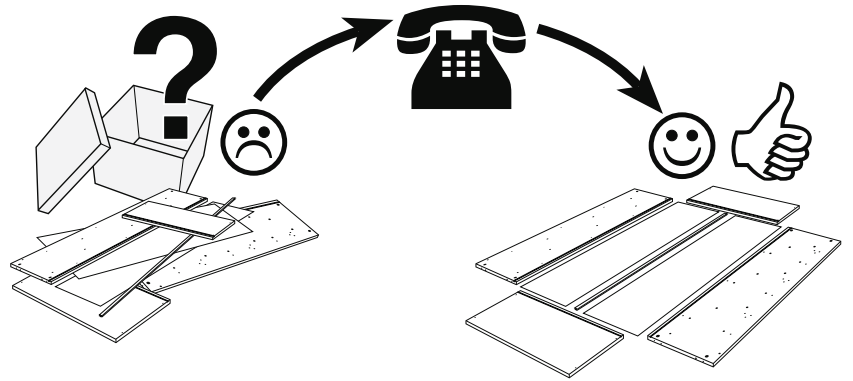
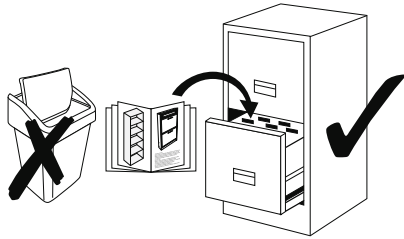

1-10 4x		1-33 16x		1-80 8x		1-90 4x		1-140 4x		1-200 6x	
1-330 2x		2-10 12x		2-20 12x		2-160 8x		3-11 3x		3-41 3x	
3-81 1x		3-82 1x		3-130 4x		5-130 1x		5-185 4x		6-328 2x	
8-80 1x											

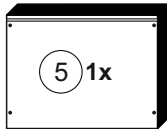
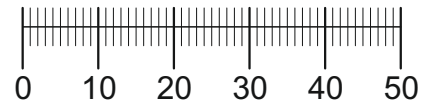

599 x 450

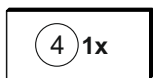

568 x 270

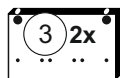

426 x 258

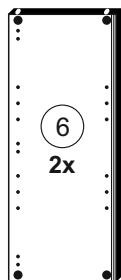

1058 x 426

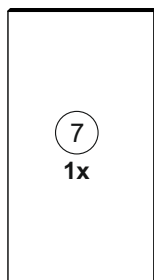

1070 x 580

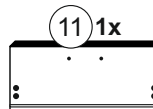

596 x 252

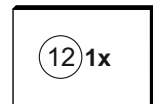

546 x 380

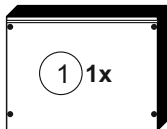

599 x 450



2 4x

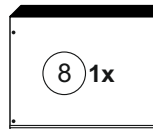

599 x 450



568 x 397

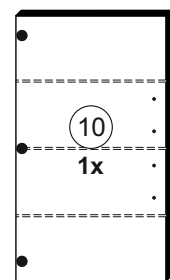

1052 x 596



16) 2x

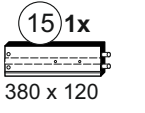

15) 1x

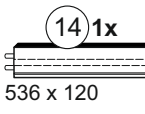

14) 1x

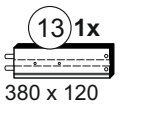

13) 1x

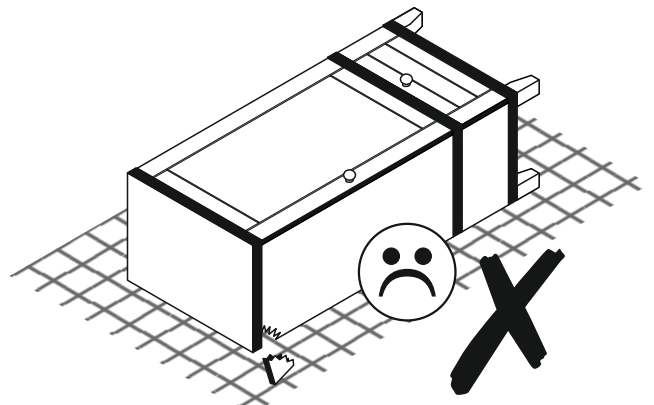
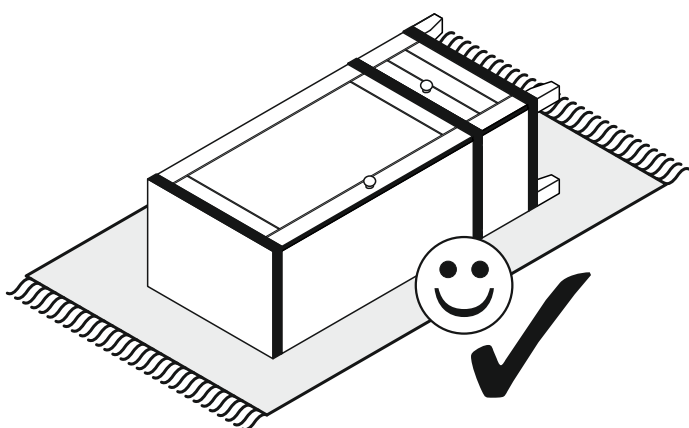

1

1-200		2-10		3
6x	6,3x13	4x		16

2

2-10		2-160		6
8x		8x		

3

1-80		2-20		5
2x	3,5x13	12x		8
3-81		5		
1x		8		
3-82		1x		
1x				

4

1-80		3-41		10
6x	3,5x13	3x	0er	
3-130				
2x				

5

1-140		3-130		11
2x	4x30	2x		12
5-130				13
1x				14
6-328				15
1x				

6

1-10				
4x	6,3x50			

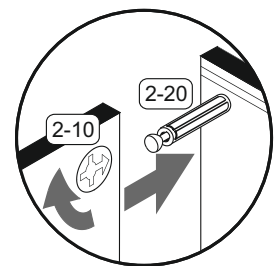

7	1-33		4x17
	16x		
	1-90		3,5x20
	4x		
	5-185		
	4x		

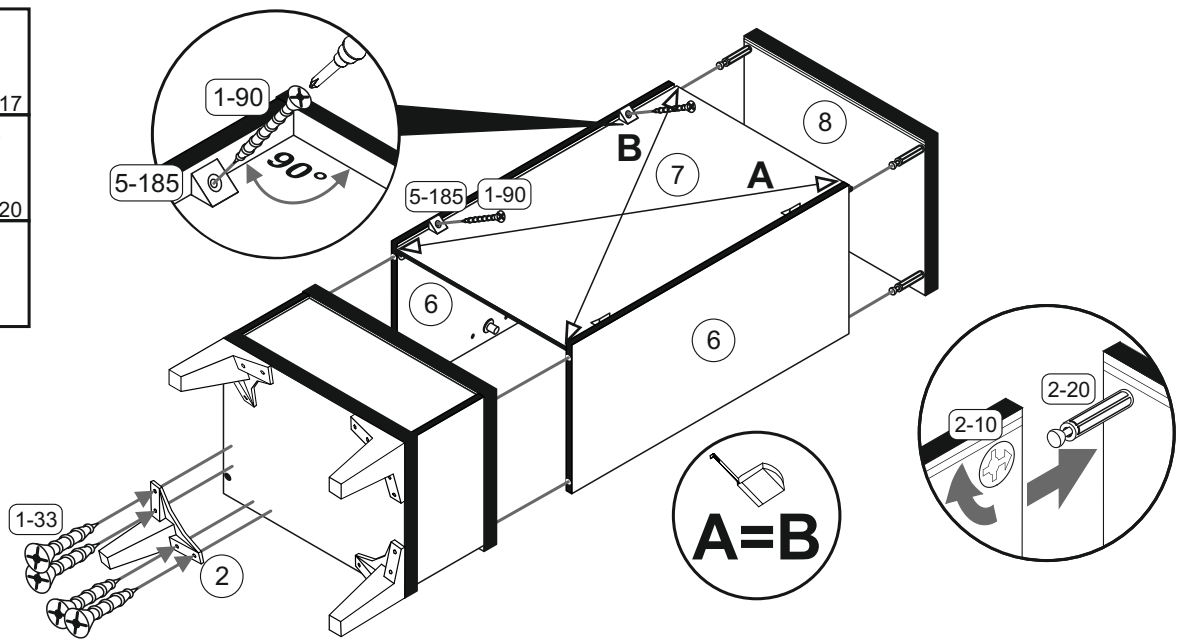

8	1-140		4x30	1-330		2x	M4x10	3-11		3x	6-328		1x	8-80		1x
	2x			2x												

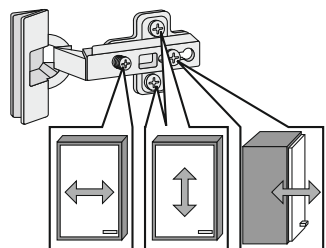
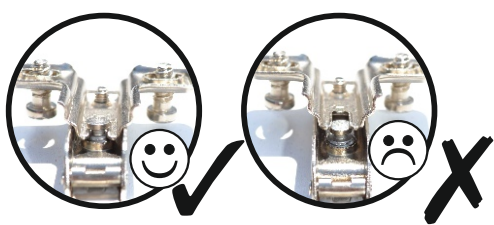
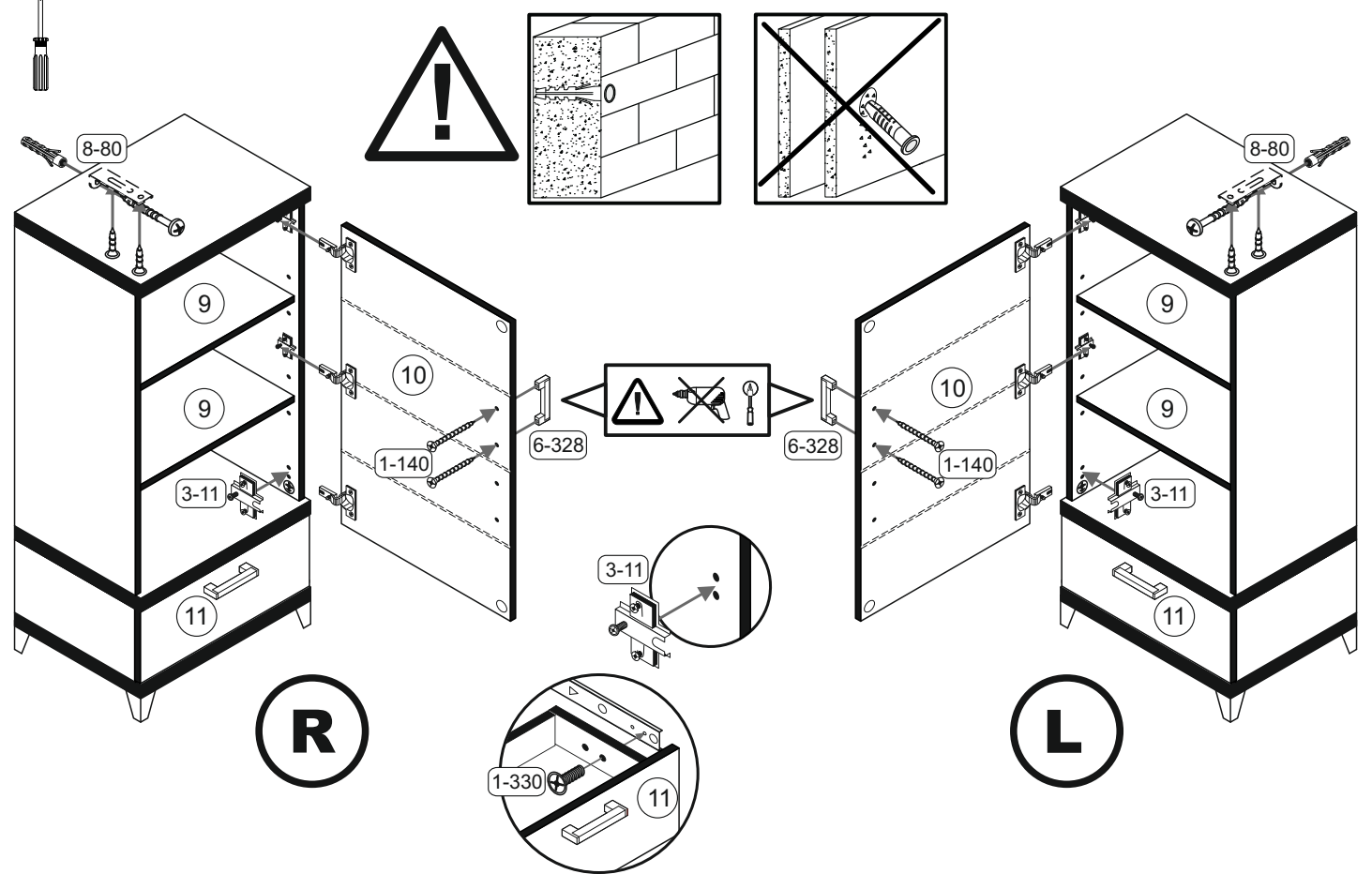

Türen einstellen (Scharniere justieren)
 Adjusting the doors (adjusting the hinges)
Régler les portes (ajuster les charnières)
 Sistemare le porte (regolare le cerniere)
Deuren instellen (scharnieren afstellen)
 Nastawić drzwi (wyregulować zawiasy)
Vyrovnejte dviřka (seřid'ťe zavěsy)
 Nastavenie dverı (nastavenie zavesov)
Allıtsa be az ajtokat (allıtsa be a zsanerokat)
 Reglare uși (ajustare balamale)
Kapıların ayarlanması (mentşelerin seviye ayarı)
 Регулировка дверей (регулировка шарнира)