

NEX1FTC

electric adjustable desk

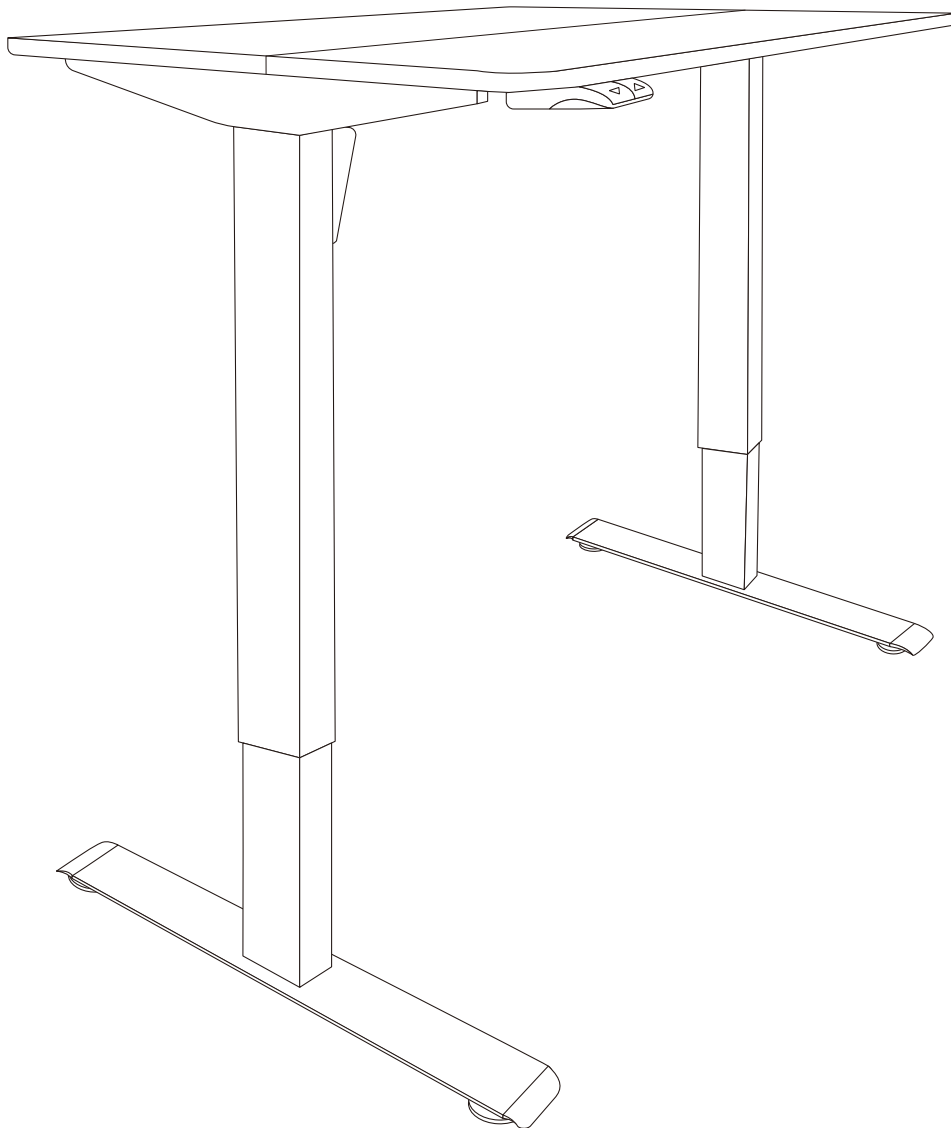

TOOLS

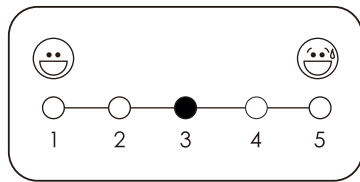
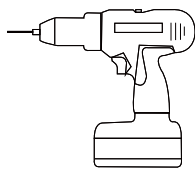
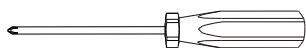

HARDWARE

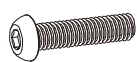

A X 4

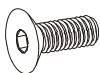

B X 4

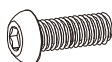

C X 18

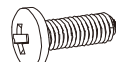

D X 2



E X 2



F X 1

PARTS

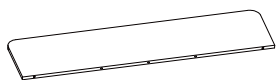

① X 1



② X 1



③ X 5

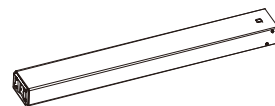

④ X 1

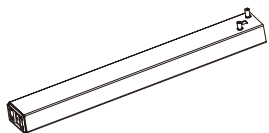

⑤ X 1



⑥ X 1



⑦ X 2



⑧ X 2



⑨ X 1

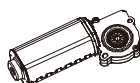

⑩ X 1



⑪ X 1



⑫ X 2

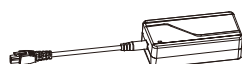

⑬ X 1



⑭ X 1

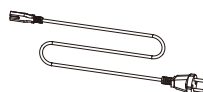

⑮ X 4

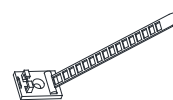

⑯ X 2

1

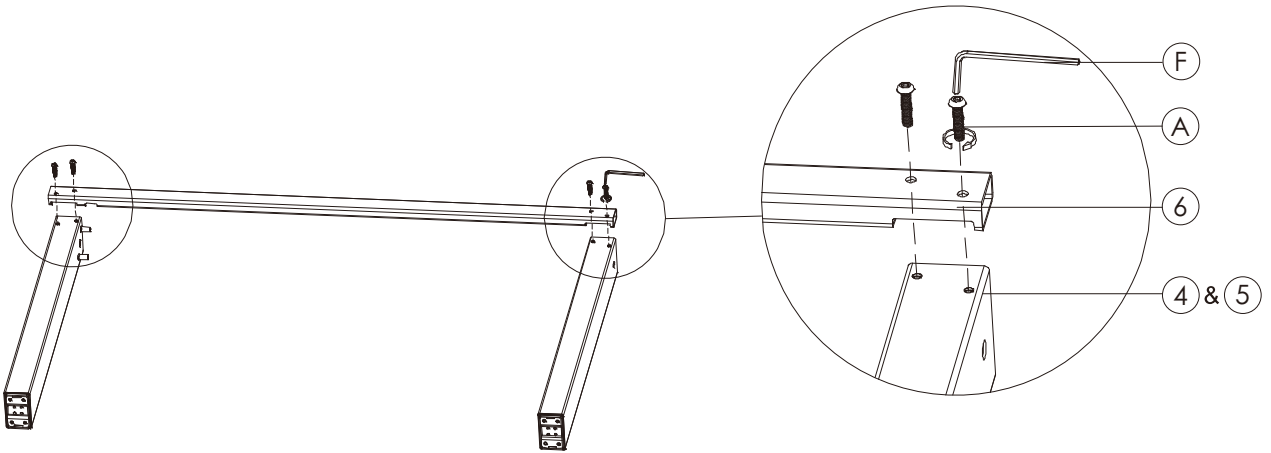

2

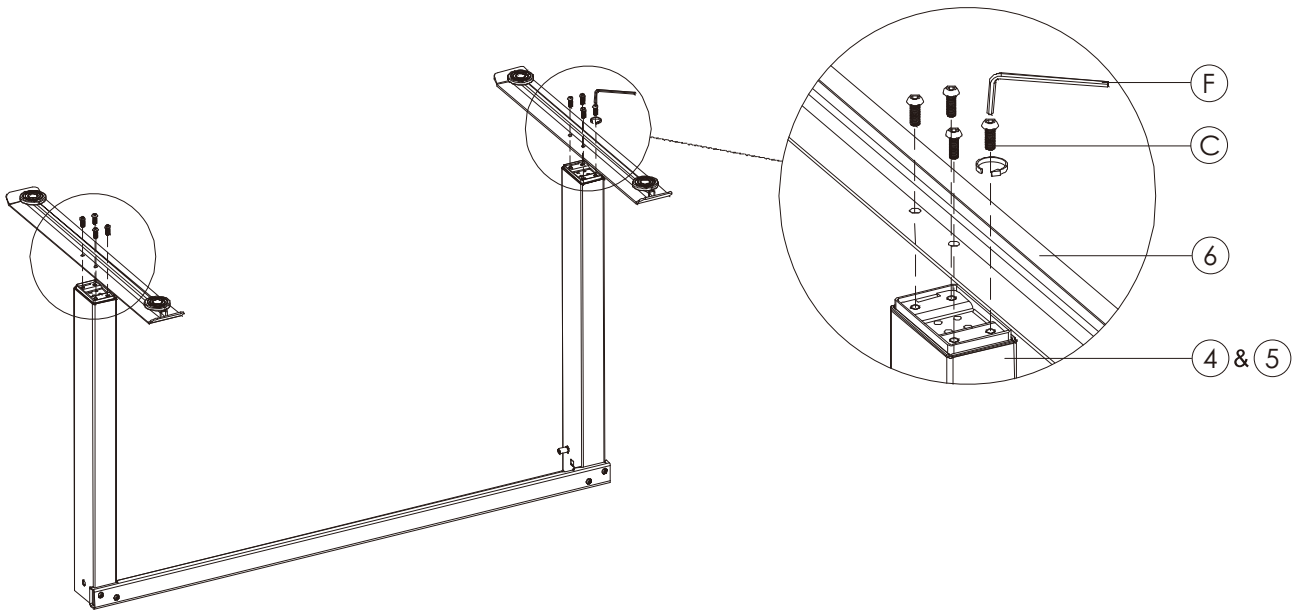

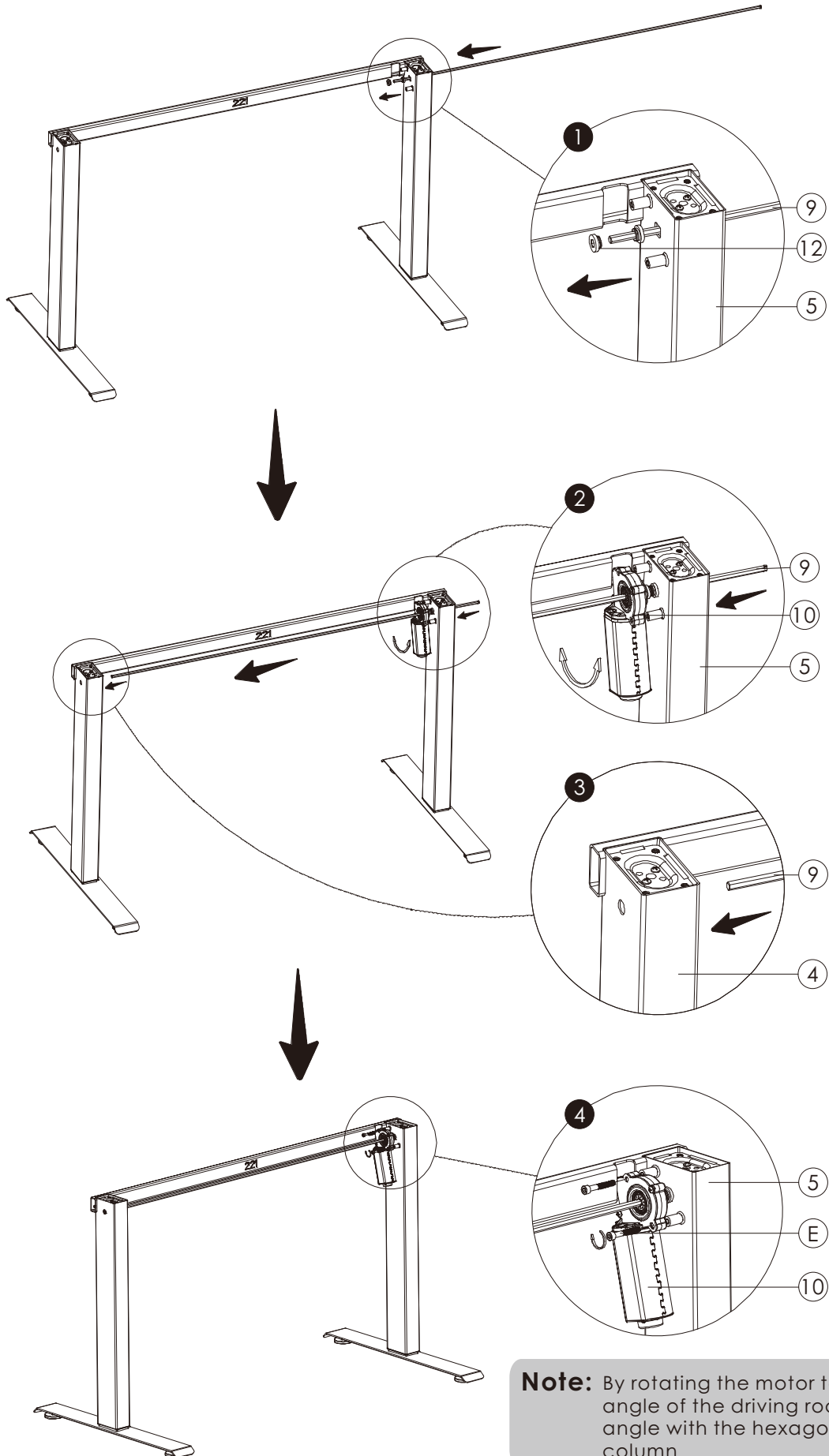

Note: By rotating the motor to adjust the angle of the driving rod, until the same angle with the hexagonal hole on the column

4

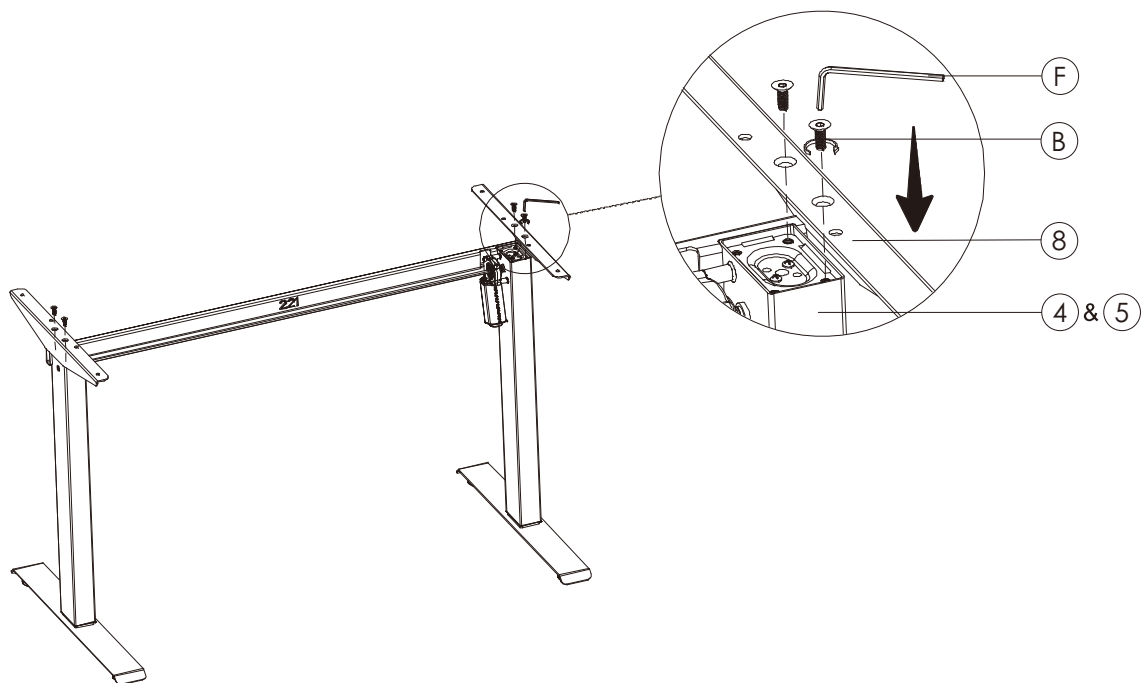

5

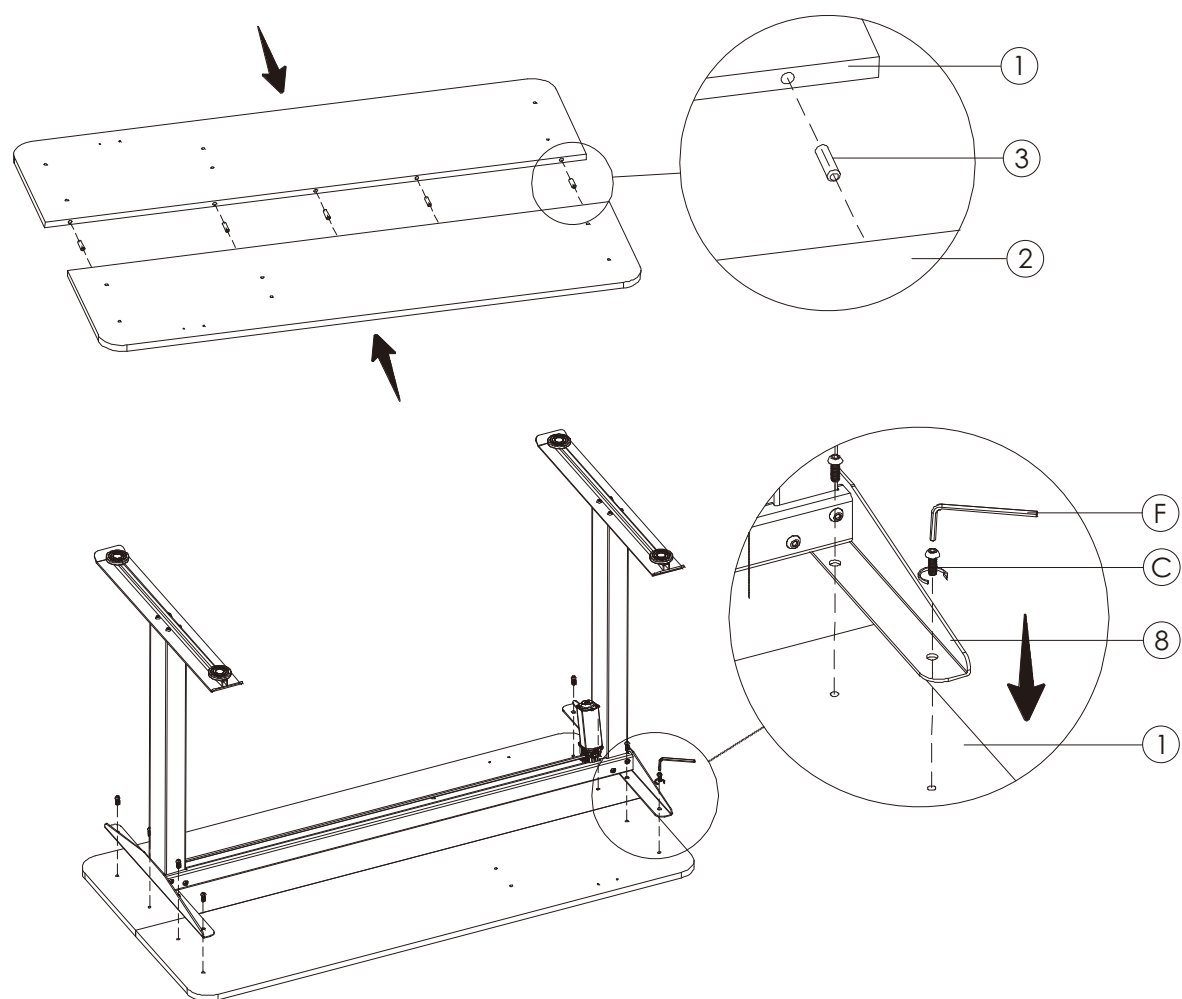

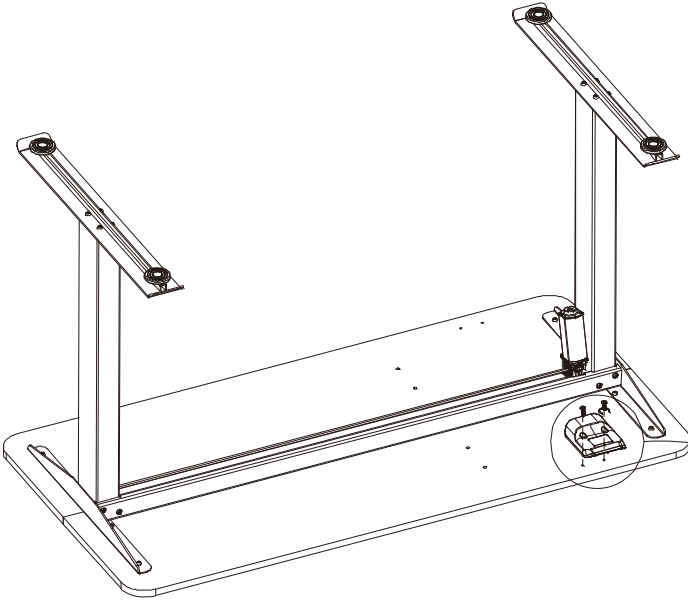
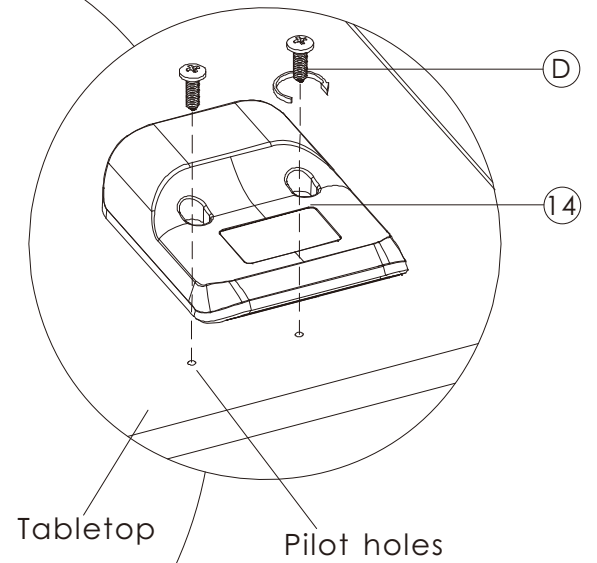
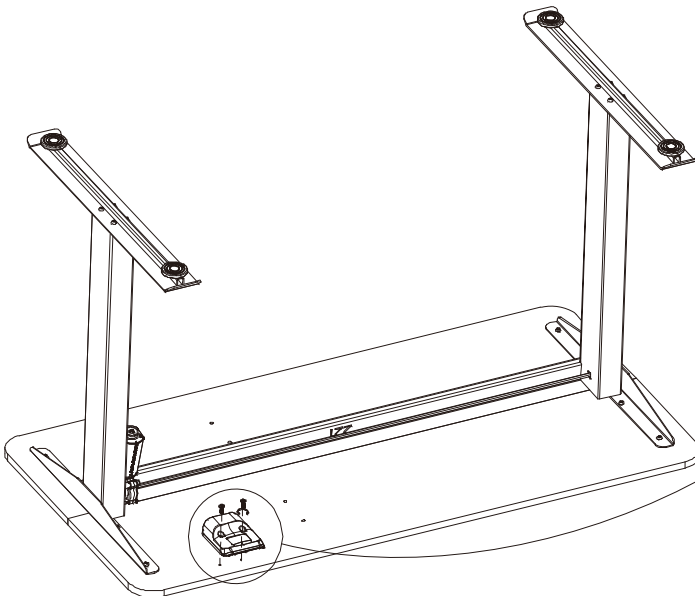
Option 1**Option 2**

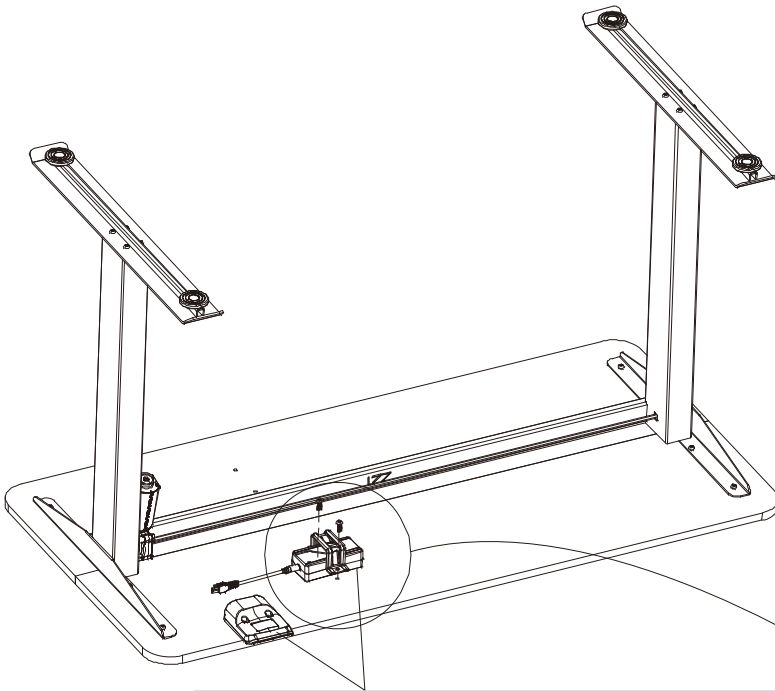
Option 1

Note: Install the adapter and adapter box on the same side as the handset

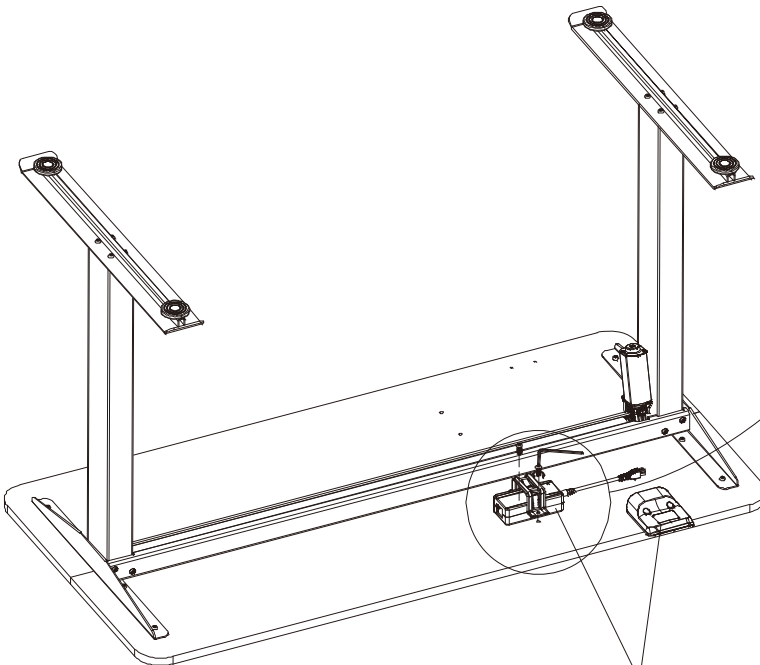
Option 2

Note: Install the adapter and adapter box on the same side as the handset

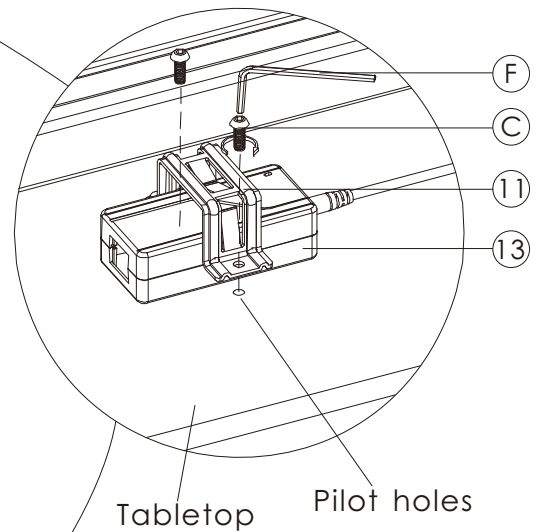

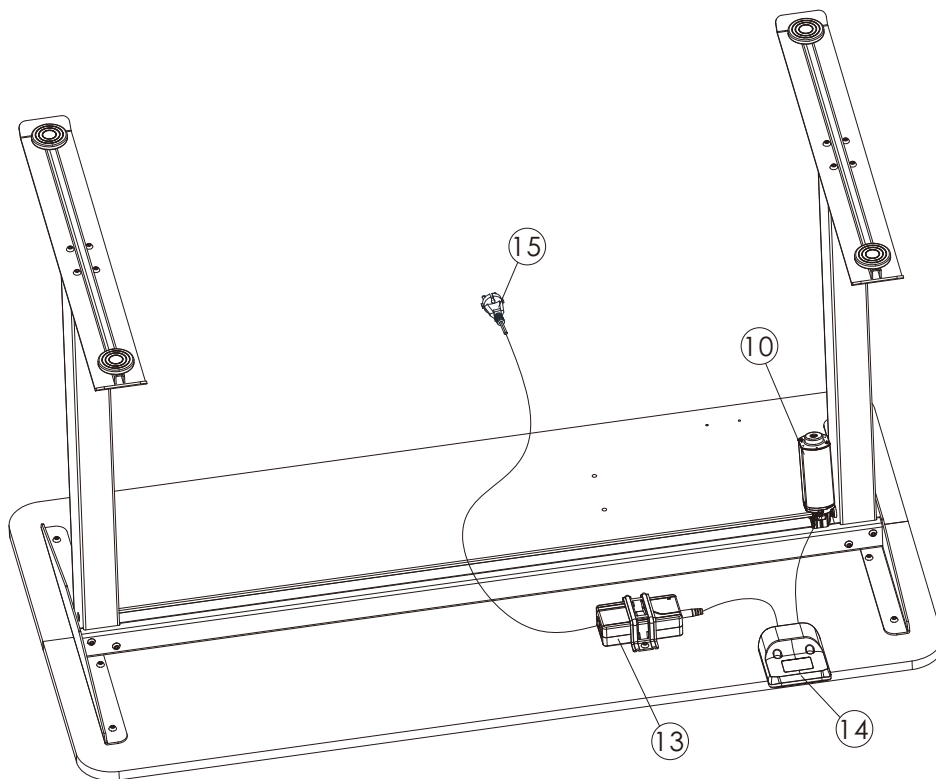
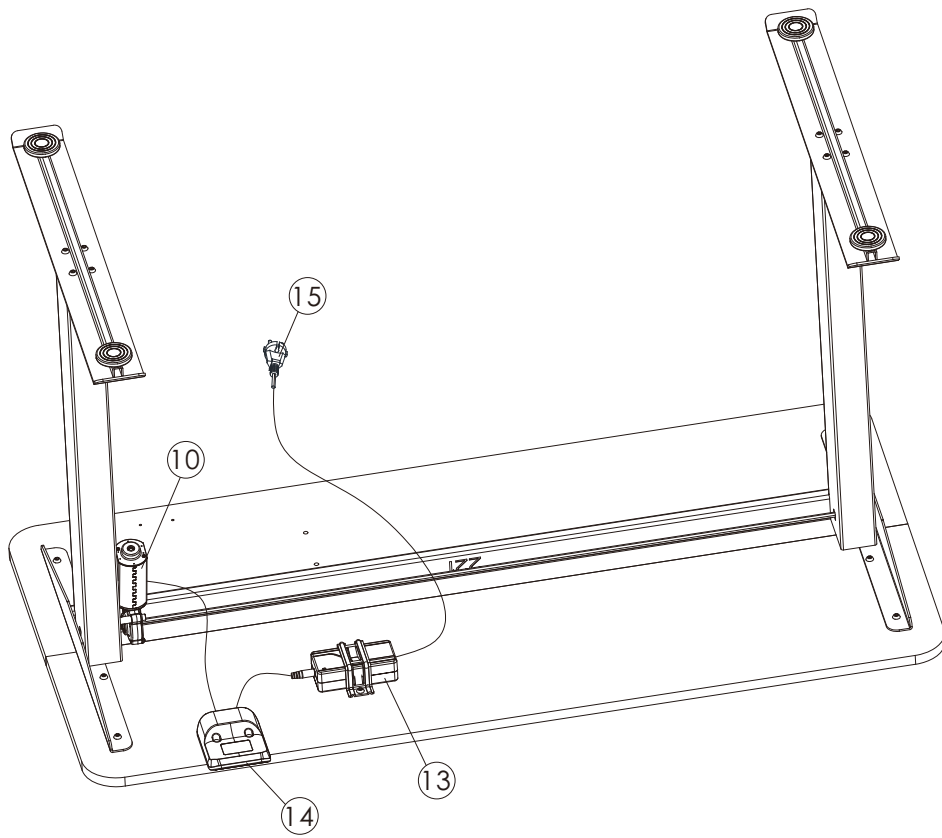

Option 1

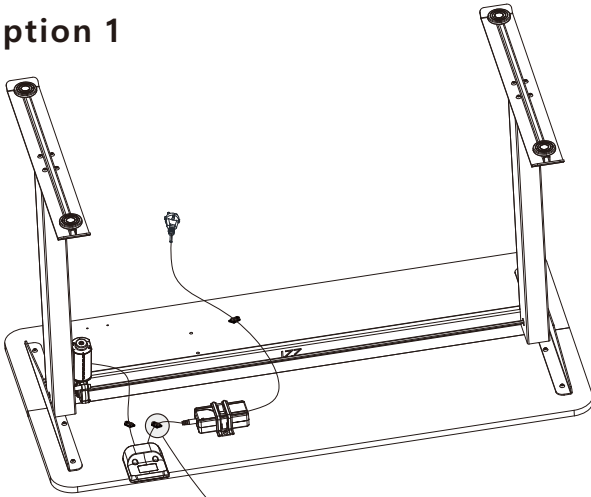

Option 2

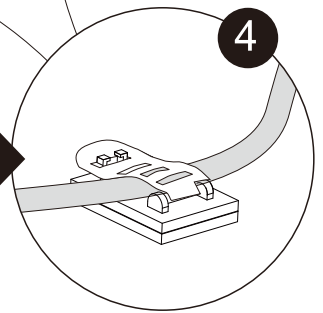
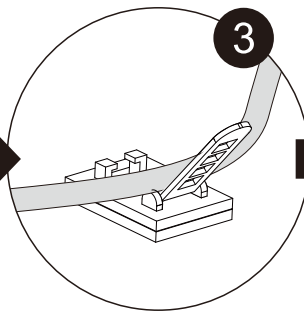
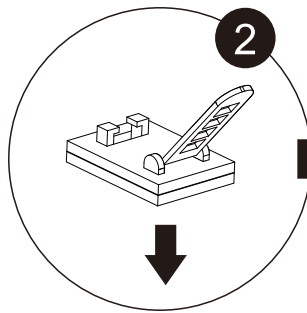
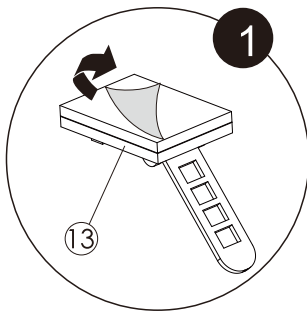
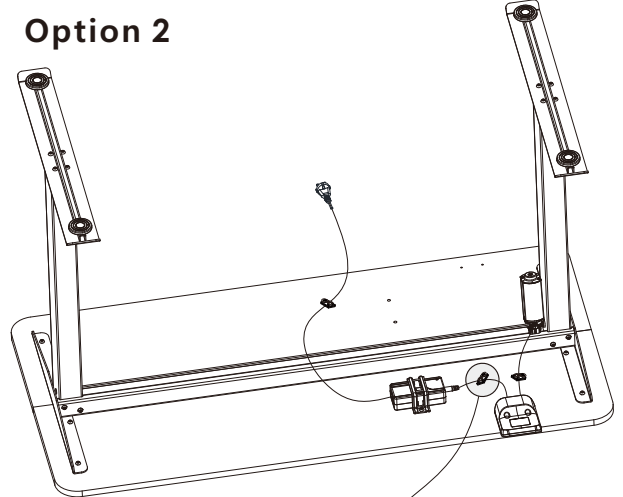

Troubleshooting the NEX1FTC, electric adjustable desk

1. Ensure that the desk is assembled according to the assembly manual provided with the table.
2. If the desk for some reason is not working after the assembly or if the desk stop functioning after some time using, the following steps can be done. The reason for a desk which doesn't function after the assembly is that the electric system needs a reset due to its new home and if the desk stop functioning after some time in use, the reason can be power variation in the main power supply which can result in that the electric system in the desk is reacting and a relay is released to avoid any permanent system issue.
3. Handset and reset

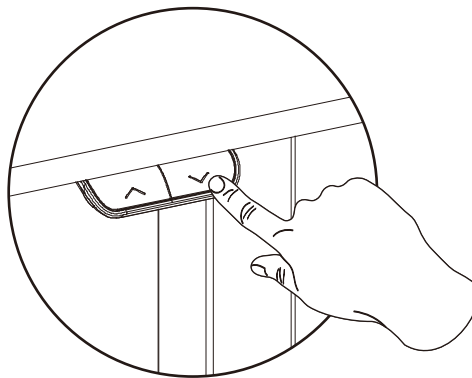

Press and hold the down-button (↓) until the table reaches its lowest position.

Press and hold and do not release the pressure on the button until the table reach its lowest position. Once reaching the lowest position, the table will self-adjust.

Self-adjust will appear in the following way: the table will reduce a few millimeters, (1-3mm) down and then adjust a few millimeters up.

The table is now reset and the use of up and down (↑/↓) can continue like normal.

4. If the rest process doesn't function, the following second step shall be done:

Disconnect the power cable from the main power supply.



Wait 18mins with the power cable disconnected.

When the power cable has been disconnected for about 18mins, connect the power cord to the main power supply.

BEFORE the table is used, repeat the reset process as described in step 3.

5. If step 3 is not working, step 4+3 is not working - check the transformer/adapter. The indicator on the transformer shall indicate green light. Green light = the main power is connected to the desk. If no green light, connect the desk to another main supply socket. Still no green light – contact your store to receive further instructions.

CARE INSTRUCTIONS

In order to maintain the product from dirt or marks, use a cloth with mild soap and water. Dry with a soft cloth. This is the only method of guaranteeing that the original appearance is maintained. Other commercially available cleaning agents should not be used.

