

STELLA A/2A/S oldalak 1/9 old.

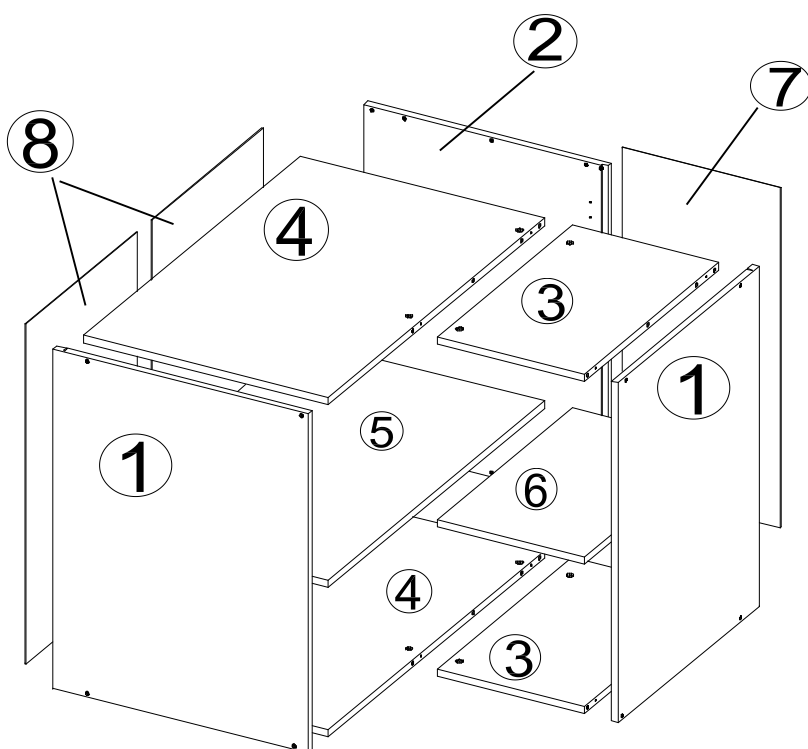

1	720x560	2X
2	720X536	1x
3	323X536	1x
4	860X536	1x
5	860X530	1x
6	330X530	1x
7	720X336	1x
8	720X443	2x
9	717X317	2X

KO 01 8*30

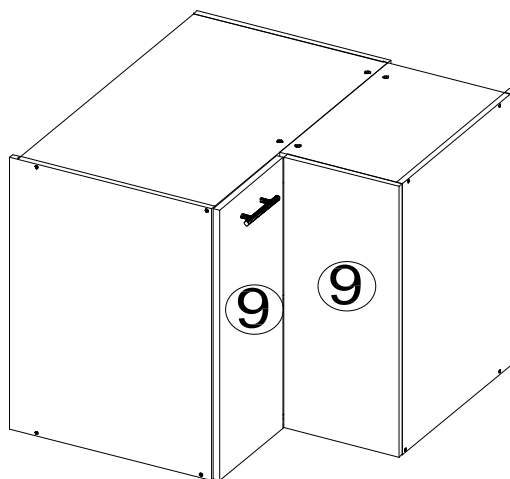
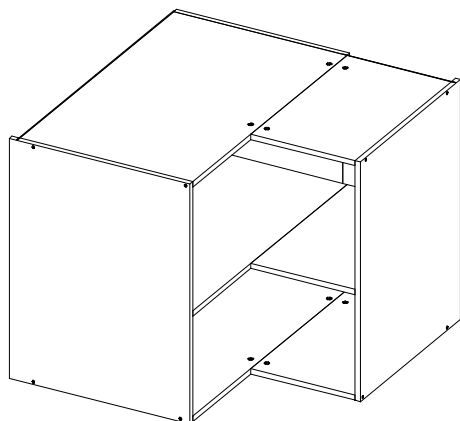
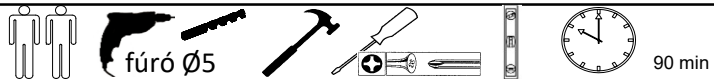

KN 03 7*50



PL 12



PP 01



PN 01

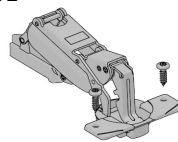

DR 27 3,5*16



DR 25 4*25



KV 01 1,5*20



KL 01 4 mm



PD 01



DD 55



DC01

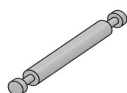

DC02



KT 05

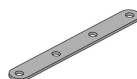

UC11

2X



UC01

4X



1.

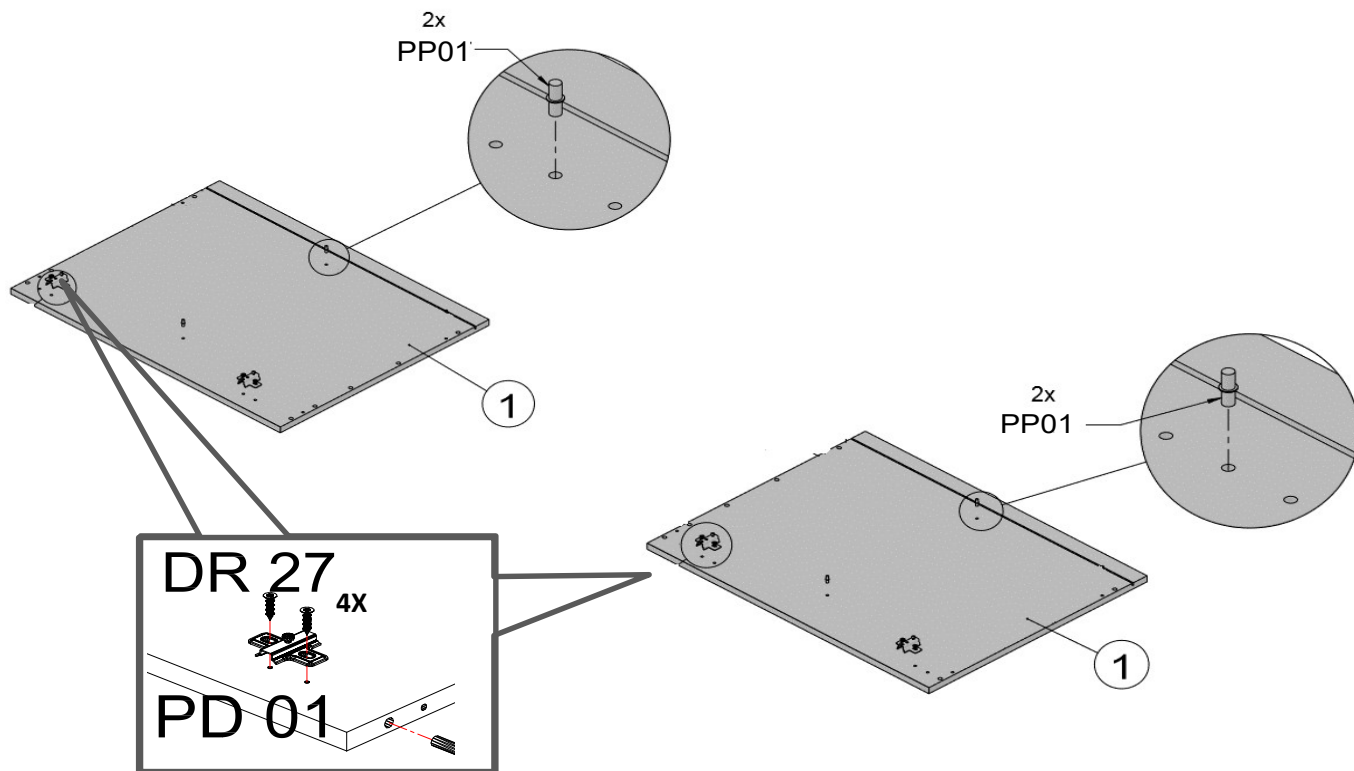

2.

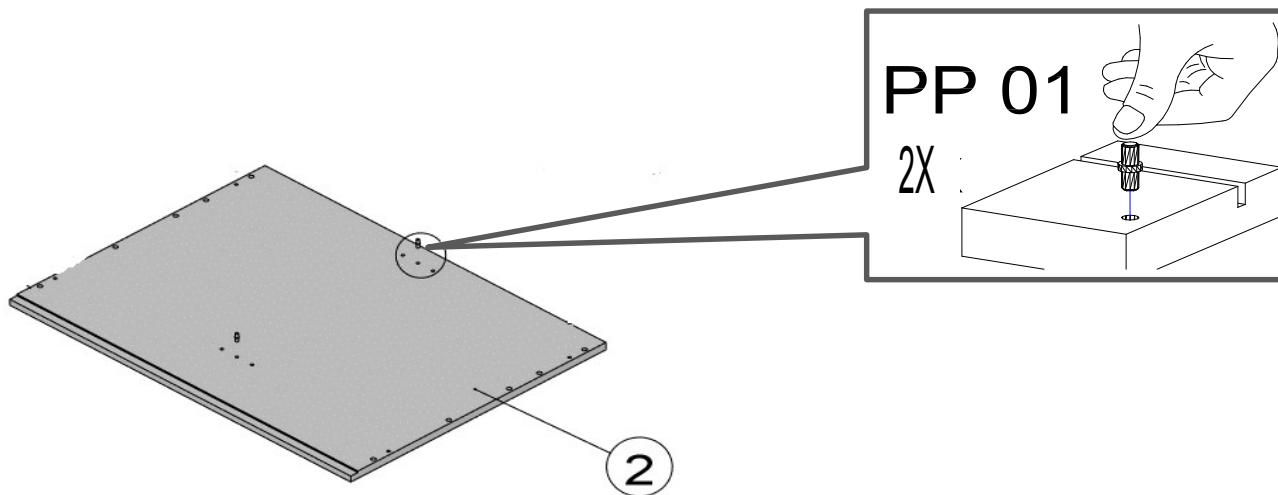

3.

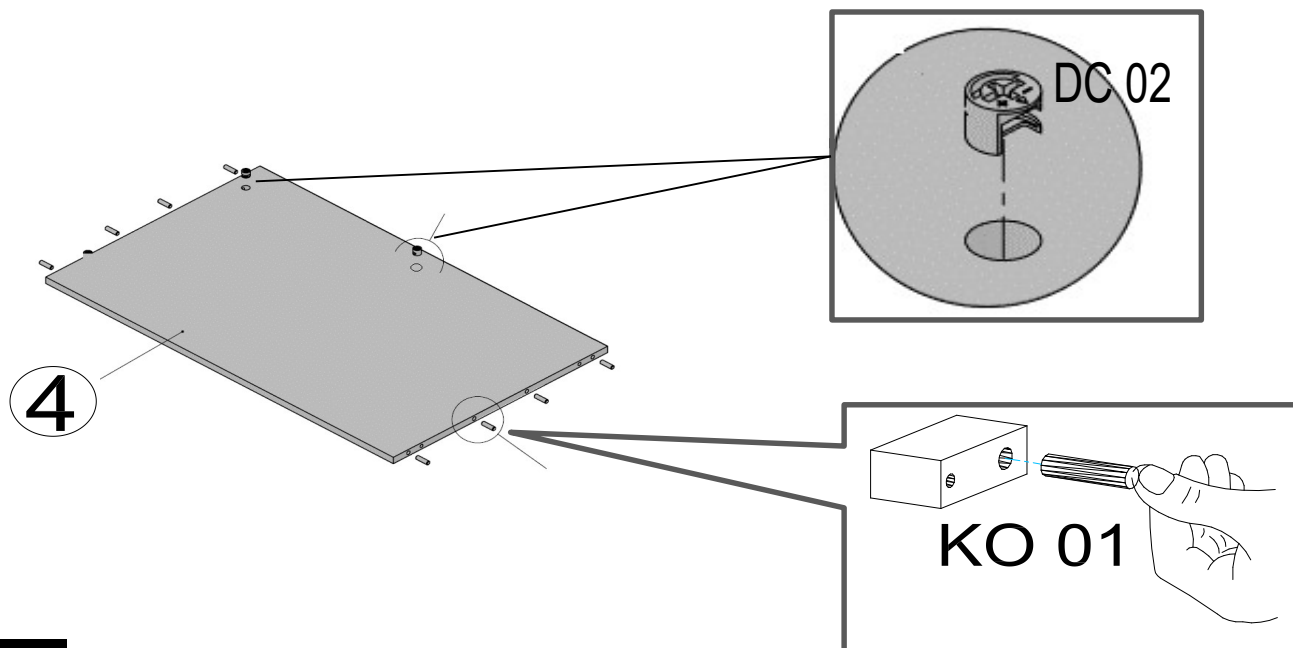

5.

1x

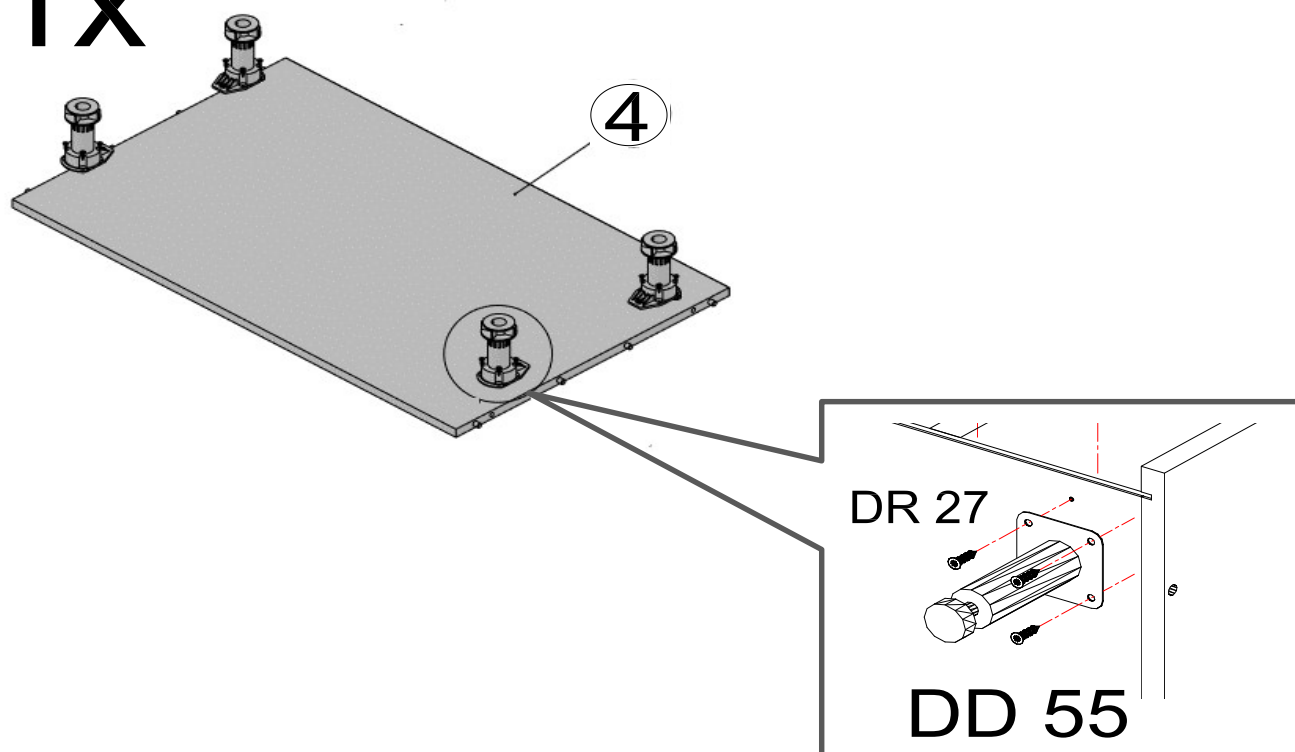

6.

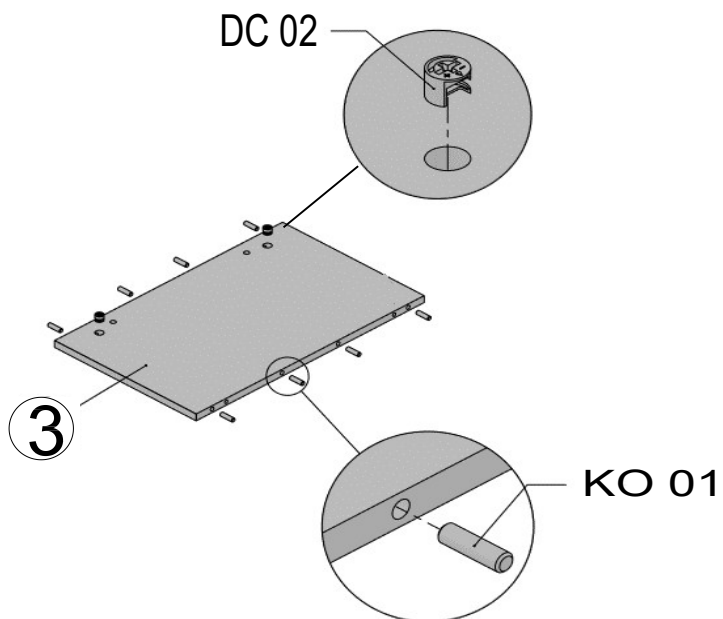

7.

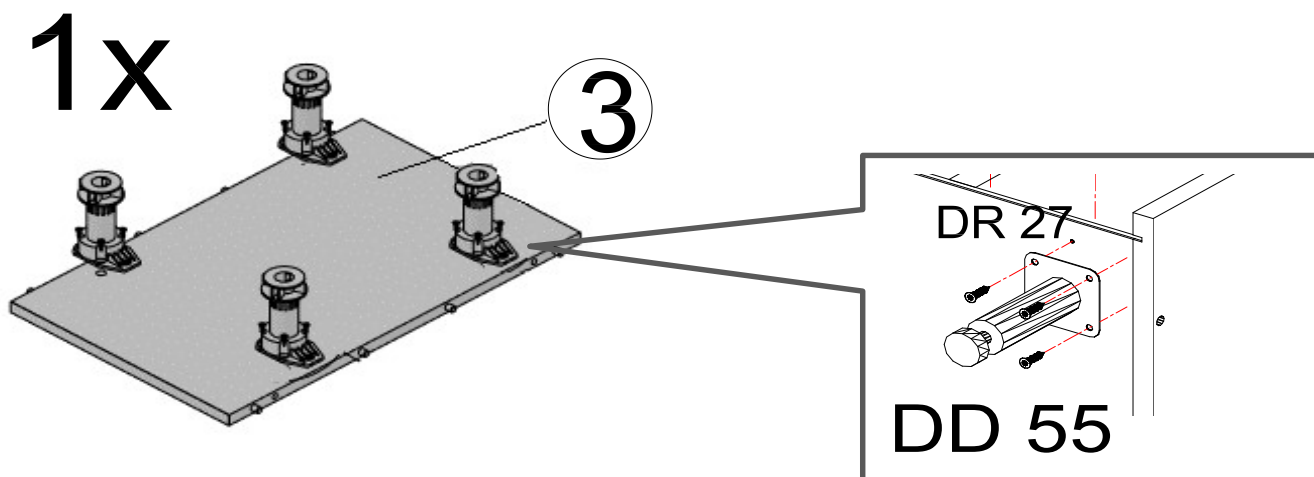

8.

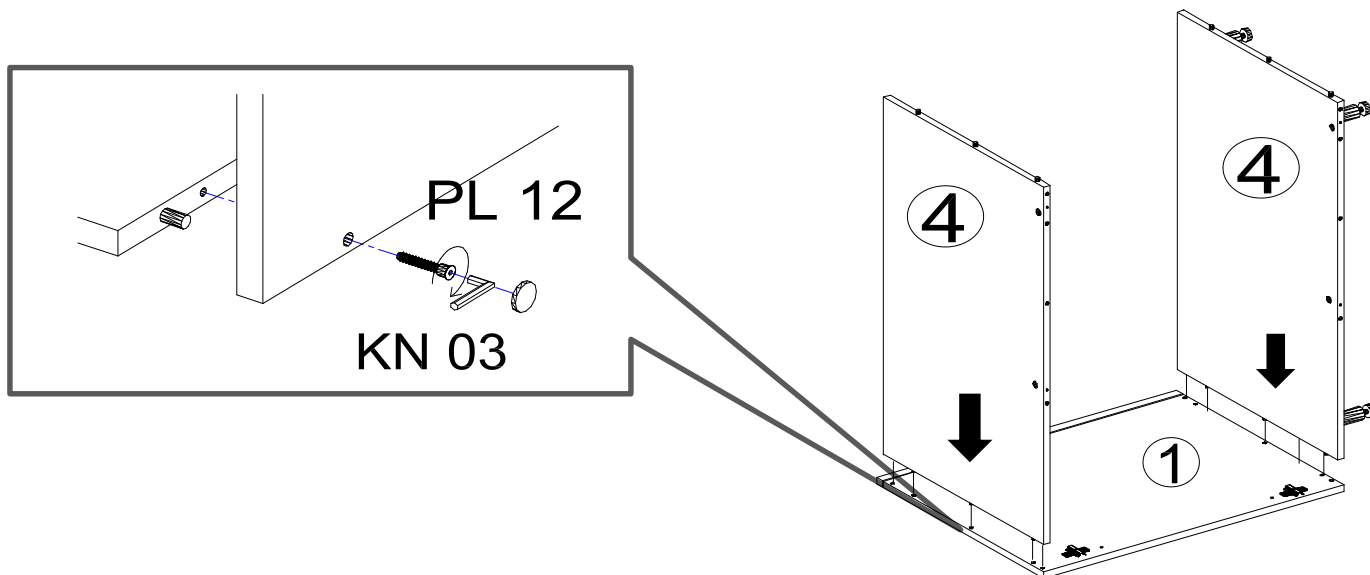

9.

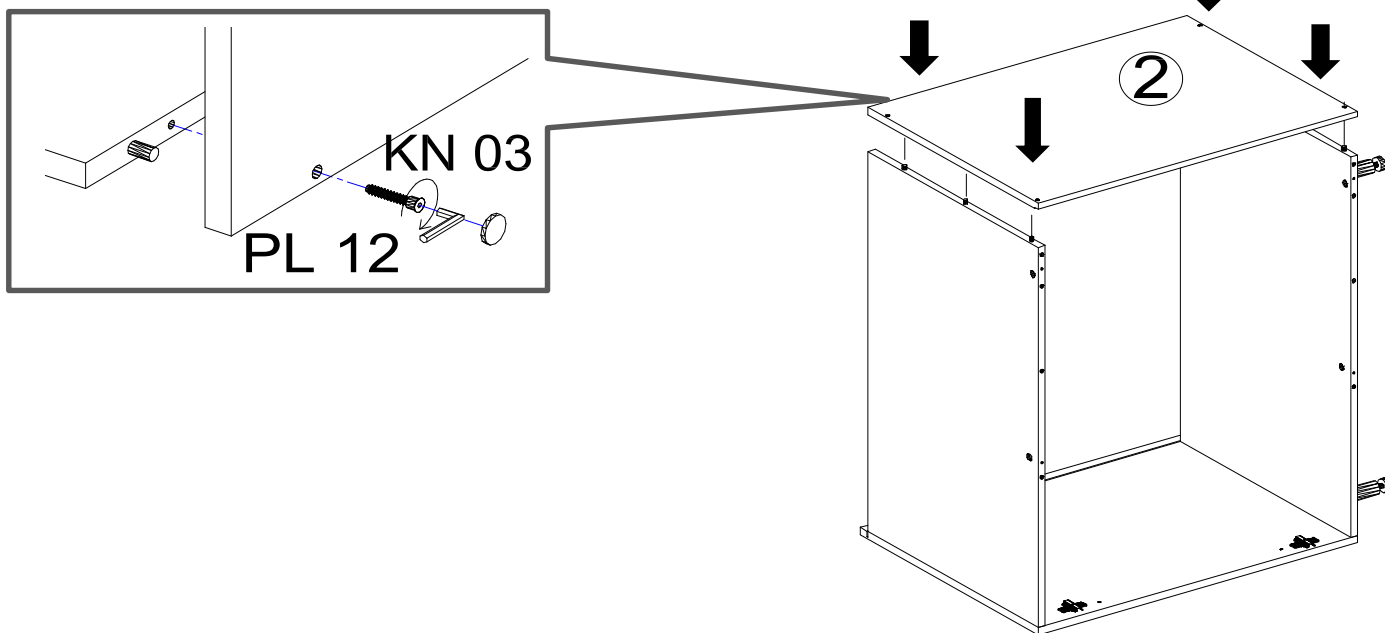

10.

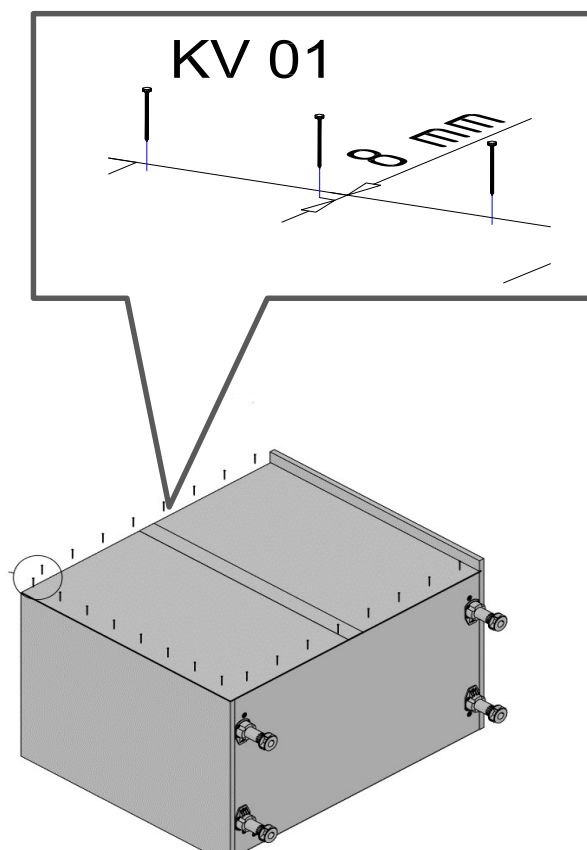
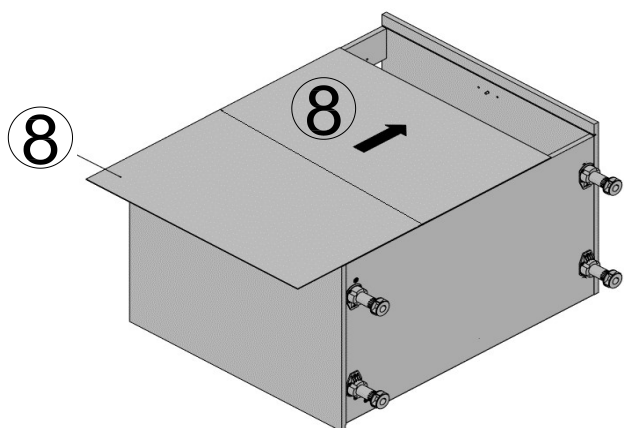

11.

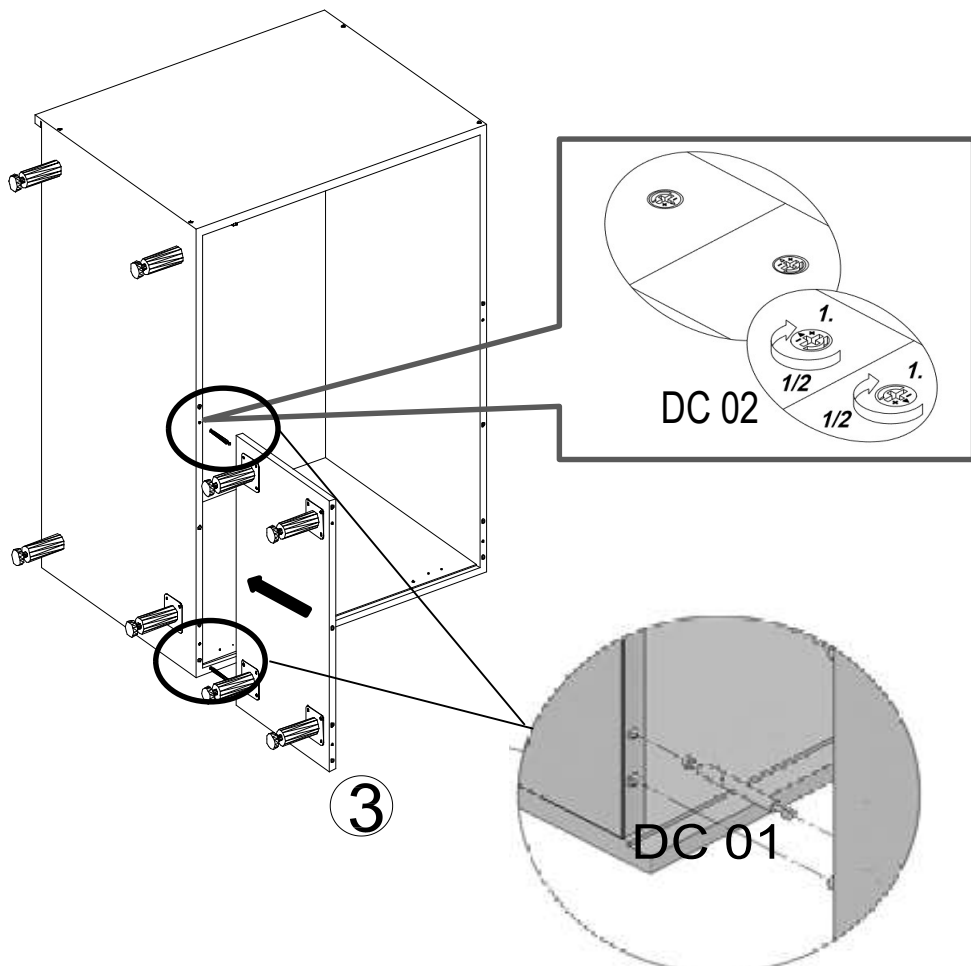

12.

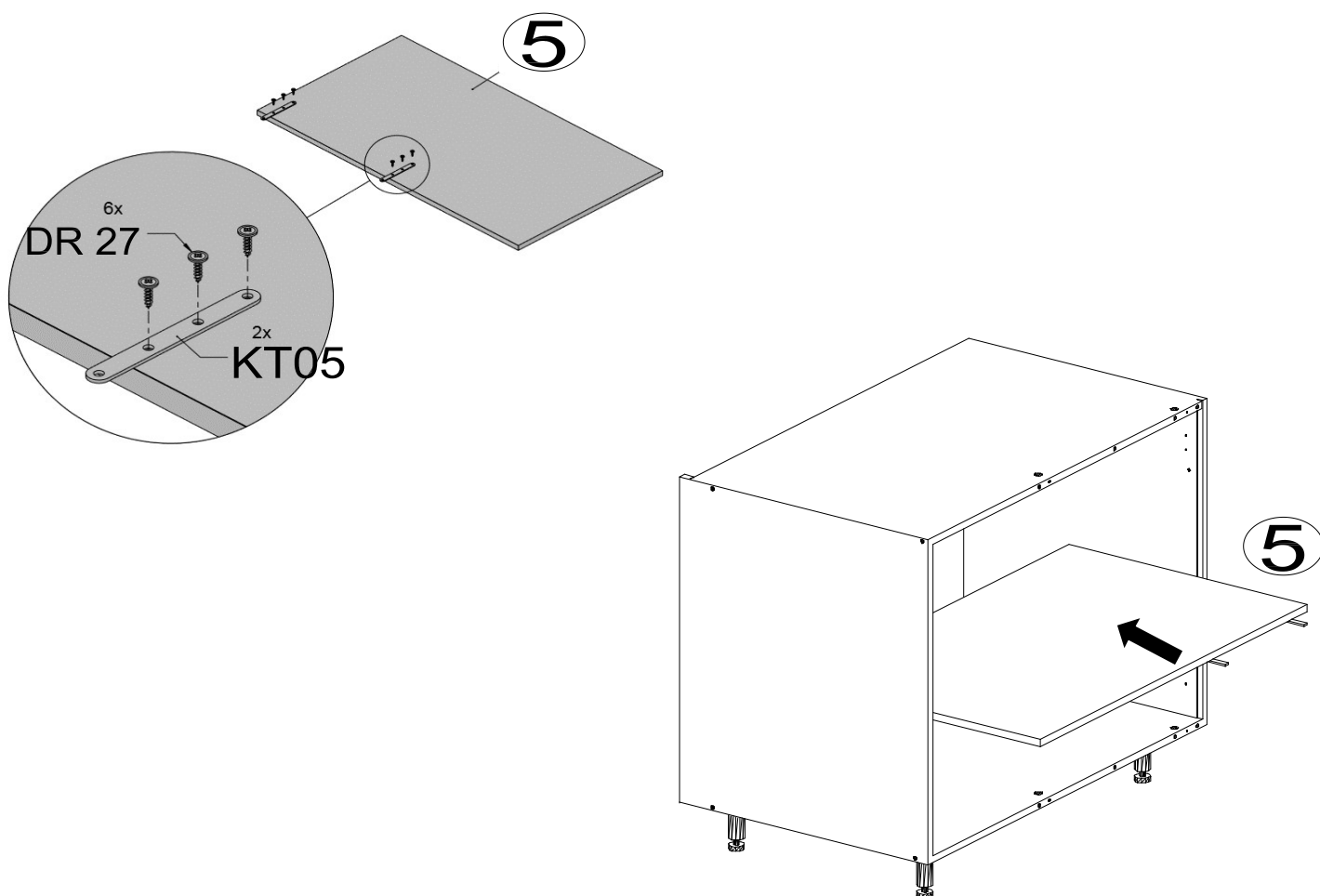

13.

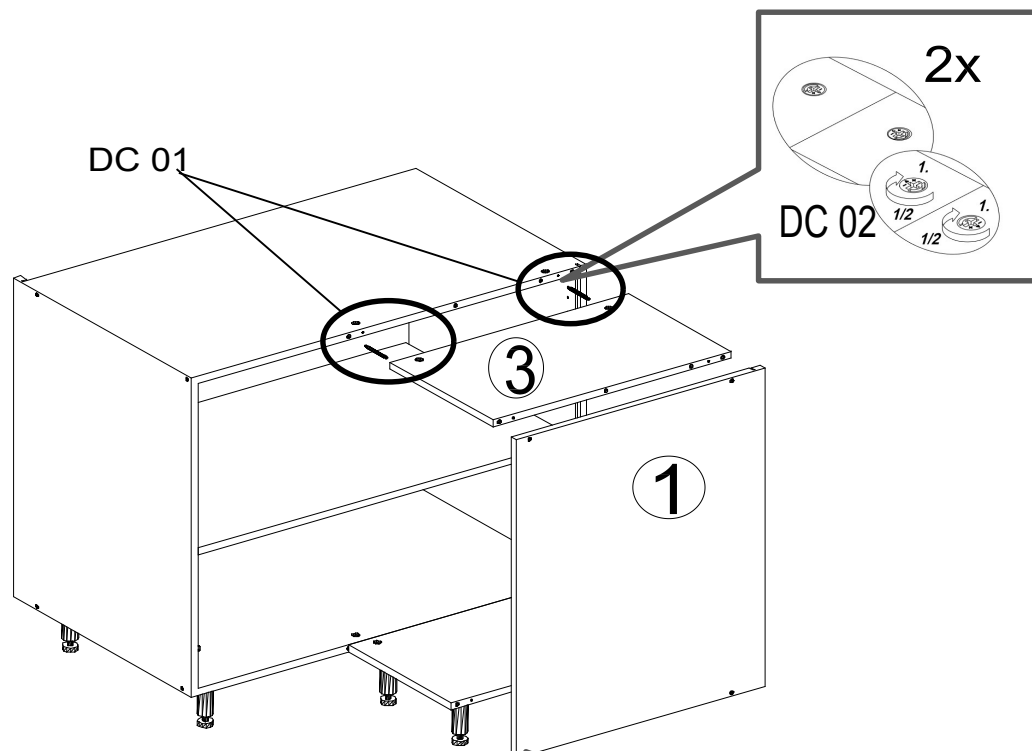

14.

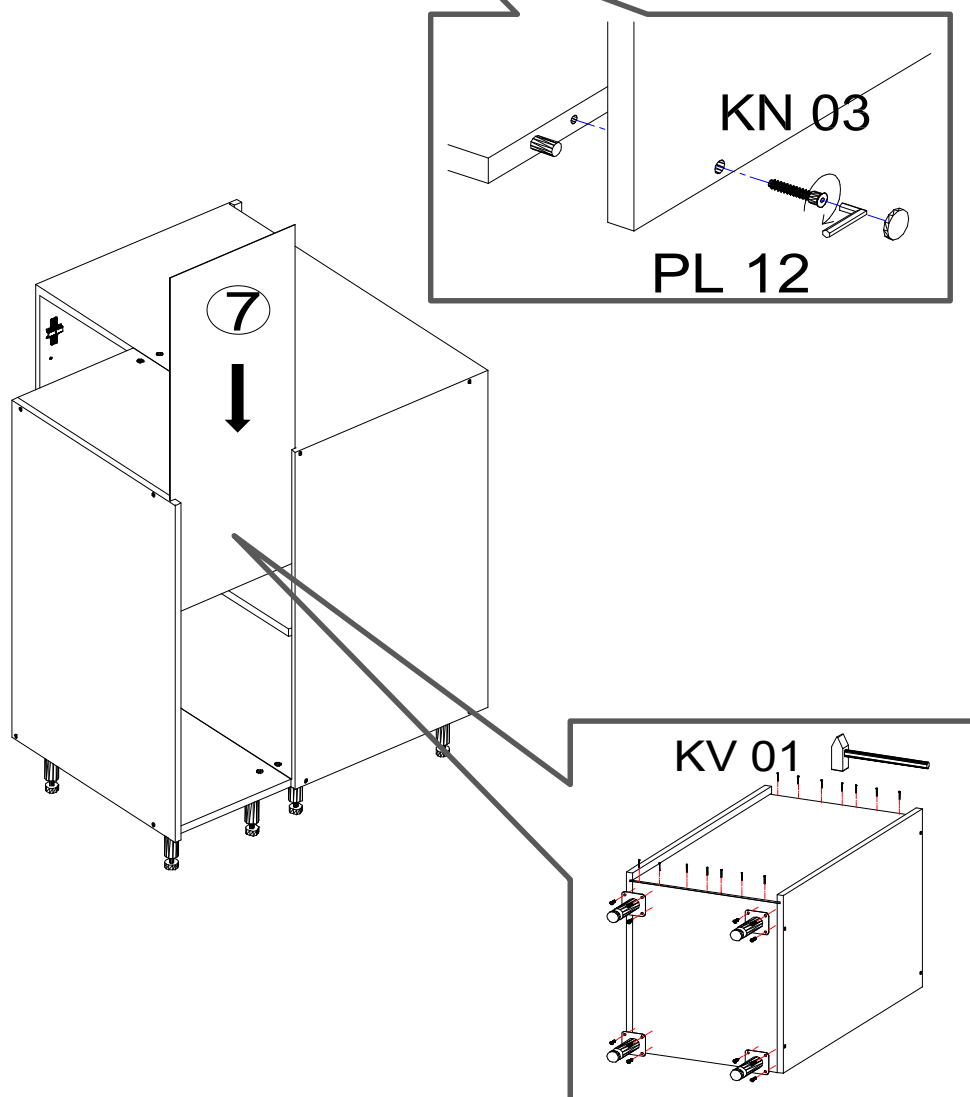

15.

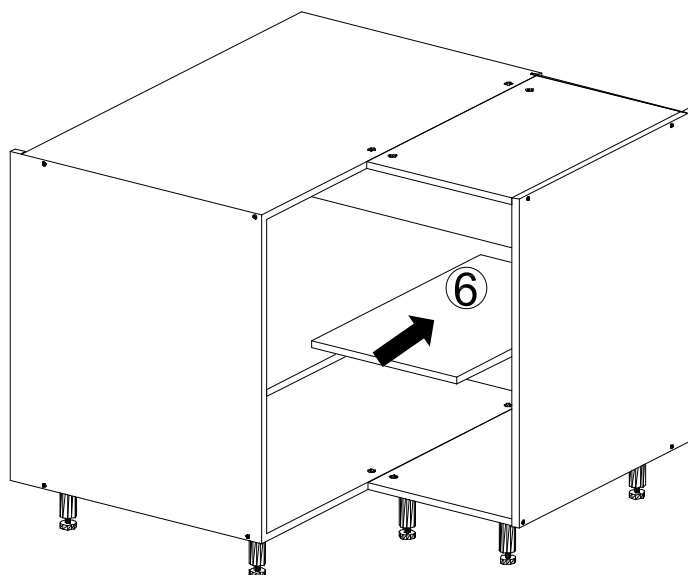

16.

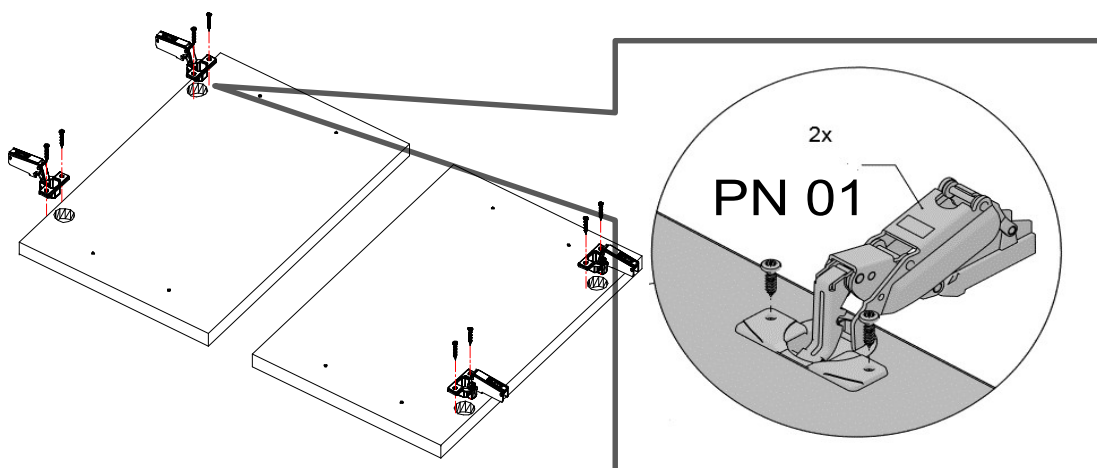

17.

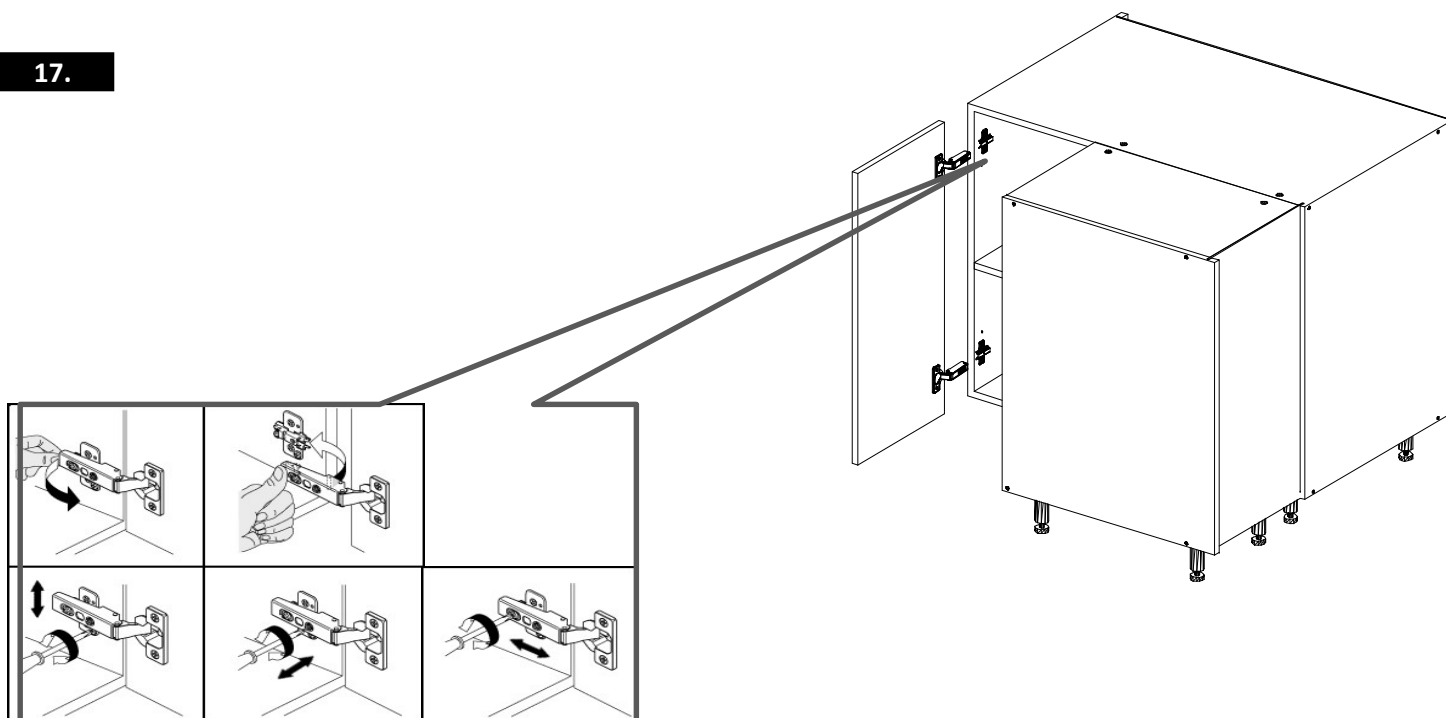

18.

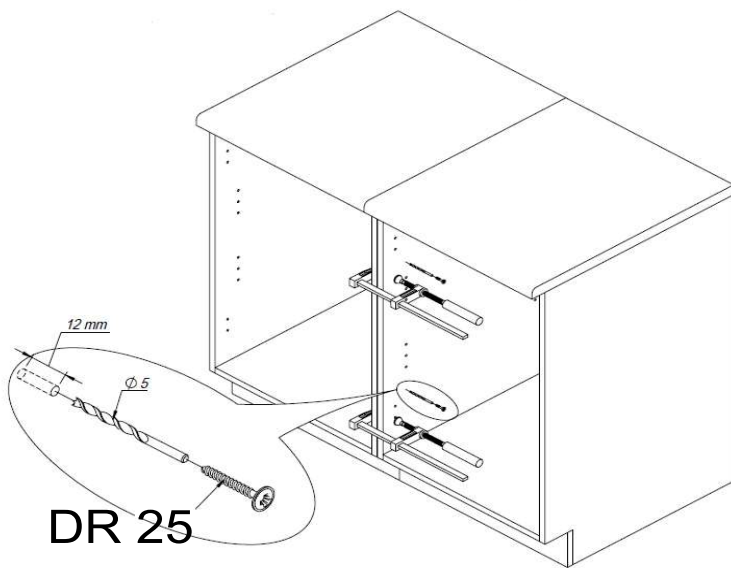
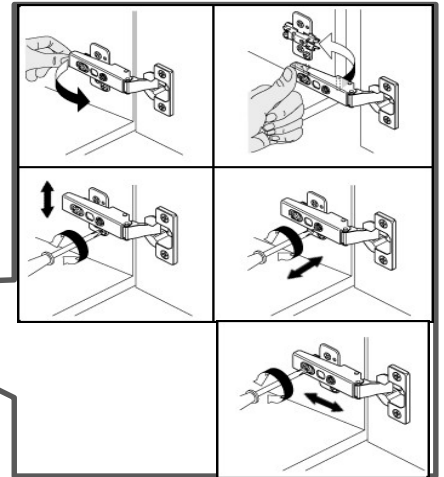
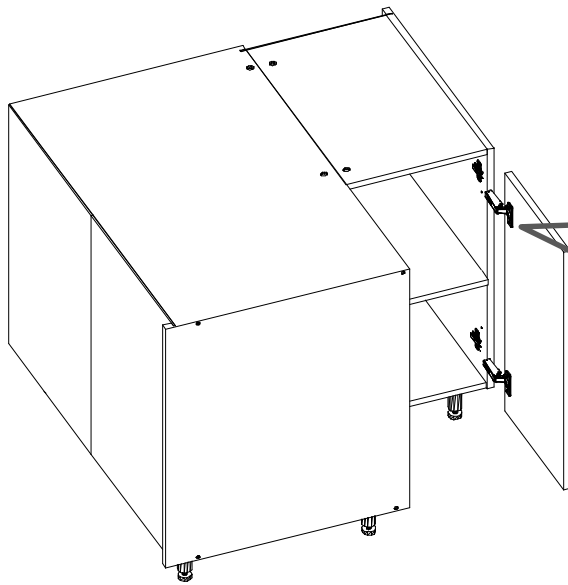

Az elemek megfelelő stabilitása és baleset megelőzés céljából, az elemeket célszerű egymáshoz rögzíteni egy rejtett pozícióban a (DR 25 4*25) facsavarral!