



www.wonderfold.com

WONDERFO/D®

WONDERFOLD®

www.wonderfold.com

W4 Luxe Pro

Quad Stroller



Four Seater

Assembly & Safety Instructions

WARNING

Important—Keep these instructions for future reference.

Avoid Serious Injury To Children From Falling Or Sliding Out:

- Always use the included harnesses to secure each child.
- Ensure the harness is correctly fitted to your child. Adjust the shoulder straps according to your child's size.
- Never leave children unattended.
- Always set parking brake while loading and unloading children.
- This seat unit is not intended for children under 6 months of age.

Avoid Serious Injury To Children:

- Use caution when using stroller near traffic or in highly congested areas.
- DO NOT use the stroller on stairs or escalators.
- Keep children clear when unfolding and folding the stroller.
- DO NOT let your child play with this product.
- DO NOT use the stroller while running, jogging, or skating. The stroller is intended only for up to a brisk walking speed.

Avoid Injury From Stroller Tipping Over:

- DO NOT allow more than 4 children in the stroller at any given time.
- DO NOT exceed the per bench seat limit of 99 lbs. (45 kg).
- The stroller is not intended to carry children taller than 40 inches (101.6 cm).
- DO NOT allow children to climb into stroller unassisted, or to play or hang onto stroller.
- DO NOT overload the stroller as it may cause instability and/or damage to the product.
- Only manufacturer approved parts and accessories should be placed on the stroller.
Non-compliant parts or accessories, such as hanging items or bags, may cause instability.
- DO NOT place more than 11 lbs. (5 kg) in the main cooler section of the rear basket.
- DO NOT place more than 2 lbs. (1 kg) in the bottom mesh section of the rear basket.
- DO NOT place more than 1.1 lbs. (0.5 kg) in each storage pocket.
- ALWAYS distribute weight in the stroller as evenly as possible.

Avoid Loss Of Control Of Stroller:

- ALWAYS ensure that all locking clips, clamps, and buckles are engaged, and all accessories are securely fastened before use.
- NEVER leave stroller unattended on a hill or incline even when parking brake is set.
- ALWAYS use caution when the stroller is on uneven terrain or slopes.
- ALWAYS set parking brake when the stroller is stationary.
- NEVER press down on the handlebar while going over a curb with the stroller wagon.
Lift it using the frame, not the handlebar.

Avoid Pinch Injury:

- Keep fingers or other body parts clear of hinged joints when folding and unfolding the stroller.
- ALWAYS keep children clear from moving parts when making adjustments to the stroller.

See Assembly, Operation and Maintenance & Care sections for additional warning and usage instructions.

Specifications2

Parts Check List.....3

Features..... 4

Assembly

Unfolding the Stroller / Installing & Removing the Front Wheels /
Locking the Front Wheels in a Straight Position5

Installing the Rear Wheels and Brake Set / Installing the Baseboard.....6

Attaching the Bench Seats / Installing the Rear Basket.....7

Installing the Canopy / Attaching the Optional Pull Strap8

How to...

Secure the Harness / Attach & Remove the Harness.....9

Use the Parking Brake / Adjust the Handlebar Height / Fold the Stroller10

Adjust the Canopy / Store the Canopy11

Use the Drop Down Privacy/Wind Cover / Remove the Front and Rear Walls12

Reverse the Seats for Versatile Seating13

Maintenance & Warranty 14

Specifications

- Certification:** ASTM F833-21
- Seat Capacity:** 4
- Age Group:** 6 months or above
- Wagon Weight with Seats:** 54 lbs. (24.5 kg)
- Weight Capacity:** 300 lbs. (136 kg)
- Bench Weight Limit:** 99 lbs. (45 kg) per bench

Parts Check List



Stroller Body - 1 pc



Rear Wheels - 2 pcs



Front Wheels - 2 pcs



Brake Set - 1 Set



Bench Seat - 2 pcs



Canopy Set - 1 Set



Baseboard - 1 pc



Rear Basket - 1 pc



Optional Strap - 1 pc

Please take the time to make sure that all parts are included. If any parts are missing or broken, or if you need assistance assembling your stroller, please contact us at hello@wonderfold.com



Removable, Raised, & Reclining Seats and a Single Rider Option



All-Terrain XL Wheels with Suspension



Easy to Fold & Unfold



Deep Carriage Design with Mesh Sides for Optimal Ventilation



Removable & Slidable UV Protection Canopy, with Adjustable Canopy Rods



5-Point Safety Harnesses



Adjustable Handlebar with a Faux Leather Cover



Removable Front Wall



Insulated Rear Storage Basket



Front Wheels That Can Swivel or Be Fixed



Removable Rear Wall



Zippered Mesh Panels with Drop Down Privacy/Wind Cover

Assembly

Unfolding the Stroller

1. Unlock the bottom latch.
2. Standing on either side of the stroller, push smoothly outward to unfold the stroller until you hear a click.
3. Flip over the side pocket flaps to the outside on both sides of the stroller to cover the frame joints.



Installing & Removing the Front Wheels

1. Insert the front wheels into the front wheel housing until you hear a click. After attaching the front wheels, pull down on each wheel to confirm that they are securely locked.
2. To remove the front wheels, press the release button and detach the wheel from the leg.

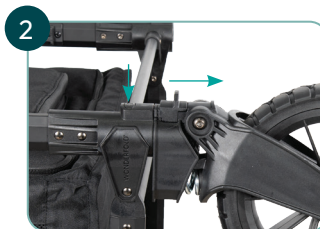

Locking the Front Wheels in a Straight Position

1. Turn the wheels so they are straight, then slide the tab upwards to lock in place.
2. To unlock, slide the tab downwards.

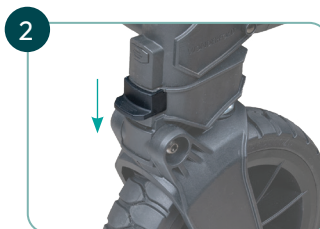
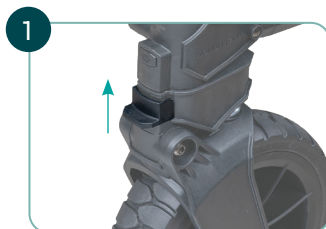

Installing the Rear Wheels and Brake Set

1. Insert the wheel axle in the brake assembly. Pull on the wheel to confirm that it is secure.
2. Insert the brake set into the rear wheel housing until you hear a click.
3. To remove the brake set, press the release button on each side of the wagon frame and detach the brake set.
4. To release the rear wheels, press the release button on the inside of the brake set and pull the wheel out.

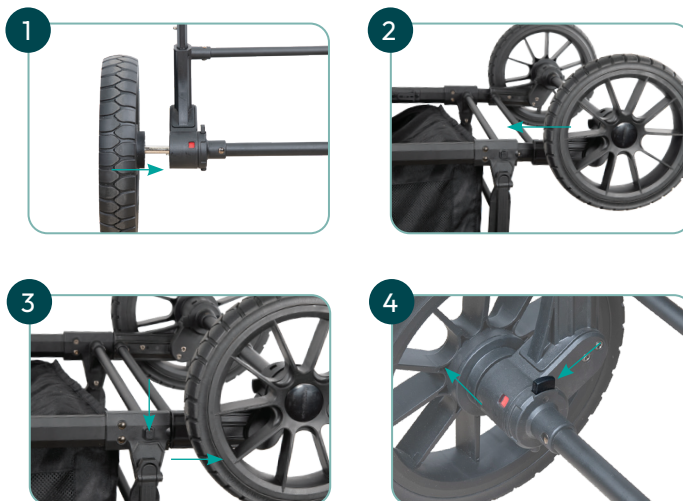

Installing the Baseboard

1. Place the baseboard into the base of the carriage fabric nestled against the frame.
2. Press the baseboard with your hands to level and secure it in place.



Attaching the Bench Seats (Seat is not suitable for children under 6 months.)

1. Before placing the seat in the wagon, unbuckle the buckles on the underside of the seat. Allow the buckles and straps to hang loose until step 3.
2. Place the seat into one end of the stroller and secure the clips on both sides of the seat onto the stroller frame hand rail.
3. Then secure the clip on the back of the seat onto the upper tube of the stroller frame.
4. Completed seat assembly shown in figure 4.
5. For reclining mode, remove the seat and reposition the side clips further forward.



Installing the Rear Basket

1. Slide the basket hooks into the fixed slots on the frames under the handlebar tube.
2. Gently wiggle the basket to level it. Completed assembly shown in figure 2.
3. The basket may also be installed in front of the wagon. Completed assembly shown in figure 3.



Note: DO NOT place more than 11 lbs. (5 kg) in the main cooler section of the rear basket or more than 2 lbs. (1 kg) in the bottom mesh section of the rear basket.

Installing the Canopy

1. Before assembling the canopy, make sure all four plastic clamps at the corners are open.
2. Insert the canopy tubes through the piping of the canopy fabric.
3. Insert the canopy poles into the frame slots on all four corners at the desired height.
4. Close all four plastic clamps to secure the canopy height.



Latch should be opened away from the center of the wagon



Latch should be pressed towards the center of the wagon to close

Note: Latches may require extra force to close or open.

Attaching the Optional Pull Strap

1. Locate the handle strap in the front pocket.
2. Loop the end with the metal clip around the front bottom crossbar. Insert top portion of the strap through the slit in the metal clip.
3. Use as shown in figure 3.



How to...

Secure the Harness

1. With harness unbuckled, place child in seat.
2. Combine the waist and shoulder pieces together by sliding the shoulder end piece into the waist clip.
3. Snap buckle tongues into center strap buckle.
4. Secured harness shown.
5. Adjust each strap by pulling on the free end of the strap and move the slide adjuster along strap.

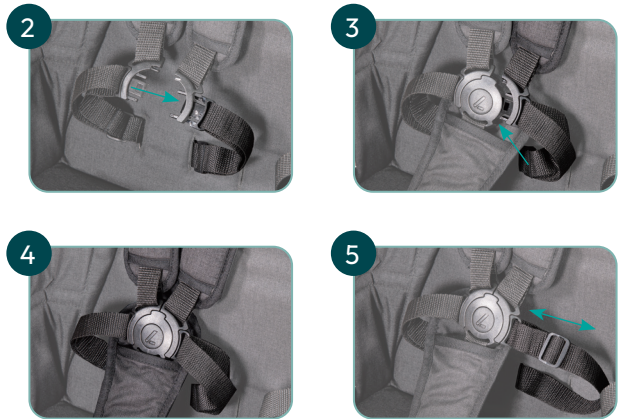
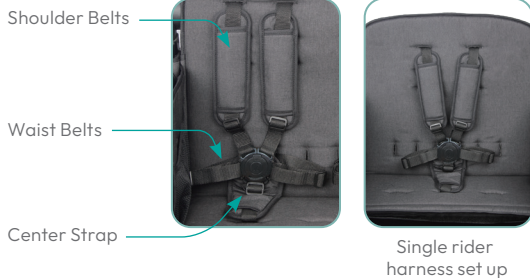

Attach & Remove the Harness

1. Open the Velcro strips on the backside/bottom of the seat to access the belt catches.
2. Insert the belt catch perpendicularly through the front fabric and internal plastic board as shown in diagram 2.
3. Rotate the belt catch parallel to the backrest and pull the belt to secure in place as shown in diagram 3.

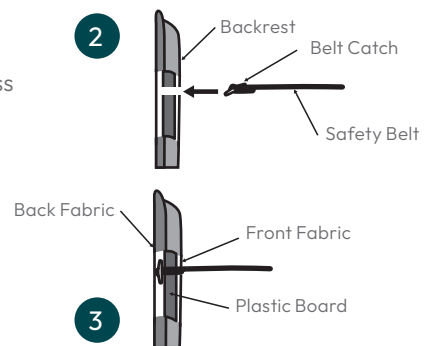

4. To remove the safety belt, rotate the belt catch perpendicularly to the backrest, and then pull the belt and catch out.

Use the Parking Brake

1. Step down gently on the parking brake pedal to lock. To test and ensure the brake is engaged, try to push the stroller forward.
2. Lift the parking brake pedal upwards with your foot to release it.



Adjust the Handlebar Height

1. Press the adjustable handle button on both sides simultaneously.
2. While the buttons are pressed, position the handle up or down to desired height.

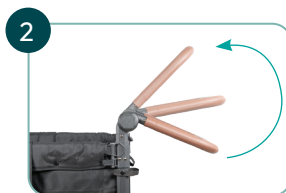

Fold the Stroller

1. Flip the side pockets into the stroller.
2. Stand in front of the stroller and press the buttons on either side of the frame.
3. Grasp the folding hinges on both sides. Lift up the hinges until stroller is completely folded.
4. Secure the lower latch to lock the stroller in the folded position.

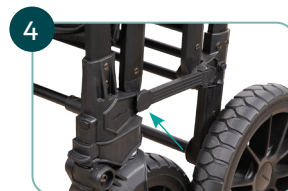

Adjust the Canopy

1. Before adjusting the height of canopy, make sure all four plastic clamps at the corners are open.
2. With one hand on each horizontal part of the canopy pole, gently slide the canopy poles up or down to the desired height. Be careful not to bend the poles.
3. Secure all four plastic clamps to lock canopy height.



Latch should be opened away from the center of the wagon



Latch should be pressed towards the center of the wagon to close

Note: Latches may require extra force to close or open.

Store the Canopy

1. Adjust the handlebar to the upright direction.
2. Roll up the canopy fabric around the horizontal part of the canopy poles.
3. Insert the combined ends of the canopy poles into the storage pocket on each side of the rear basket.
4. Secure the poles using the straps on the rear leg tubes and snap the fasteners.



Use the Drop Down Privacy/Wind Cover

1. Unzip the pocket located on the upper part of the inner carriage fabric.
2. Stretch out the inside curtain, and secure the bottom Velcro to the carriage fabric.
3. Repeat the same operations for the other side of the stroller.
4. To secure the curtain, pull up the Velcro, roll up the curtain and zip up the pocket.



Remove the Front and Rear Walls

1. Unbutton the carriage fabric and pull out the seat strap to reveal the upper frame bar. Then push the two tabs inward and lift the bar up to remove.
2. The front wall of the carriage fabric may be unzipped for complete removal.
3. The upper frame bar can also be placed on the slots towards the bottom of the frame as shown in figure 3.
4. The same process applies to the rear side of the wagon, however the rear carriage fabric wall cannot be completely removed.



Reverse the Seats for Versatile Seating

1. Turn the seat so that it is facing forward and attach the seat clips to the frame.
2. Make sure the smaller clips are aligned with the small pockets towards the center of the carriage fabric.
3. Slide the clip through the opening in the carriage fabric and into the slot on the frame.
4. Fold the Velcro flap over and secure it to the seat.
5. The seats may also be turned the other way to face the rear.



Maintenance

Cleaning the Stroller

1. Wash stroller frame with mild soap and warm water solution.
2. Rinse and wipe with a dry cloth until fully dry.

Cleaning the Seat Pad

1. Spot clean with mild soap and warm water solution.
2. Rinse and wipe with a dry cloth until fully dry.

Storing the Stroller Wagon

1. Should be stored in a cool and dry place.
2. Do not store near a heat source.
3. Do not expose or store in the sun and rain for a long time.

Warranty

One Year Limited Warranty

WonderFold warrants this product to be free from defects in material or workmanship for a period of one year from the date of purchase when used by the original owner according to the manufacturer's instructions.

The warranty does not apply to damage caused by product alteration, or customer/user misuse or abuse of the product. Your sales receipt is your only record of the date of purchase. Warranty is subject to change at any time at manufacturer's sole discretion. Please refer to wonderfold.com/pages/warranty for the most current version of the manufacturer warranty. Please contact WonderFold if you have any warranty questions or if you need replacement parts.

WONDERFOLD®

5796 Martin Rd
Irwindale, CA 91706
hello@wonderfold.com
1 (888) 681-1526