

## 1593KD DINING CHAIR

### ASSEMBLY INSTRUCTIONS

Please read these instructions carefully and keep for your future reference. Refer to parts inventory for guidance, and ensure you have all pieces before starting.

When assembling, place all parts on a soft, clean, and flat surface such as a carpet to prevent the item from scratches.

### PARTS AND HARDWARE

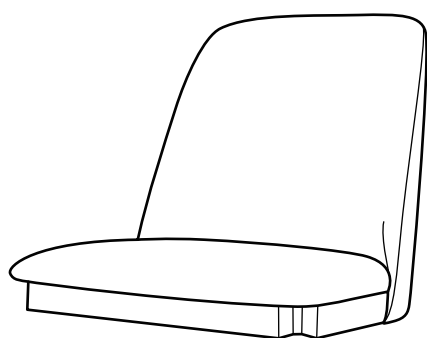

**1x**

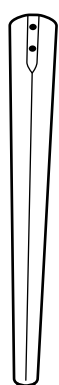

**2x**

(Front Leg)



**1x**

(Left Rear Leg)



**1x**

(Right Rear Leg)

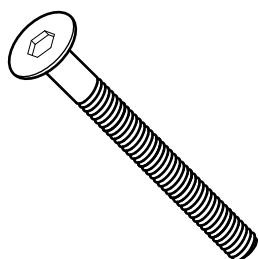

M6x75mm

**8x**

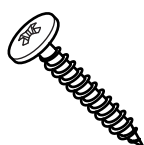

M4x38mm

**2x**



**8x**

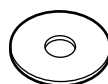

**8x**



**2x**



**1x**

1

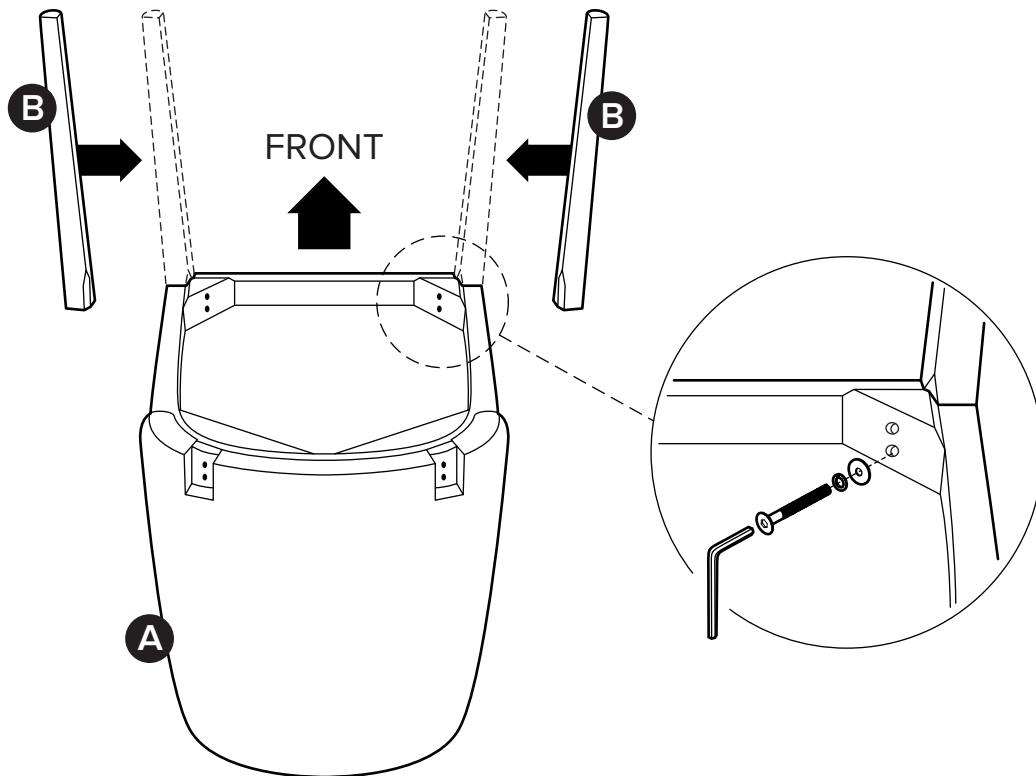

2

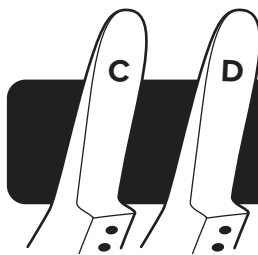

Left Rear Legs are marked with stamped (C), and Right Rear Legs are marked with stamped (D).

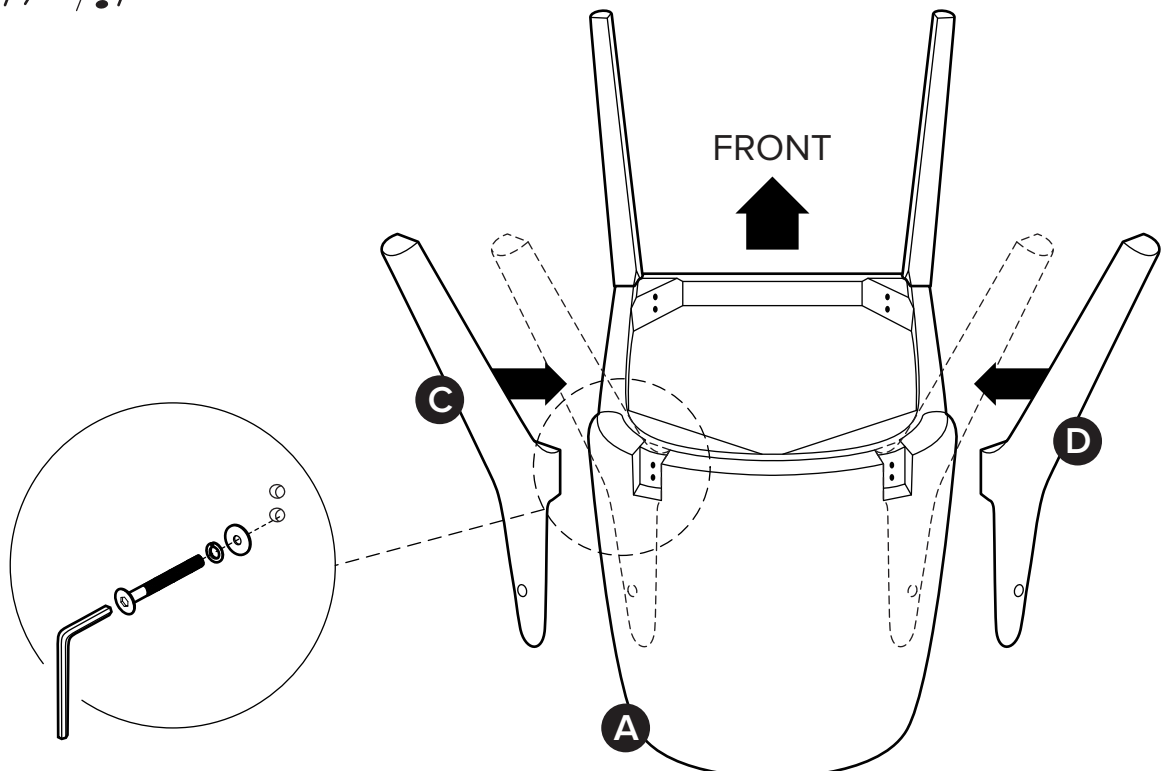

3

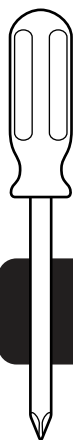

Use Phillips Head Screwdriver  
(Not Included)

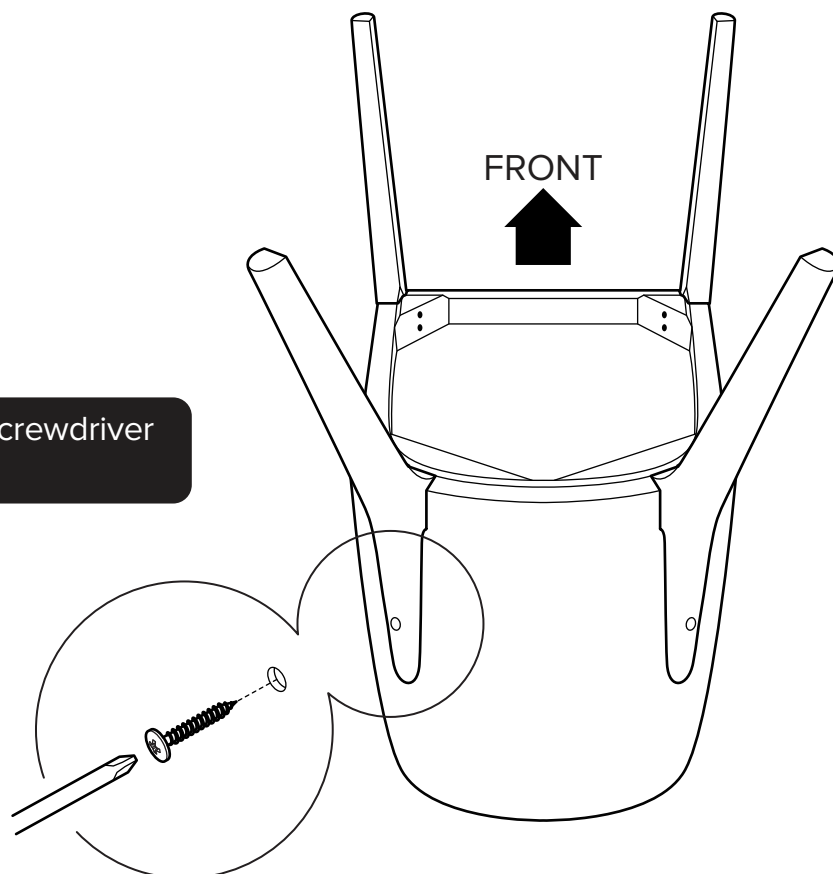

4

