

searchlight

6359/EU6359

EAC UK CA CE

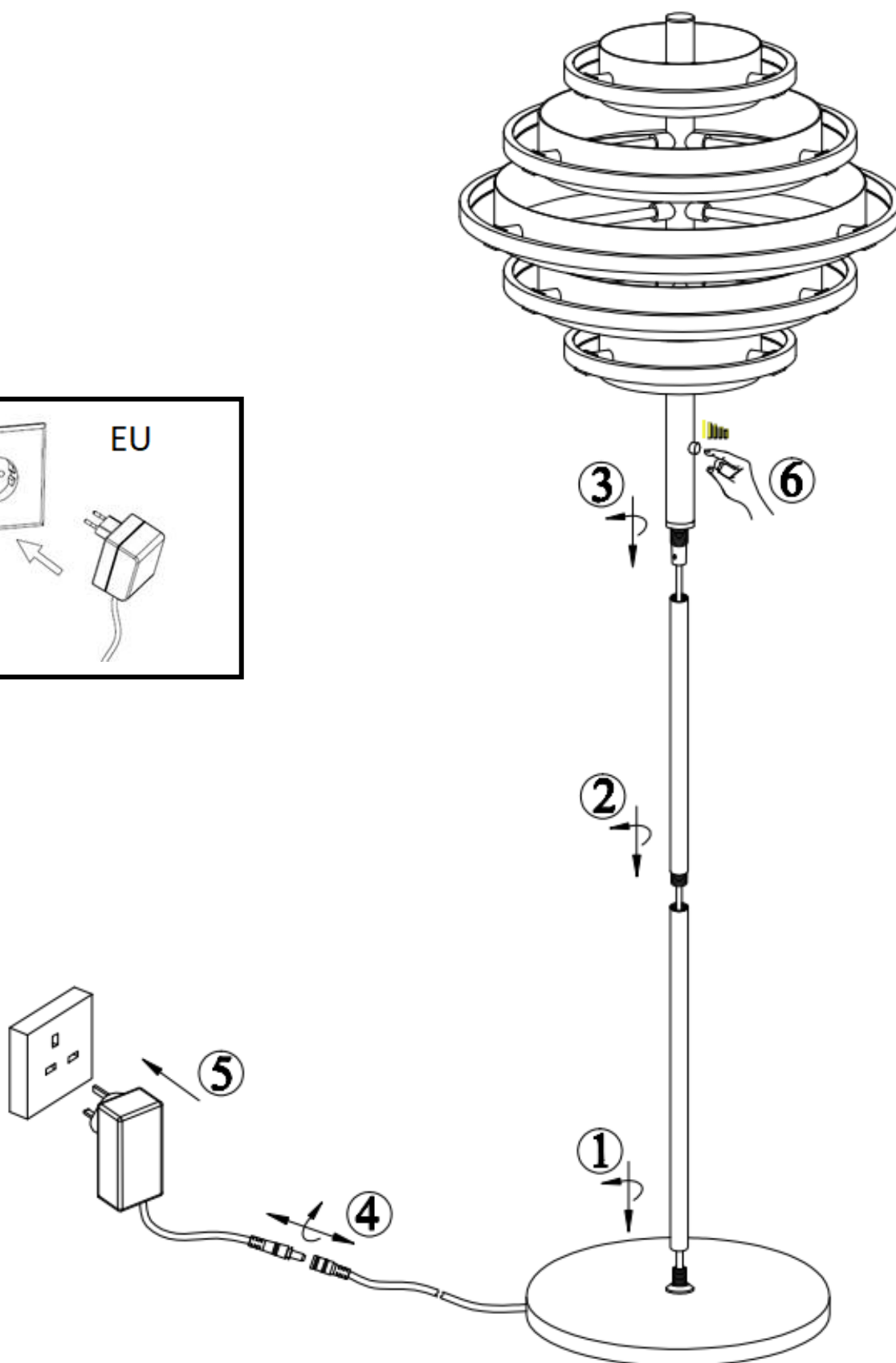
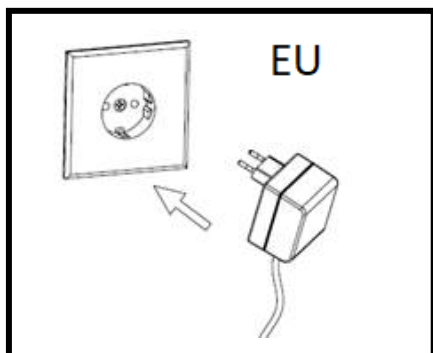

APPROVED
12/11/2021
ISSUE 4



DIMMABLE



SAFETY INFORMATION: (Please retain for future reference)

- Always turn off the mains supply before commencing the installation of this fitting .
- This is a Class 3 product and does not require an Earth connection
- Do not cover the light source or lamp shade.
- Do not modify or alter any product before or after installation. This will invalidate your warranty and may render the product un-safe.
- If replacing the fuse in the plug DO NOT EXCEED the maximum rated amps as specified on the plug.
- Take care not to twist the cable during assembly.

POSITION

- This fitting is suitable for installation in indoor locations only.
- Do not place the fitting in a damp atmosphere .
- Ensure sufficient access to the fitting to enable safe maintenance.

LAMP INFORMATION:

- This luminaire has a multi stage dimming function operated by holding down the on/off switch and releasing when the LED's have reached the required brightness.

AFTERCARE AND MAINTENANCE:

- Always disconnect power supply when servicing or cleaning.
- Clean only with a dry or slightly damp cloth.
- Do not use any abrasive cloths or cleaners as this may damage the product.
- The LED driver and chip board are removable for recycling only, please refer to diagram below. Once removed this fitting must be disposed of in the correct waste stream.

