

**Teva Wall****WB1860** | **1.0****FEISS®**

EST. 1955

**Wall**

This instruction shows a typical installation.

**CAUTION - RISK OF FIRE**

This product must be installed in accordance with the applicable installation code by a person familiar with the construction and operation of the product and the hazards involved.

Use minimum 90°C supply conductors.

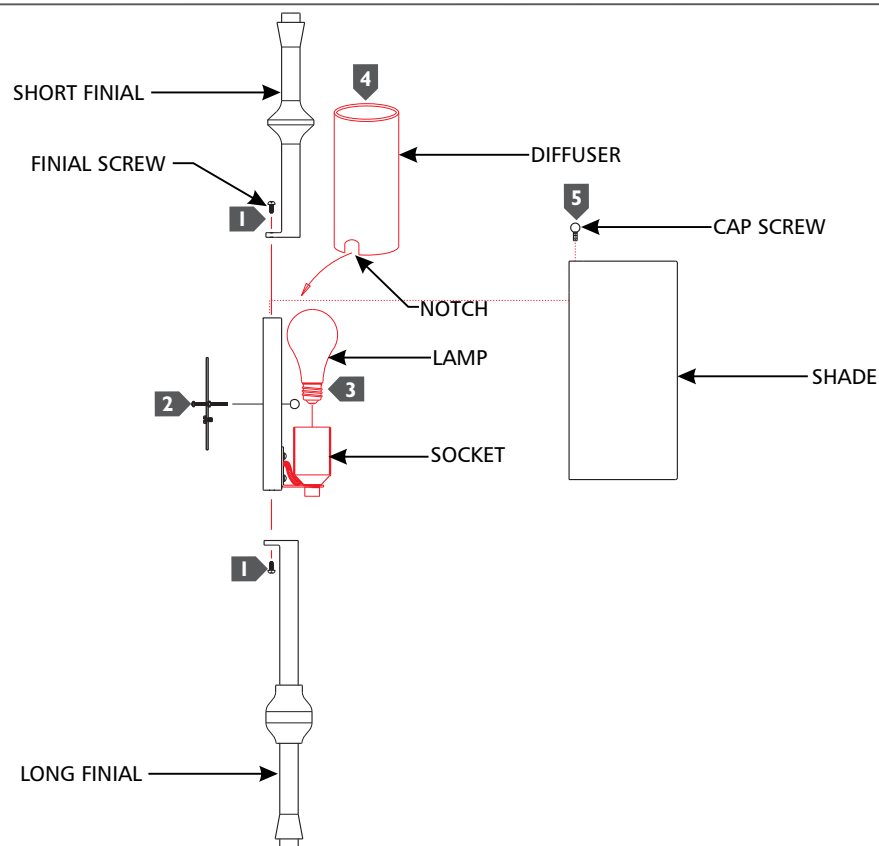
**IA**

- 1** Install the short finial to the top of the fixture and long finial to the bottom of the fixture using the finial screws.
- 2** Follow enclosed supplement installation instructions for electrical and fixture installation.
- 3** Screw the lamp into the socket. Refer to the label on the socket for Max Wattage Information.
- 4** Install the diffuser over the socket with notch in the orientation shown.
- 5** Install the shade to the top of the fixture and secure it in place using the cap screws.